



Taiwan Excellent Auto Engine Parts  
Warranty for

2 Year / 20,000 km

# KUBOTA YANMAR

## Diesel Engine Parts

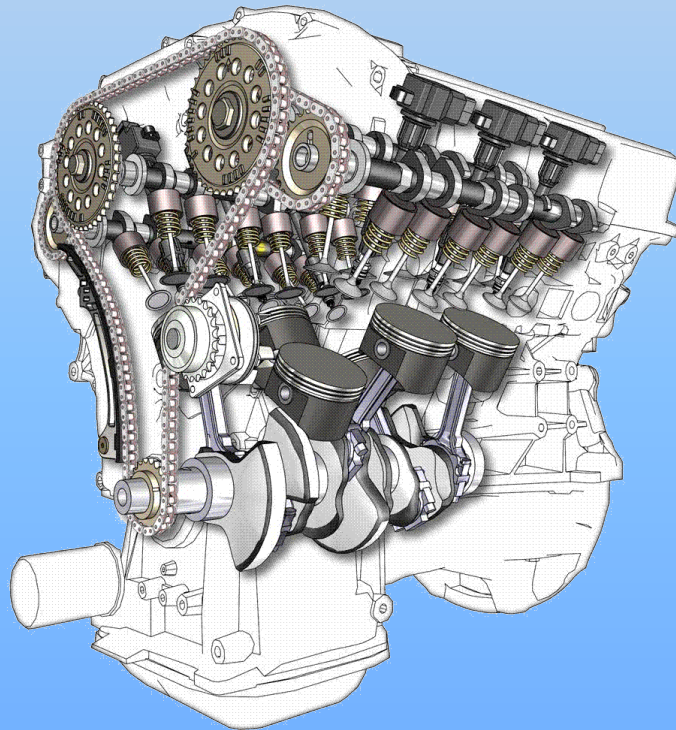

Contact Person: Mr. Jacky Tsai  
Email 1: [eton.jacky@msa.hinet.net](mailto:eton.jacky@msa.hinet.net)  
Email 2: [valveparts2866@gmail.com](mailto:valveparts2866@gmail.com)  
Tel : (8864) 2293-6969  
Fax : (8864) 2293-7070  
No. 90, Wenchang 1<sup>st</sup> St., North District,  
Taichung City, Taiwan. 40464

**E & T SCIENCE INC.**

**ISO/TS 16949  
QS9000**



# PISTON TERMINOLOGY

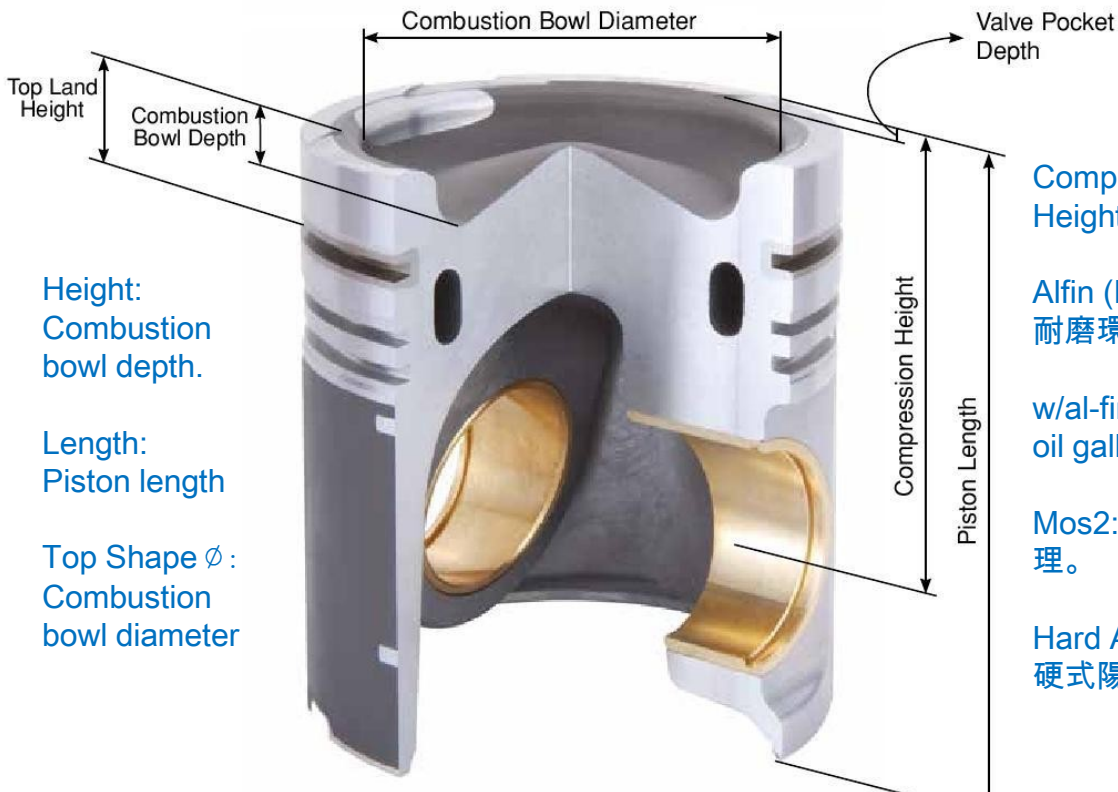
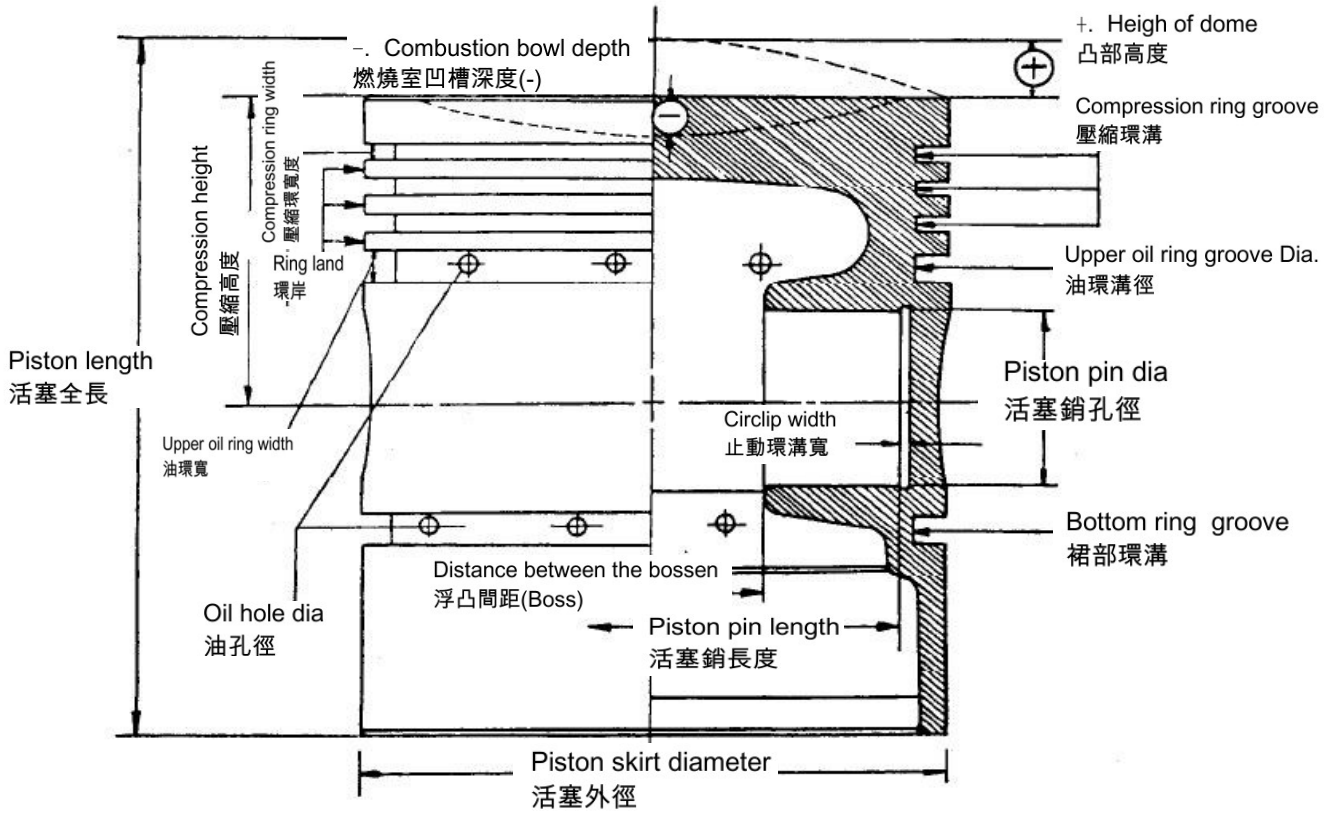

Height:  
Combustion bowl depth.

Length:  
Piston length

Top Shape  $\phi$  :  
Combustion bowl diameter

Comp: Compression Height 壓縮高度

Alfin (Ring Carrier) 耐磨環

w/al-fin: Alfin and with oil gallery.

Mos2: 裙部二硫化鉬處理。

Hard Anodizing: 硬式陽極處理。



# PISTON RING TERMINOLOGY

## Free Ring(Unstressed)

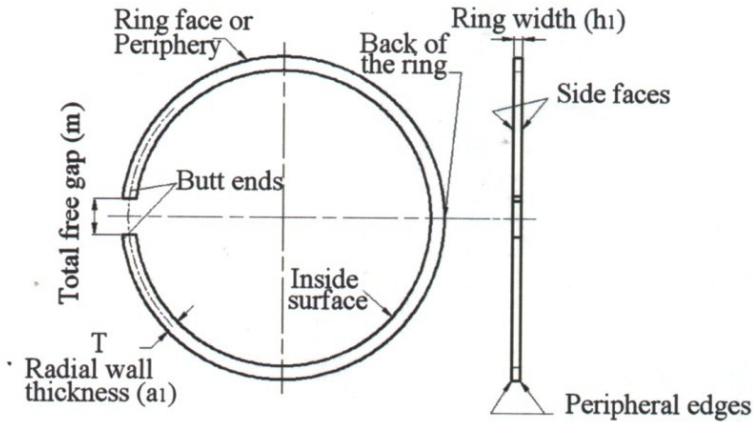

## Closed Ring

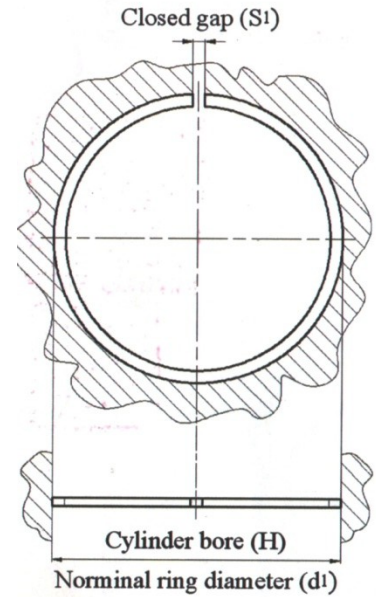

## Compression Ring

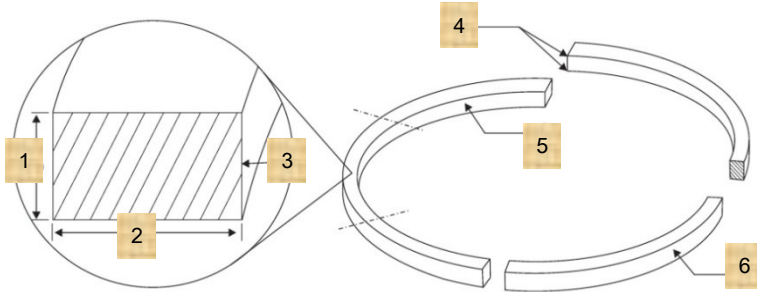

- 1. Piston ring width
- 2. Piston ring thickness
- 3. Inside edge of gap
- 4. Inside edges
- 5. Inside surface
- 6. Peripheral surface

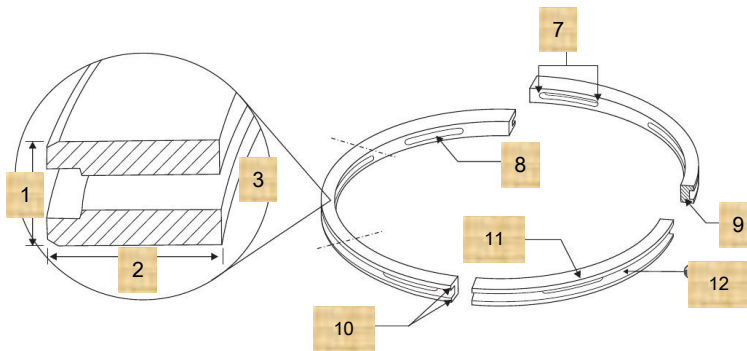

- 7. Inside edges of slot
- 8. Slot face
- 9. Gap face
- 10. Outside gap corners
- 11. Side face
- 12. Outside groove face

## Oil Control Ring



# LINER/SLEEVE TERMINOLOGY

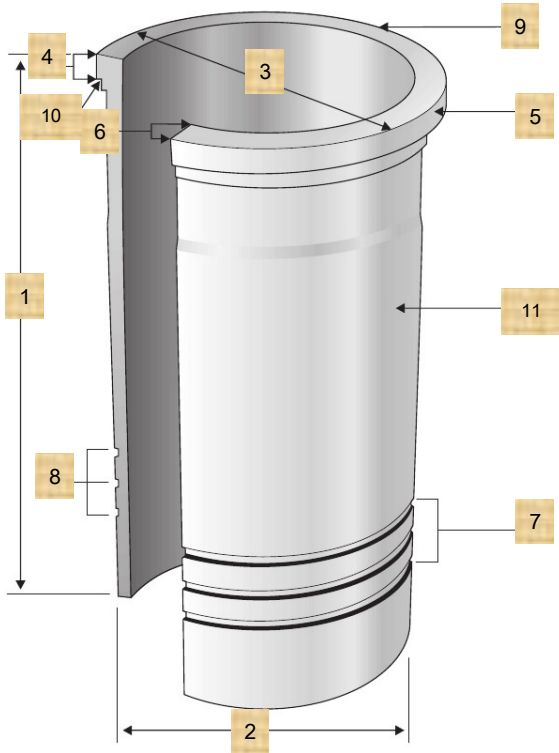

- 1. Total length
- 2. Outside diameter
- 3. Flange diameter  
(Register diameter)
- 4. Flange depth  
(Collar height)
- 5. Flange
- 6. Top land width
- 7. Sealing area
- 8. O-Ring groove
- 9. Firewall
- 10. Machining relief
- 11. Barel



Wet Cylinder Liner

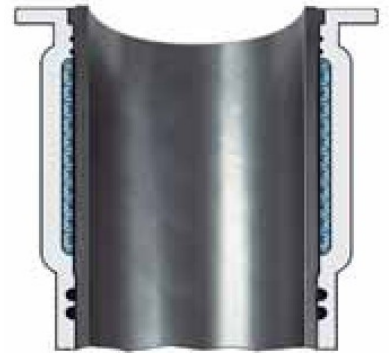

Dry Cylinder Liner

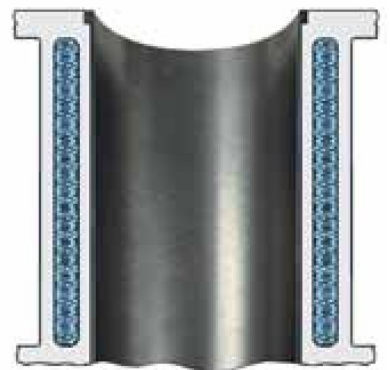



# BEARINGS TERMINOLOGY



Rocker arm bushes



Con rod bushes



Connecting rod bearing



Main bearing



Flanged bearing



Thrust washers



Camshaft bearing

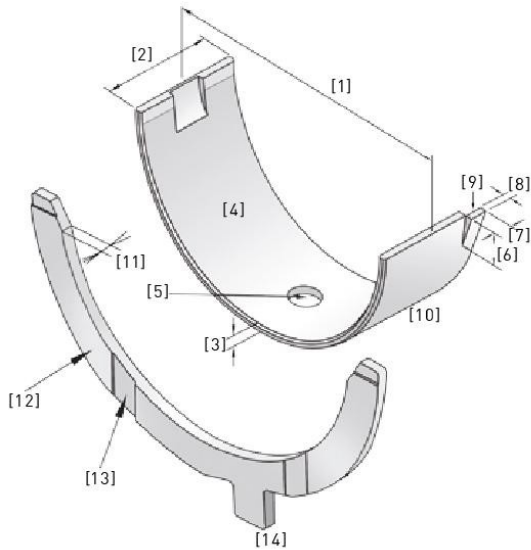

## Bearing Shell

1. Free spread
2. Bearing length
3. Bearing wall thickness
4. Bearing surface
5. Lubrication hole
6. Length of locating lug
7. Width of locating lug
8. Height of locating lug
9. Locating lug relief
10. Bearing back

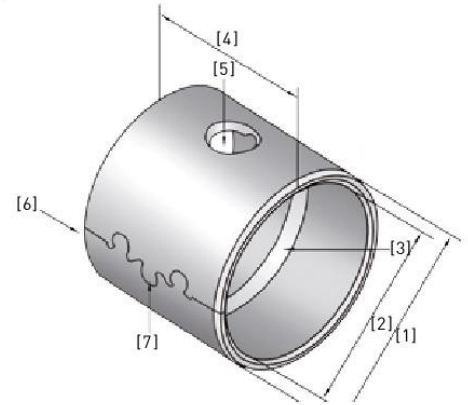

## Bushing

1. Outside diameter
2. Inside diameter
3. Oil groove
4. Bushing length
5. Lubrication hole
6. Joint
7. Clinch

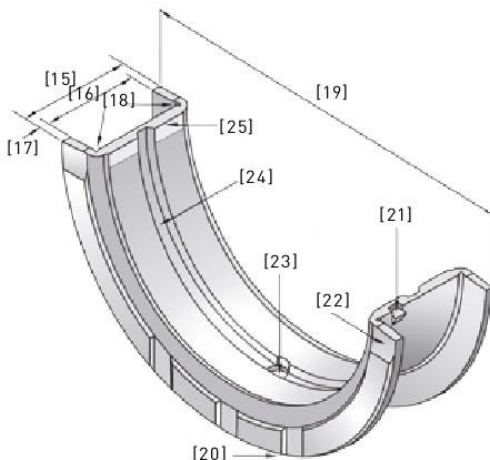

## Flange Bearing

15. Flange bearing length
16. Distance between flange
17. Flange thickness
18. Flange relief grooves
19. Flange diameter
20. Relief at joint face
21. Locating lug
22. Relief at joint face
23. Lubrication hole
24. Oil groove
25. Relief at surface
26. Flange and Bearing assembly

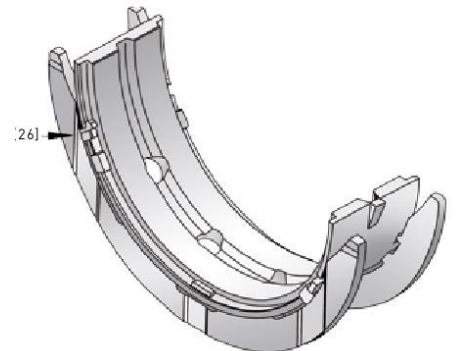



# ENGINE VALVE SPECIFICATION

## ENGINE VALVE DIMENSION

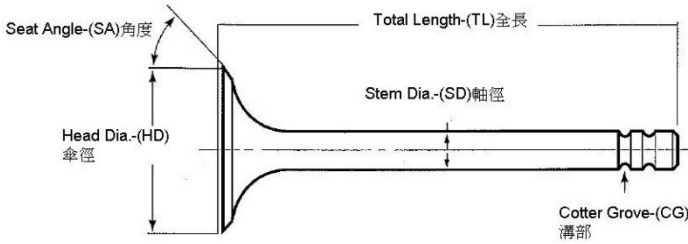

Stem Top Hardness:  
**HRC 45~60**

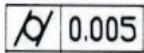

Roundness Tolerance  
**≤0.005mm**

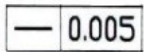

Straightness Tolerance  
**≤0.005mm**

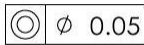

Concentricity Tolerance  
**≤0.05mm**

## SPECIFICATION



## SHAPE OF COTTER GROOVE (CG)

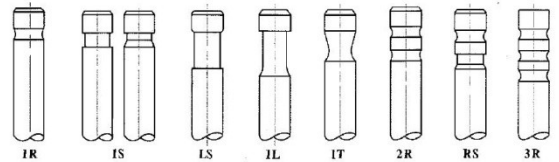

## 引擎汽門(Engine Valve)使用鋼材對照

材料代號對照					材料化學成分								適用於
Martensitic Steel 麻田散鐵													IN/EX
ISO	JIS	SAE	DIN/BS	大陸	C	Si	Mn	P	S	Ni	Cr	Mo	
42CrMo4	SCM440	4140	EN49		0.43	0.35	0.85				1.2	0.3	
X45CrSi93	SUH1	HNV3	X45CrSi9 3	45Cr9Si3	0.4-0.5	3.0-3.5	≤0.60	≤0.03	≤0.03	≤0.5	7.5-9.0		
	SUH3		X40CrSiMo10-2	40Cr10Si2Mo	0.30-0.45	1.8-2.5	≤0.60	≤0.03	≤0.03	≤0.6	10.0-12.0	0.7-1.3	
	SUH4(XB)	ENV6	EN59	80Cr20Si2Ni	0.75-0.85	1.75-2.25	0.2-0.6	≤0.03	≤0.03	1.15-1.65	19.0-20.5		
X50CrSi82	SUH11	HNV3	EN52	51Cr8Si2	0.45-0.55	1.0-2.0	≤0.60	≤0.03	≤0.03		7.5-9.5		
Austenitic Steel 奧斯田鐵 Non-magnetic													EX
	SUH31	EV9		45Cr14Ni14W2Mo	0.3-0.45	1.5-2.5	≤0.60	≤0.04	≤0.03	13.0-15.0	14.0-16.0		
X53CrMnNiN214	SUH35(21-4N)	EV8	349S54	53Cr21Mn9Ni4N	0.58	≤0.35	8.0-10.0	≤0.01	≤0.03	3.25-4.5	20.0-22.0		
	SUH37(21-12N)	EV4	381S34	20Cr21Ni12N	0.15-0.25	0.75-1.0	1.0-1.5	≤0.025	≤0.025	10.5-12.5	20.0-22.0		
	SUH38				0.25-0.35	≤1.0	≤1.2	0.18-0.25	≤0.03	10.0-12.0	19.0-21.0	1.8-2.5	
Nickel Basic alloy 鎳基合金													EX
NiCr20TiAl	NiMonic 80A	2.4952(HEV5)		GH4080A	0.10max	1.0	1.0		Fe 3.0 max	65.0min	18.0-21.0	Al 1.0-1.5	
NiCr15Fe7TiAl	751	2.4669(HEV3)	NiCr15FeTiAl	GH4751									

STELLITE 鈷鉻鎢合金鋼(軸端與盤面焊補材質)						
	C	Cr	W	Fe	Co	HRC
Stellite #1	2.5	30.0	12.0	3.0 Max	Balance	54
Stellite #6	1.0	28.0	4.0	3.0 Max	Balance	44
Stellite #12	1.35	29.0	8.0	2.0	Balance	47



# VALVE SEAT & GUIDE SPECIFICATION

Valve Seat:  
High Chrome Alloy Steel  
Hardness :HRC 36~47

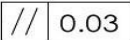
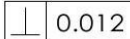
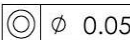
-  0.03 Parallelism Tolerance  $\leq 0.03\text{mm}$
-  0.012 Verticality Tolerance  $\leq 0.012\text{mm}$
-   $\phi$  0.05 Concentricity Tolerance  $\leq 0.05\text{mm}$

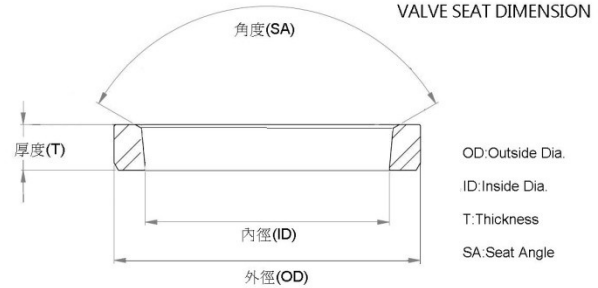

## Valve Seat Material

汽門座圈材料成份表

材質:高鉻合金High Chrome Alloy Steel(耐熱合金鑄造鋼)



	C	Si	Mn	P	S	Cr	Mo	Ni	V	Hardness 硬度HRC
高鉻合金 High Chrome Alloy Steel	1.5~2.0	1.5~2.0	0.6~1.2	$\leq 0.10$	$\leq 0.10$	13.5~15	0.35~0.5			36~47

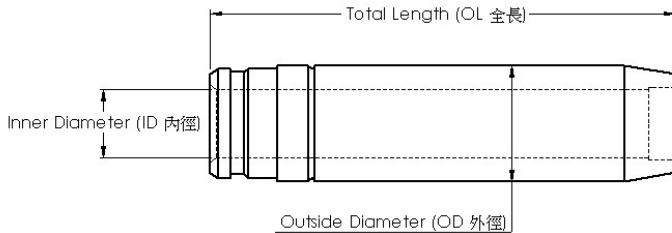

(mm)	Inlet valve ( $\mu\text{m}$ )	Exhaust valve ( $\mu\text{m}$ )
Stem dia. 6 - 7	10 - 40	25 - 55
Stem dia. 8 - 9	20 - 50	35 - 65
Stem dia. 10 - 12	40 - 70	55 - 85

## Valve Guide: Cast Iron FC25

Hardness :HRB 92~102°

- Surface finish Ra  $\leq 0.8\mu\text{m}$
- Inner diameter tolerance  $\leq 0.01\text{mm}$
- Outer diameter tolerance  $\leq 0.01\text{mm}$
- Concentricity diameter tolerance  $\leq 0.05\text{mm}$

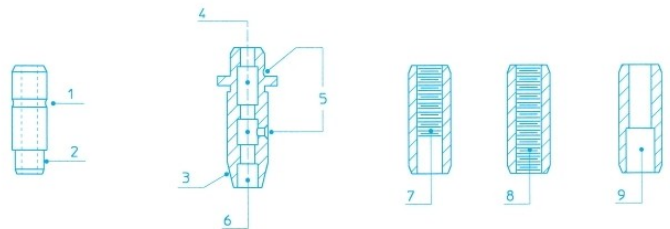

- 1.Outer groove for snap ring
- 2.Narrower end
- 3.Conical end
- 4.Recessd area in the bore
- 5.Lubrifation holes
- 6.Counterbore at end of guides
- 7/8.Lubrifation threads
- 9.Counter bore

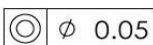
  $\phi$  0.05

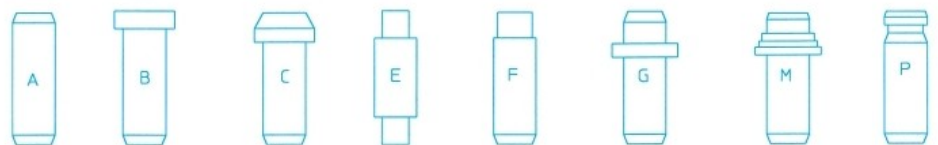



## KUBOTA DIESEL ENGINE PARTS

TYPE	NO	TYPE	NO
D662	1	V4300	46
D722	2	V4702	47
D850	3	Z482	48
D905	4		
D1005	5		
D1102	6		
D1105	7		
D1302	8		
D1402	9		
D1403	10		
D1462	11		
D1503	12		
D1703	13		
F2302	14		
F2503	15		
F2803	16		
F5803	17		
V1200	18		
V1250	19		
V1305	20		
V1405	21		
V1502	22		
V1505	23		
V1512	24~25		
V1702	26		
V1902	27		
V1903	28		
V2003	29		
V2203	30~33		
V2403	34~35		
V2607	36		
V3300	37~41		
V3600	42		
V3800	43~44		
V4000	45		



# KUBOTA D662-B

**Application :**  
**Number of Cylinders 3**  
**Cylinder dia. 64.0 MM**  
**Swept Volume 656 ccm**

## Piston kit-Set

OEM NO.

Piston

SIZE

Comp : 33.0 Height : Length :  
 Top Shape :  
 Pin :  
 Length :

STD

## Piston Ring

OEM NO.

NPR :

OEM Ring Groove

SIZE

Top :  
 2nd :  
 Oil :

STD



## Cylinder Liner

OEM NO.

Liner&Sleeve

SIZE

In Diameter :  
 Out Diameter :  
 Total length :  
 Flange :

STD



## Engine Bearing

MAIN :  
 CON.ROD :  
 T/W :  
 C/B :  
 BUSH :

SIZE

STD



## Engine Valve

OEM NO.  
 IN  
 OEM NO.  
 EX

SIZE

STD

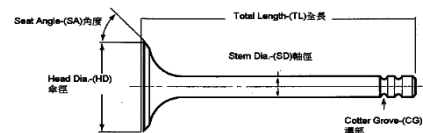

## Valve Seat

OEM NO.  
 IN  
 OEM NO.  
 EX

SIZE

STD

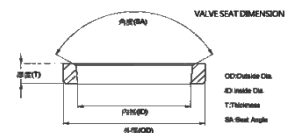

## Valve Guide

OEM NO.  
 IN  
 OEM NO.  
 EX

SIZE

STD

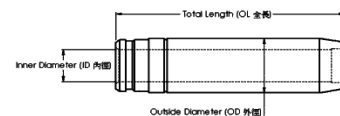

## Gasket Set

OEM NO.





# KUBOTA

## D850-B

**Application :**  
**Number of Cylinders 3**  
**Cylinder dia. 73.0 MM**  
**Swept Volume ccm**

### Piston kit-Set

OEM NO.

Piston

SIZE

Comp : 35.5 Height : Length : 65.5  
 Top Shape :  
 Pin : 20.0  
 Length : 54.0

STD



### Piston Ring

OEM NO.

NPR :

OEM Ring Groove

SIZE

Top :  
 2nd :  
 Oil :

STD



### Cylinder Liner

OEM NO.

Liner&Sleeve

SIZE

In Diameter :  
 Out Diameter :  
 Total length :  
 Flange :

STD



### Engine Bearing

MAIN :  
 CON.ROD :  
 T/W :  
 C/B :  
 BUSH :

SIZE

STD



### Engine Valve

OEM NO. 15393-13110/15901-13112  
 IN 31.0 7.0 89.6  
 OEM NO. 15393-13120/15901-12122  
 EX 27.5 7.0 89.8

SIZE

STD

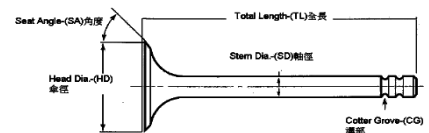

### Valve Seat

OEM NO.  
 IN  
 OEM NO.  
 EX

SIZE

STD

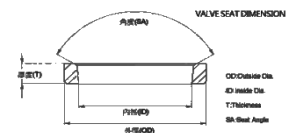

### Valve Guide

OEM NO. 15261-13540  
 IN 40.0 7.0 11.0  
 OEM NO. 15261-13560  
 EX 40.0 7.0 11.0

SIZE

STD

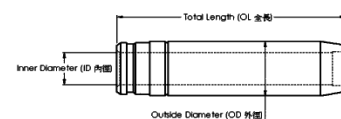

### Gasket Set

OEM NO.



# KUBOTA

## D905-B

**Application :**  
**Number of Cylinders 3**  
**Cylinder dia. 72.0 MM**  
**Swept Volume 898 ccm**

### Piston kit-Set

OEM NO.

Piston

SIZE

Comp : 39.5 Height : -0.6 Length : 67.0  
 Top Shape : Flower  
 Pin : 22.0  
 Length : 60.0

STD



### Piston Ring

OEM NO.

NPR :

OEM Ring Groove

SIZE

Top :  
 2nd :  
 Oil :

STD



### Cylinder Liner

OEM NO.

Liner&Sleeve

SIZE

In Diameter :  
 Out Diameter :  
 Total length :  
 Flange :

STD



### Engine Bearing

MAIN : 16241-2345  
 CON.ROD : 16241-2231-1  
 T/W :  
 C/B :  
 BUSH :

SIZE

STD



### Engine Valve

OEM NO. 15393-13110/15901-13112  
 IN 31.0 7.0 89.6  
 OEM NO. 15393-13120/15901-12122  
 EX 27.5 7.0 89.8

SIZE

STD

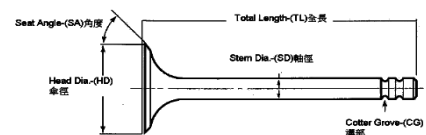

### Valve Seat

OEM NO.  
 IN  
 OEM NO.  
 EX

SIZE

STD

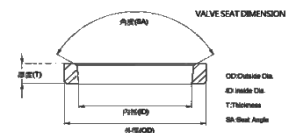

### Valve Guide

OEM NO. 15261-13540  
 IN 40.0 7.0 11.0  
 OEM NO. 15261-13560  
 EX 40.0 7.0 11.0

SIZE

STD

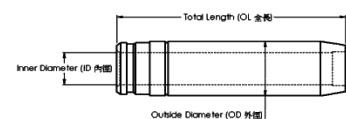

### Gasket Set

OEM NO.



# KUBOTA

## D1005-B

**Application :**  
**Number of Cylinders 3**  
**Cylinder dia. 76.0 MM**  
**Swept Volume 1001 ccm**

### Piston kit-Set

OEM NO.

Piston

SIZE

Comp : 39.5 Height : -0.7 Length : 68.5  
 Top Shape : Flower  
 Pin : 22.0  
 Length : 60.0

STD



### Piston Ring

OEM NO.

NPR :

OEM Ring Groove

SIZE

Top :  
 2nd :  
 Oil :

STD



### Cylinder Liner

OEM NO.

Liner&Sleeve

SIZE

In Diameter :  
 Out Diameter :  
 Total length :  
 Flange :

STD



### Engine Bearing

MAIN : 16241-2345  
 CON.ROD : 16241-2231-1  
 T/W :  
 C/B :  
 BUSH :

SIZE

STD



### Engine Valve

OEM NO. 15221-13110  
 IN 33.0 8.0 101.0  
 OEM NO. 15221-13120  
 EX 27.0 8.0 101.0

SIZE

STD

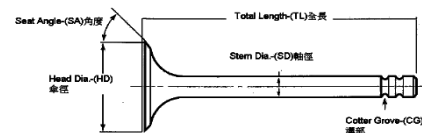

### Valve Seat

OEM NO.  
 IN  
 OEM NO.  
 EX

SIZE

STD

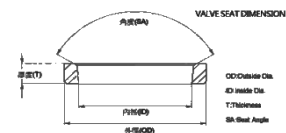

### Valve Guide

OEM NO. VGKU-02-Z  
 IN/EX 48.7 8.0 13.0 M-6

SIZE

STD

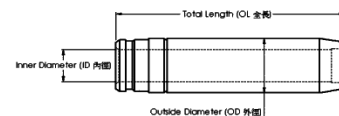

### Gasket Set

OEM NO.



# KUBOTA

## D1102-B

**Application :**  
**Number of Cylinders 3**  
**Cylinder dia. 76.0 MM**  
**Swept Volume 1115 ccm**

### Piston kit-Set

OEM NO.

Piston

SIZE

Comp : 49.3 Height : Length : 80.0

Top Shape :

Pin : 23.0

Length : 64.0

STD



### Piston Ring

OEM NO.

NPR :

OEM Ring Groove

SIZE

Top : 2.5K

2nd : 2.0

Oil : 5.0

STD



### Cylinder Liner

OEM NO.

Liner&Sleeve

SIZE

In Diameter :

Out Diameter :

Total length :

Flange :

STD



### Engine Bearing

MAIN : ML2201

CON.ROD : R2201

T/W : L2201

C/B :

BUSH :

SIZE

STD



### Engine Valve

OEM NO. 15221-13110

IN 33.0 8.0 101.0

OEM NO. 15221-13120

EX 27.0 8.0 101.0

SIZE

STD

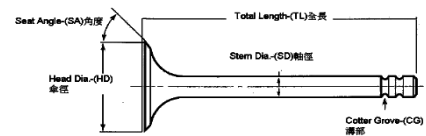

### Valve Seat

OEM NO.

IN

OEM NO.

EX

SIZE

STD

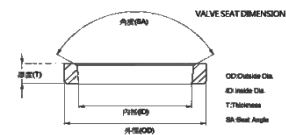

### Valve Guide

OEM NO. VGKU-02-Z

IN/EX 48.7 8.0 13.0 M-6

SIZE

STD

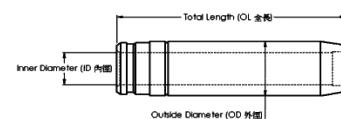

### Gasket Set

OEM NO.



# KUBOTA D1105-B

**Application :**  
**Number of Cylinders 3**  
**Cylinder dia. 78.0 MM**  
**Swept Volume 1123 ccm**

## Piston kit-Set

OEM NO.

Piston

SIZE

Comp : 36.5 Height : -0.6 Length : 69.0  
 Top Shape : Flower  
 Pin : 22.0  
 Length : 60.0

STD



## Piston Ring

OEM NO.

NPR :

OEM Ring Groove

SIZE

Top : 2.0K  
 2nd : 1.5  
 Oil : 4.0

STD



## Cylinder Liner

OEM NO.

Liner&Sleeve

SIZE

In Diameter :  
 Out Diameter :  
 Total length :  
 Flange :

STD



## Engine Bearing

MAIN : 16241-2345  
 CON.ROD : 16241-2231-1  
 T/W :  
 C/B :  
 BUSH :

SIZE

STD



## Engine Valve

OEM NO. 15393-13110/15901-13112  
 IN 31.0 7.0 89.6  
 OEM NO. 15393-13120/15901-12122  
 EX 27.5 7.0 89.8

SIZE

STD

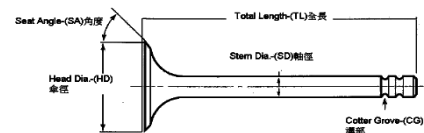

## Valve Seat

OEM NO.  
 IN  
 OEM NO.  
 EX

SIZE

STD

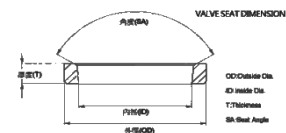

## Valve Guide

OEM NO. 15261-13540  
 IN 40.0 7.0 11.0  
 OEM NO. 15261-13560  
 EX 40.0 7.0 11.0

SIZE

STD

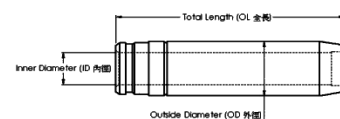

## Gasket Set

OEM NO.



# KUBOTA D1302-B

**Application :**  
**Number of Cylinders 3**  
**Cylinder dia. 82.0 MM**  
**Swept Volume ccm**

## Piston kit-Set

OEM NO.

Piston

SIZE

Comp : 43.9 Height : Length : 80.0

Top Shape :

Pin : 23.0

Length : 64.0

STD



## Piston Ring

OEM NO.

NPR :

OEM Ring Groove

SIZE

Top : 2.5HK

2nd : 2.0

Oil : 5.0

STD



## Cylinder Liner

OEM NO.

Liner&Sleeve

SIZE

In Diameter :

Out Diameter :

Total length :

Flange :

STD



## Engine Bearing

MAIN : ML2201

CON.ROD : R2201

T/W : L2201

C/B :

BUSH :

SIZE

STD



## Engine Valve

OEM NO. 15221-13110

IN 33.0 8.0 101.0

OEM NO. 15221-13120

EX 27.0 8.0 101.0

SIZE

STD

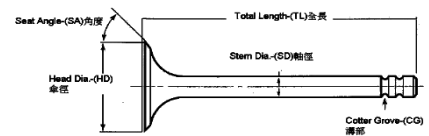

## Valve Seat

OEM NO.

IN

OEM NO.

EX

SIZE

STD

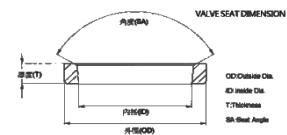

## Valve Guide

OEM NO. VGKU-02-Z

IN/EX 48.7 8.0 13.0 M-6

SIZE

STD

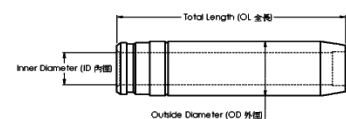

## Gasket Set

OEM NO.





# KUBOTA

## D1402B

**Application :**  
**Number of Cylinders 3**  
**Cylinder dia. 85.0 MM**  
**Swept Volume 1395 ccm**

### Piston kit-Set

OEM NO.

Piston

SIZE

Comp : 43.9 Height : Length : 80.0

Top Shape :

Pin : 23.0

Length : 64.0

STD

### Piston Ring

OEM NO.

NPR :

OEM Ring Groove

SIZE

Top : 2.5K

2nd : 2.0

Oil : 5.0

STD



### Cylinder Liner

OEM NO.

Liner&Sleeve

SIZE

In Diameter :

Out Diameter :

Total length :

Flange :

STD



### Engine Bearing

MAIN : ML2201

CON.ROD : R2201

T/W : L2201

C/B :

BUSH :

SIZE

STD



### Engine Valve

OEM NO. 15221-13110

IN 33.0 8.0 101.0

OEM NO. 15221-13120

EX 27.0 8.0 101.0

SIZE

STD

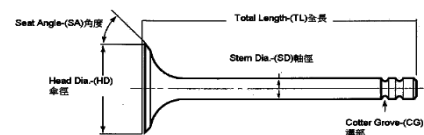

### Valve Seat

OEM NO.

IN

OEM NO.

EX

SIZE

STD

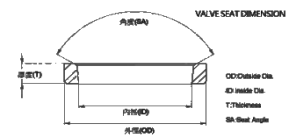

### Valve Guide

OEM NO. VGKU-02-Z

IN/EX 48.7 8.0 13.0 M-6

SIZE

STD

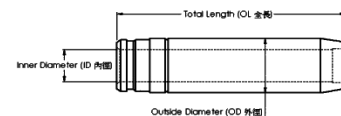

### Gasket Set

OEM NO.



# KUBOTA D1403-B

**Application :**  
**Number of Cylinders 3**  
**Cylinder dia. 80.0 MM**  
**Swept Volume 1393 ccm**

## Piston kit-Set

OEM NO. 16427-21113

Piston	SIZE
Comp : 43.5 Height : -1.7 Length : 80.0 Top Shape : Flower Pin : 25.0 Length :	STD



## Piston Ring

OEM NO. 16427-21050

NPR :

OEM Ring Groove	SIZE
Top : 2.5HK 2nd : 2.0 Oil : 5.0	STD



## Cylinder Liner

OEM NO.

Liner&Sleeve	SIZE
In Diameter : Out Diameter : Total length : Flange :	STD



## Engine Bearing

	SIZE
MAIN : CON.ROD : T/W : C/B : BUSH :	STD



## Engine Valve

	SIZE
OEM NO. 16484-13110 IN 33.5 8.0 102.2 OEM NO. 16484-13120 EX 28.5 8.0 102.2	STD

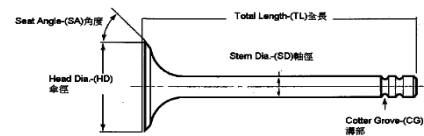

## Valve Seat

	SIZE
OEM NO. IN OEM NO. EX	STD

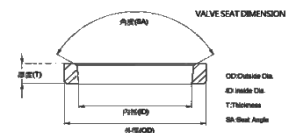

## Valve Guide

	SIZE
OEM NO. 13721-13580 IN 40.0 8.0 13.0 OEM NO. 13721-13560/90 EX 47.0 8.0 13.0	STD

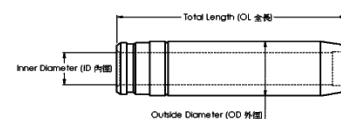

## Gasket Set

OEM NO.



# KUBOTA

## D1462-DI

**Application :**  
**Number of Cylinders 3**  
**Cylinder dia. 87.0 MM**  
**Swept Volume 1460 ccm**

### Piston kit-Set

OEM NO.

Piston

SIZE

Comp : 44.5 Height : -14.5 Length : 80.0  
 Top Shape : Ø47.0  
 Direct Injection  
 Pin : 25.0 Length : 64.0

STD

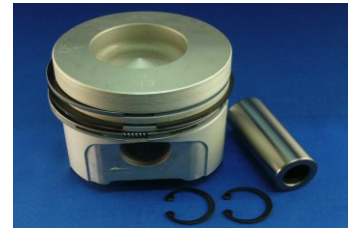

### Piston Ring

OEM NO.

NPR :

OEM Ring Groove

SIZE

Top : 2.5K  
 2nd : 2.0  
 Oil : 5.0

STD



### Cylinder Liner

OEM NO.

Liner&Sleeve

SIZE

In Diameter :  
 Out Diameter :  
 Total length :  
 Flange :

STD



### Engine Bearing

MAIN : ML2201

CON.ROD : 17311-2231-0

T/W : L2201

C/B :

BUSH :

SIZE

STD



### Engine Valve

OEM NO. 17111-13110

IN 37.5 8.0 101.5

OEM NO. 17111-13120

EX 32.0 8.0 101.5

SIZE

STD

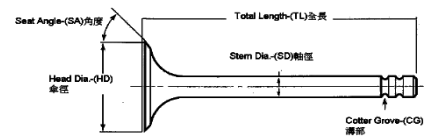

### Valve Seat

OEM NO.

IN

OEM NO.

EX

SIZE

STD

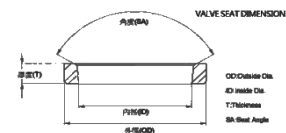

### Valve Guide

OEM NO.

IN

OEM NO.

EX

SIZE

STD

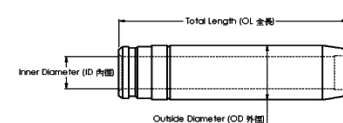

### Gasket Set

OEM NO.



# KUBOTA D1503-B

**Application :**  
**Number of Cylinders 3**  
**Cylinder dia. 83.0 MM**  
**Swept Volume 1499 ccm**

## Piston kit-Set

OEM NO.

Piston

SIZE

Comp : 44.9 Height : -1.2 Length : 80.0  
 Top Shape : Flower  
 Pin :  
 Length :

STD



## Piston Ring

OEM NO.

NPR :

OEM Ring Groove

SIZE

Top : 2.5  
 2nd : 2.0  
 Oil : 4.5

STD



## Cylinder Liner

OEM NO.

Liner&Sleeve

SIZE

In Diameter :  
 Out Diameter :  
 Total length :  
 Flange :

STD



## Engine Bearing

MAIN :  
 CON.ROD :  
 T/W :  
 C/B :  
 BUSH :

SIZE

STD



## Engine Valve

OEM NO. 16484-13110  
 IN 33.5 8.0 102.2  
 OEM NO. 16484-13120  
 EX 28.5 8.0 102.2

SIZE

STD

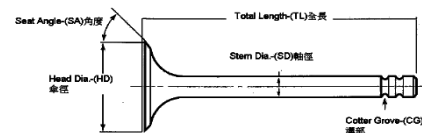

## Valve Seat

OEM NO.  
 IN  
 OEM NO.  
 EX

SIZE

STD

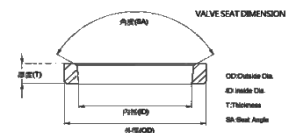

## Valve Guide

OEM NO. 13721-13580  
 IN 40.0 8.0 13.0  
 OEM NO. 13721-13560/90  
 EX 47.0 8.0 13.0

SIZE

STD

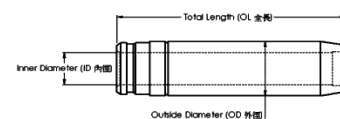

## Gasket Set

OEM NO.



# KUBOTA D1703-B

**Application :**  
**Number of Cylinders 3**  
**Cylinder dia. 87.0 MM**  
**Swept Volume 1647 ccm**

## Piston kit-Set

OEM NO.

Piston

SIZE

Comp : 44.5 Height : -1.5 Length : 80.0  
 Top Shape : Flower  
 Pin : 25.0  
 Length : 64.0

STD



## Piston Ring

OEM NO.

NPR :

OEM Ring Groove

SIZE

Top : 2.5K  
 2nd : 2.0  
 Oil : 5.0

STD



## Cylinder Liner

OEM NO.

Liner&Sleeve

SIZE

In Diameter :  
 Out Diameter :  
 Total length :  
 Flange :

STD



## Engine Bearing

MAIN : ML2201

CON.ROD : 17311-2231-0

T/W : L2201

C/B :

BUSH :

SIZE

STD



## Engine Valve

OEM NO. 16484-13110

IN 33.5 8.0 102.2

OEM NO. 16484-13120

EX 28.5 8.0 102.2

SIZE

STD

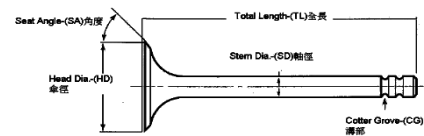

## Valve Seat

OEM NO.

IN

OEM NO.

EX

SIZE

STD

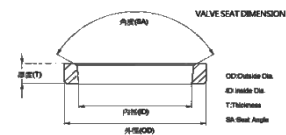

## Valve Guide

OEM NO. 13721-13580

IN 40.0 8.0 13.0

OEM NO. 13721-13560/90

EX 47.0 8.0 13.0

SIZE

STD

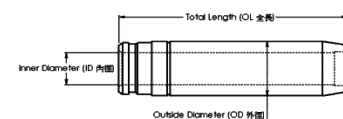

## Gasket Set

OEM NO.



### Piston kit-Set

OEM NO.

Piston

SIZE

Comp : 44.1 Height : -14.0 Length : 80.0

Top Shape :

Pin : 25.0

Length :

STD

### Piston Ring

OEM NO.

NPR :

OEM Ring Groove

SIZE

Top :

2nd :

Oil :

STD



### Cylinder Liner

OEM NO.

Liner&amp;Sleeve

SIZE

In Diameter :

Out Diameter :

Total length :

Flange :

STD



### Engine Bearing

MAIN :

CON.ROD :

T/W :

C/B :

BUSH :

SIZE

STD



### Engine Valve

OEM NO.

IN

OEM NO.

EX

SIZE

STD

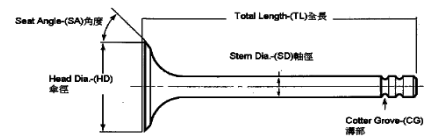

### Valve Seat

OEM NO.

IN

OEM NO.

EX

SIZE

STD

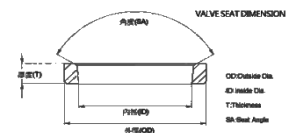

### Valve Guide

OEM NO.

IN

OEM NO.

EX

SIZE

STD

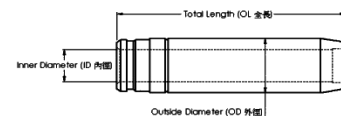

### Gasket Set

OEM NO.



# KUBOTA F2503-B

**Application :**  
Number of Cylinders 5  
Cylinder dia. 83.0 MM  
Swept Volume ccm

## Piston kit-Set

OEM NO.

Piston

SIZE

Comp : 44.9 Height : -1.2 Length : 80.0

Top Shape : Flower

Pin :

Length :

STD



## Piston Ring

OEM NO.

NPR :

OEM Ring Groove

SIZE

Top :

2nd :

Oil :

STD



## Cylinder Liner

OEM NO.

Liner&Sleeve

SIZE

In Diameter :

Out Diameter :

Total length :

Flange :

STD



## Engine Bearing

MAIN :

CON.ROD :

T/W :

C/B :

BUSH :

SIZE

STD



## Engine Valve

OEM NO.

IN

OEM NO.

EX

SIZE

STD

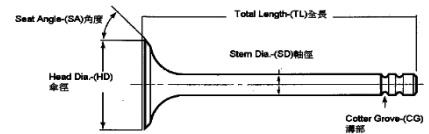

## Valve Seat

OEM NO.

IN

OEM NO.

EX

SIZE

STD

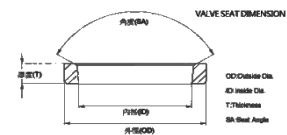

## Valve Guide

OEM NO.

IN

OEM NO.

EX

SIZE

STD

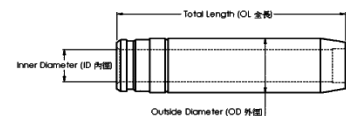

## Gasket Set

OEM NO.







# KUBOTA F5803-B

**Application :**  
Number of Cylinders 5  
Cylinder dia. 109.0 MM  
Swept Volume ccm

## Piston kit-Set

OEM NO.

Piston

SIZE

Comp : Height : Length :  
Top Shape :  
Pin :  
Length :

STD

## Piston Ring

OEM NO.

NPR :

OEM Ring Groove

SIZE

Top :  
2nd :  
Oil :

STD



## Cylinder Liner

OEM NO.

Liner&Sleeve

SIZE

In Diameter :  
Out Diameter :  
Total length :  
Flange :

STD



## Engine Bearing

MAIN :  
CON.ROD :  
T/W :  
C/B :  
BUSH :

SIZE

STD



## Engine Valve

OEM NO.  
IN  
OEM NO.  
EX

SIZE

STD

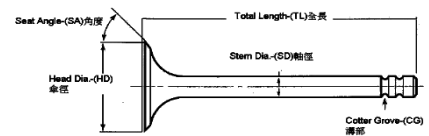

## Valve Seat

OEM NO.  
IN  
OEM NO.  
EX

SIZE

STD

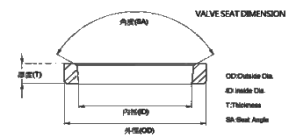

## Valve Guide

OEM NO.  
IN  
OEM NO.  
EX

SIZE

STD

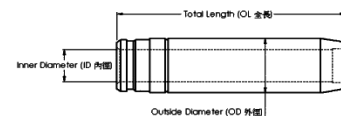

## Gasket Set

OEM NO.



# KUBOTA V1200-B

**Application :**  
**Number of Cylinders 4**  
**Cylinder dia. 75.0 MM**  
**Swept Volume 1237 ccm**

## Piston kit-Set

OEM NO.

Piston

SIZE

Comp : 35.5 Height : Length : 65.5  
 Top Shape :  
 Pin : 20.0  
 Length : 54.0

STD



## Piston Ring

OEM NO.

NPR :

OEM Ring Groove

SIZE

Top : 2.0HK  
 2nd : 1.5  
 Oil : 4.0

STD



## Cylinder Liner

OEM NO.

Liner&Sleeve

SIZE

In Diameter :  
 Out Diameter :  
 Total length :  
 Flange :

STD



## Engine Bearing

MAIN : 15261-23931-8  
 CON.ROD : 15694-22971  
 T/W :  
 C/B :  
 BUSH :

SIZE

STD



## Engine Valve

OEM NO. 15393-13110/15901-13112  
 IN 31.0 7.0 89.6  
 OEM NO. 15393-13120/15901-12122  
 EX 27.5 7.0 89.8

SIZE

STD

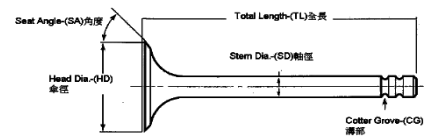

## Valve Seat

OEM NO.  
 IN  
 OEM NO.  
 EX

SIZE

STD

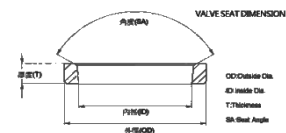

## Valve Guide

OEM NO. 15261-13540  
 IN 40.0 7.0 11.0  
 OEM NO. 15261-13560  
 EX 40.0 7.0 11.0

SIZE

STD

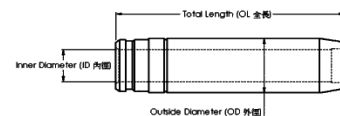

## Gasket Set

OEM NO.



# KUBOTA V1250-B

**Application :**  
**Number of Cylinders 4**  
**Cylinder dia. 72.0 MM**  
**Swept Volume 1198 ccm**

## Piston kit-Set

OEM NO.

Piston

SIZE

Comp : 39.5 Height : -0.6 Length : 67.0  
 Top Shape : Flower  
 Pin : 22.0  
 Length : 60.0

STD



## Piston Ring

OEM NO.

NPR :

OEM Ring Groove

SIZE

Top : 2.0 K  
 2nd : 1.5  
 Oil : 4.0

STD



## Cylinder Liner

OEM NO.

Liner&Sleeve

SIZE

In Diameter :  
 Out Diameter :  
 Total length :  
 Flange :

STD



## Engine Bearing

MAIN : 16241-2345  
 CON.ROD : 16241-2231-1  
 T/W :  
 C/B :  
 BUSH :

SIZE

STD



## Engine Valve

OEM NO. 15393-13110/15901-13112  
 IN 31.0 7.0 89.6  
 OEM NO. 15393-13120/15901-12122  
 EX 27.5 7.0 89.8

SIZE

STD

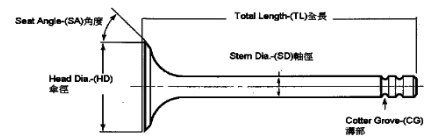

## Valve Seat

OEM NO.  
 IN  
 OEM NO.  
 EX

SIZE

STD

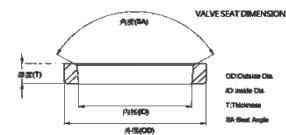

## Valve Guide

OEM NO. 15261-13540  
 IN 40.0 7.0 11.0  
 OEM NO. 15261-13560  
 EX 40.0 7.0 11.0

SIZE

STD

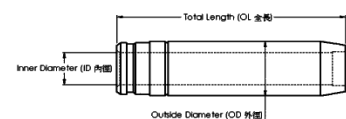

## Gasket Set

OEM NO.



# KUBOTA V1305-B

**Application :**  
**Number of Cylinders 3**  
**Cylinder dia. 76.0 MM**  
**Swept Volume 1335 ccm**

## Piston kit-Set

OEM NO.

Piston

SIZE

Comp : 39.5 Height : -0.7 Length : 68.5  
 Top Shape : Flower  
 Pin : 22.0  
 Length : 60.0

STD



## Piston Ring

OEM NO.

NPR :

OEM Ring Groove

SIZE

Top :  
 2nd :  
 Oil :

STD



## Cylinder Liner

OEM NO.

Liner&Sleeve

SIZE

In Diameter :  
 Out Diameter :  
 Total length :  
 Flange :

STD



## Engine Bearing

MAIN : 16241-2345  
 CON.ROD : 16241-2231-1  
 T/W :  
 C/B :  
 BUSH :

SIZE

STD



## Engine Valve

OEM NO. 15221-13110  
 IN 33.0 8.0 101.0  
 OEM NO. 15221-13120  
 EX 27.0 8.0 101.0

SIZE

STD

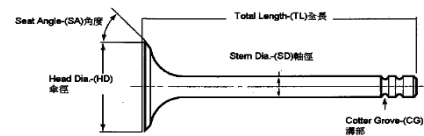

## Valve Seat

OEM NO.  
 IN  
 OEM NO.  
 EX

SIZE

STD

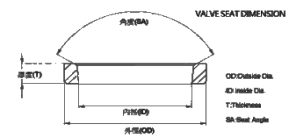

## Valve Guide

OEM NO. VGKU-02-Z  
 IN/EX 48.7 8.0 13.0 M-6

SIZE

STD

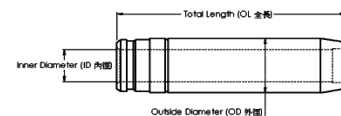

## Gasket Set

OEM NO.



# KUBOTA V1405-B

**Application :**  
**Number of Cylinders 4**  
**Cylinder dia. 76.0 MM**  
**Swept Volume 1422 ccm**

## Piston kit-Set

OEM NO.

Piston

SIZE

Comp : Height : Length :  
 Top Shape :  
 Pin :  
 Length :

STD

## Piston Ring

OEM NO.

NPR :

OEM Ring Groove

SIZE

Top :  
 2nd :  
 Oil :

STD



## Cylinder Liner

OEM NO.

Liner&Sleeve

SIZE

In Diameter :  
 Out Diameter :  
 Total length :  
 Flange :

STD



## Engine Bearing

MAIN :  
 CON.ROD :  
 T/W :  
 C/B :  
 BUSH :

SIZE

STD



## Engine Valve

OEM NO.  
 IN  
 OEM NO.  
 EX

SIZE

STD

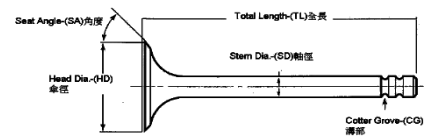

## Valve Seat

OEM NO.  
 IN  
 OEM NO.  
 EX

SIZE

STD

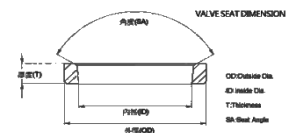

## Valve Guide

OEM NO.  
 IN  
 OEM NO.  
 EX

SIZE

STD

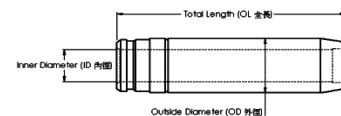

## Gasket Set

OEM NO.





# KUBOTA V1505-B

**Application :**  
**Number of Cylinders 4**  
**Cylinder dia. 78.0 MM**  
**Swept Volume 1498 ccm**

## Piston kit-Set

OEM NO.

Piston

SIZE

Comp : 36.5 Height : -0.6 Length : 69.0  
 Top Shape : Flower  
 Pin : 22.0  
 Length : 60.0

STD



## Piston Ring

OEM NO.

NPR :

OEM Ring Groove

SIZE

Top : 2.0K  
 2nd : 1.5  
 Oil : 4.0

STD



## Cylinder Liner

OEM NO.

Liner&Sleeve

SIZE

In Diameter :  
 Out Diameter :  
 Total length :  
 Flange :

STD



## Engine Bearing

MAIN : 16241-2345  
 CON.ROD : 16241-2231-1  
 T/W :  
 C/B :  
 BUSH :

SIZE

STD



## Engine Valve

OEM NO. 15393-13110/15901-13112  
 IN 31.0 7.0 89.6  
 OEM NO. 15393-13120/15901-12122  
 EX 27.5 7.0 89.8

SIZE

STD

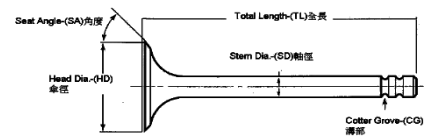

## Valve Seat

OEM NO.  
 IN  
 OEM NO.  
 EX

SIZE

STD

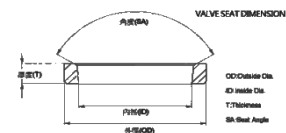

## Valve Guide

OEM NO. 15261-13540  
 IN 40.0 7.0 11.0  
 OEM NO. 15261-13560  
 EX 40.0 7.0 11.0

SIZE

STD

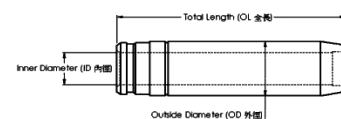

## Gasket Set

OEM NO.



### Piston kit-Set

OEM NO.

Piston

SIZE

Comp : 43.4 Height : -12.3 Length : 80.0  
 Top Shape : Ø42.0  
 Pin : 25.0  
 Length : 64.0

STD

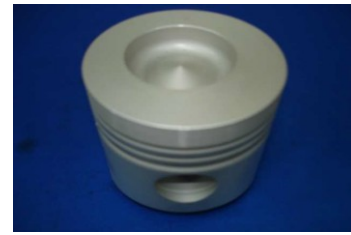

### Piston Ring

OEM NO.

NPR :

OEM Ring Groove

SIZE

Top : 2.5K  
 2nd : 2.0  
 Oil : 5.0

STD



### Cylinder Liner

OEM NO.

Liner&Sleeve

SIZE

In Diameter :  
 Out Diameter :  
 Total length :  
 Flange :

STD



### Engine Bearing

MAIN :  
 CON.ROD :  
 T/W :  
 C/B :  
 BUSH :

SIZE

STD



### Engine Valve

OEM NO.  
 IN  
 OEM NO.  
 EX

SIZE

STD

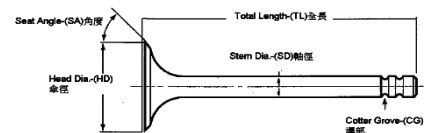

### Valve Seat

OEM NO.  
 IN  
 OEM NO.  
 EX

SIZE

STD

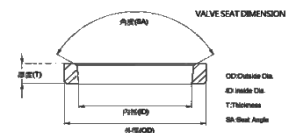

### Valve Guide

OEM NO.  
 IN  
 OEM NO.  
 EX

SIZE

STD

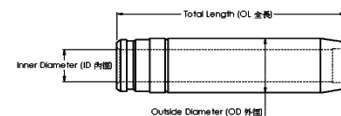

### Gasket Set

OEM NO.





# KUBOTA V1512-B

**Application :**  
**Number of Cylinders 4**  
**Cylinder dia. 76.3 MM**  
**Swept Volume 1335 ccm**

## Piston kit-Set

OEM NO.

Piston

SIZE

Comp : 43.8 Height : -2.2 Length : 80.0  
 Top Shape : Flower  
 Pin : 25.0  
 Length :

STD



## Piston Ring

OEM NO.

NPR :

OEM Ring Groove

SIZE

Top : 2.5HK  
 2nd : 2.0  
 Oil : 5.0

STD



## Cylinder Liner

OEM NO.

Liner&Sleeve

SIZE

In Diameter :  
 Out Diameter :  
 Total length :  
 Flange :

STD



## Engine Bearing

MAIN : TDC ML2201  
 CON.ROD : R2201  
 T/W :  
 C/B :  
 BUSH :

SIZE

STD



## Engine Valve

OEM NO. 16484-13110  
 IN 33.5 8.0 102.2  
 OEM NO. 16484-13120  
 EX 28.5 8.0 102.2

SIZE

STD

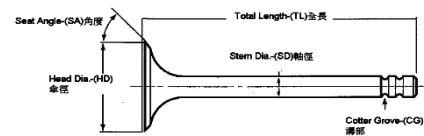

## Valve Seat

OEM NO.  
 IN  
 OEM NO.  
 EX

SIZE

STD

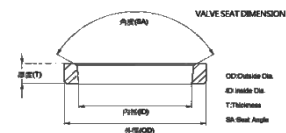

## Valve Guide

OEM NO. 13721-13580  
 IN 40.0 8.0 13.0  
 OEM NO. 13721-13560/90  
 EX 47.0 8.0 13.0

SIZE

STD

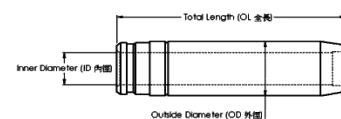

## Gasket Set

OEM NO.



# KUBOTA V1702-B

**Application :**  
Number of Cylinders 4  
Cylinder dia. 82.0 MM  
Swept Volume 1732 ccm

## Piston kit-Set

OEM NO.

Piston

SIZE

Comp : 43.9 Height : Length : 80.0

Top Shape :

Pin : 23.0

Length : 64.0

STD



## Piston Ring

OEM NO.

NPR :

OEM Ring Groove

SIZE

Top : 2.5K

2nd : 2.0

Oil : 5.0

STD



## Cylinder Liner

OEM NO.

Liner&Sleeve

SIZE

In Diameter :

Out Diameter :

Total length :

Flange :

STD



## Engine Bearing

MAIN : ML2201

CON.ROD : R2201

T/W : L2201

C/B :

BUSH :

SIZE

STD



## Engine Valve

OEM NO. 15221-13110

IN 33.0 8.0 101.0

OEM NO. 15221-13120

EX 27.0 8.0 101.0

SIZE

STD

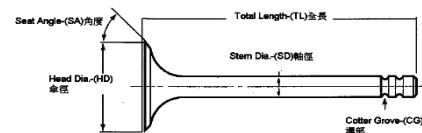

## Valve Seat

OEM NO.

IN

OEM NO.

EX

SIZE

STD

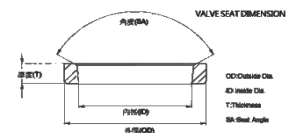

## Valve Guide

OEM NO. VGKU-02-Z

IN/EX 48.7 8.0 13.0 M-6

SIZE

STD

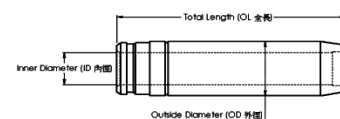

## Gasket Set

OEM NO.



# KUBOTA V1902-B

**Application :**  
**Number of Cylinders 4**  
**Cylinder dia. 85.0 MM**  
**Swept Volume 1861 ccm**

## Piston kit-Set

OEM NO.

Piston

SIZE

Comp : 43.9 Height : Length : 80.0

Top Shape :

Pin : 23.0

Length : 64.0

STD



## Piston Ring

OEM NO.

NPR :

OEM Ring Groove

SIZE

Top : 2.5K

2nd : 2.0

Oil : 5.0

STD



## Cylinder Liner

OEM NO.

Liner&Sleeve

SIZE

In Diameter :

Out Diameter :

Total length :

Flange :

STD



## Engine Bearing

MAIN : ML2201

CON.ROD : R2201

T/W : L2201

C/B :

BUSH :

SIZE

STD



## Engine Valve

OEM NO. 15221-13110

IN 33.0 8.0 101.0

OEM NO. 15221-13120

EX 27.0 8.0 101.0

SIZE

STD

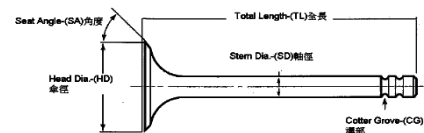

## Valve Seat

OEM NO.

IN

OEM NO.

EX

SIZE

STD

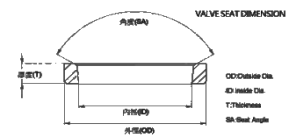

## Valve Guide

OEM NO. VGKU-02-Z

IN/EX 48.7 8.0 13.0 M-6

SIZE

STD

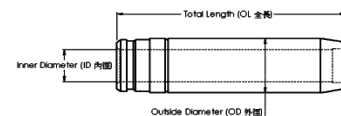

## Gasket Set

OEM NO.



# KUBOTA V1903-B

**Application :**  
**Number of Cylinders 4**  
**Cylinder dia. 80.0 MM**  
**Swept Volume 1857 ccm**

## Piston kit-Set

OEM NO. 16427-21113

Piston	SIZE
Comp : 43.5 Height : -1.7 Length : 80.0 Top Shape : Flower Pin : 25.0 Length : 64.0	STD



## Piston Ring

OEM NO. 16427-21050

NPR :

OEM Ring Groove	SIZE
Top : 2.5HK 2nd : 2.0 Oil : 5.0	STD



## Cylinder Liner

OEM NO.

Liner&Sleeve	SIZE
In Diameter : Out Diameter : Total length : Flange :	STD



## Engine Bearing

MAIN : ML2201  
CON.ROD : 17311-2231-0  
T/W :  
C/B :  
BUSH :

SIZE  
STD



## Engine Valve

OEM NO. 16484-13110  
IN 33.5 8.0 102.2  
OEM NO. 16484-13120  
EX 28.5 8.0 102.2

SIZE  
STD

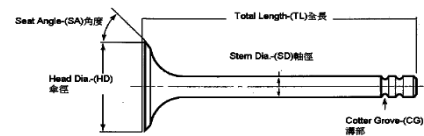

## Valve Seat

OEM NO.  
IN  
OEM NO.  
EX

SIZE  
STD

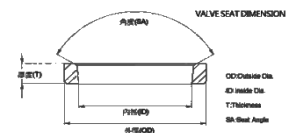

## Valve Guide

OEM NO. 13721-13580  
IN 40.0 8.0 13.0  
OEM NO. 13721-13560/90  
EX 47.0 8.0 13.0

SIZE  
STD

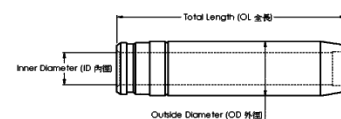

## Gasket Set

OEM NO.



### Piston kit-Set

OEM NO.

Piston

SIZE

Comp : 44.9 Height : -1.2 Length : 80.0  
 Top Shape : Flower  
 Pin :  
 Length :

STD



### Piston Ring

OEM NO.

NPR :

OEM Ring Groove

SIZE

Top : 2.5  
 2nd : 2.0  
 Oil : 4.5

STD



### Cylinder Liner

OEM NO.

Liner&Sleeve

SIZE

In Diameter :  
 Out Diameter :  
 Total length :  
 Flange :

STD



### Engine Bearing

MAIN : ML2201  
 CON.ROD : 17311-2231-0  
 T/W : L2201  
 C/B :  
 BUSH :

SIZE

STD



### Engine Valve

OEM NO. 16484-13110  
 IN 33.5 8.0 102.2  
 OEM NO. 16484-13120  
 EX 28.5 8.0 102.2

SIZE

STD

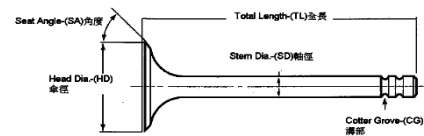

### Valve Seat

OEM NO.  
 IN  
 OEM NO.  
 EX

SIZE

STD

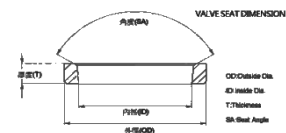

### Valve Guide

OEM NO. 13721-13580  
 IN 40.0 8.0 13.0  
 OEM NO. 13721-13560/90  
 EX 47.0 8.0 13.0

SIZE

STD

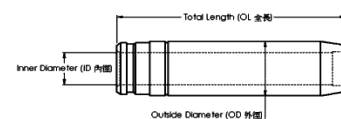

### Gasket Set

OEM NO.



# KUBOTA V2203 KOREA

**Application :**  
**Number of Cylinders 4**  
**Cylinder dia. 87.0 MM**  
**Swept Volume 2197 ccm**

## Piston kit-Set

OEM NO.

Piston

SIZE

Comp : 43.5 Height : -1.1 Length : 80.0  
 Top Shape : Flower  
 Pin : 25.0  
 Length : 64.0

STD



## Piston Ring

OEM NO.

NPR :

OEM Ring Groove

SIZE

Top : 2.5K  
 2nd : 2.0  
 Oil : 5.0

STD



## Cylinder Liner

OEM NO.

Liner&Sleeve

SIZE

In Diameter :  
 Out Diameter :  
 Total length :  
 Flange :

STD



## Engine Bearing

MAIN : ML2201

CON.ROD : 17311-2231-0

T/W : L2201

C/B :

BUSH :

SIZE

STD



## Engine Valve

OEM NO. 16484-13110

IN 33.5 8.0 102.2

OEM NO. 16484-13120

EX 28.5 8.0 102.2

SIZE

STD

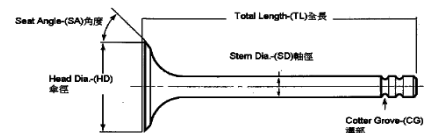

## Valve Seat

OEM NO.

IN

OEM NO.

EX

SIZE

STD

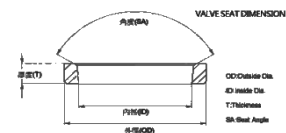

## Valve Guide

OEM NO. 13721-13580

IN 40.0 8.0 13.0

OEM NO. 13721-13560/90

EX 47.0 8.0 13.0

SIZE

STD

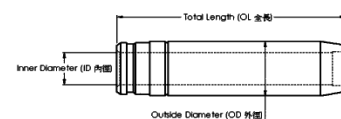

## Gasket Set

OEM NO.



# KUBOTA

## V2203-B

**Application :**  
**Number of Cylinders 4**  
**Cylinder dia. 87.0 MM**  
**Swept Volume 2197 ccm**

### Piston kit-Set

OEM NO.

Piston

SIZE

Comp : 44.5 Height : -1.5 Length : 80.0  
 Top Shape : Flower  
 Pin : 25.0  
 Length : 64.0

STD



### Piston Ring

OEM NO.

NPR :

OEM Ring Groove

SIZE

Top : 2.5K  
 2nd : 2.0  
 Oil : 5.0

STD



### Cylinder Liner

OEM NO.

Liner&Sleeve

SIZE

In Diameter :  
 Out Diameter :  
 Total length :  
 Flange :

STD



### Engine Bearing

MAIN : ML2201

CON.ROD : 17311-2231-0

T/W : L2201

C/B :

BUSH :

SIZE

STD



### Engine Valve

OEM NO. 16484-13110

IN 33.5 8.0 102.2

OEM NO. 16484-13120

EX 28.5 8.0 102.2

SIZE

STD

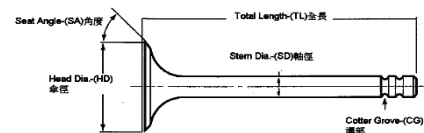

### Valve Seat

OEM NO.

IN

OEM NO.

EX

SIZE

STD

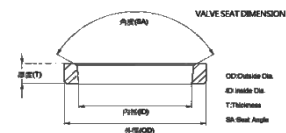

### Valve Guide

OEM NO. 13721-13580

IN 40.0 8.0 13.0

OEM NO. 13721-13560/90

EX 47.0 8.0 13.0

SIZE

STD

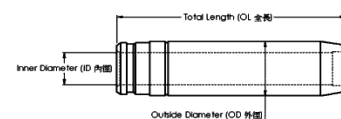

### Gasket Set

OEM NO.



### Piston kit-Set

OEM NO.

Piston

SIZE

Comp : 44.5 Height : -14.5 Length : 80.0  
 Top Shape : Ø47.0  
 Direct Injection  
 Pin : 25.0 Length : 64.0

STD

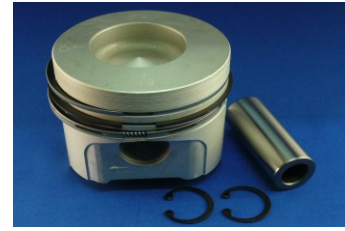

### Piston Ring

OEM NO.

NPR :

OEM Ring Groove

SIZE

Top : 2.5K  
 2nd : 2.0  
 Oil : 5.0

STD



### Cylinder Liner

OEM NO.

Liner&Sleeve

SIZE

In Diameter :  
 Out Diameter :  
 Total length :  
 Flange :

STD



### Engine Bearing

MAIN : ML2201

CON.ROD : 17311-2231-0

T/W : L2201

C/B :

BUSH :

SIZE

STD



### Engine Valve

OEM NO. 17111-13110

IN 37.5 8.0 101.5

OEM NO. 17111-13120

EX 32.0 8.0 101.5

SIZE

STD

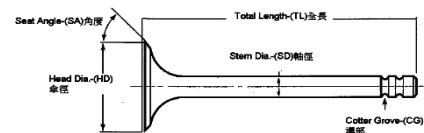

### Valve Seat

OEM NO.

IN

OEM NO.

EX

SIZE

STD

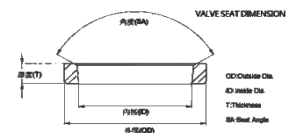

### Valve Guide

OEM NO. 13721-13580

IN 40.0 8.0 13.0

OEM NO. 13721-13560/90

EX 47.0 8.0 13.0

SIZE

STD

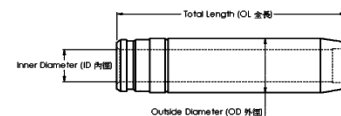

### Gasket Set

OEM NO.





# KUBOTA V2203-B

**Application :**  
**Number of Cylinders 4**  
**Cylinder dia. 87.0 MM**  
**Swept Volume 2197 ccm**

## Piston kit-Set

OEM NO. 1G813-21110



Piston	SIZE
Comp : 43.6 Height : -1.7 MOS2 Length : 80.0 Top Shape : Flower Pin : 25.0 Length : 64.0	STD

## Piston Ring

OEM NO. 1A091-21050

NPR :



OEM Ring Groove	SIZE
Top : 2.0HK 2nd : 2.0 Oil : 5.0	STD

## Cylinder Liner

OEM NO.



Liner&Sleeve	SIZE
In Diameter : Out Diameter : Total length : Flange :	STD

## Engine Bearing

MAIN : ML2201  
CON.ROD : 17311-2231-0  
T/W : L2201  
C/B :  
BUSH :



	SIZE
	STD

## Engine Valve

OEM NO. 16484-13110  
IN 33.5 8.0 102.2  
OEM NO. 16484-13120  
EX 28.5 8.0 102.2

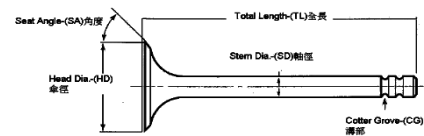

	SIZE
	STD

## Valve Seat

OEM NO.  
IN  
OEM NO.  
EX

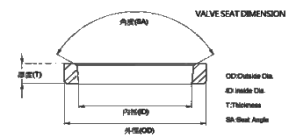

	SIZE
	STD

## Valve Guide

OEM NO. 13721-13580  
IN 40.0 8.0 13.0  
OEM NO. 13721-13560/90  
EX 47.0 8.0 13.0

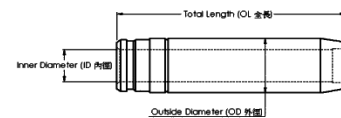

	SIZE
	STD

## Gasket Set

OEM NO.



### Piston kit-Set

OEM NO.

Piston

SIZE

Comp : 43.8 Height : -17.4 Length : 80.0  
 Top Shape : Ø40.0  
 Direct Injection  
 Pin : 25.0 Length : 63.0

STD



### Piston Ring

OEM NO. 1G790-21053  
 NPR :

OEM Ring Groove

SIZE

Top : 2.0  
 2nd : 2.0  
 Oil : 4.0

STD



### Cylinder Liner

OEM NO.

Liner&Sleeve

SIZE

In Diameter :  
 Out Diameter :  
 Total length :  
 Flange :

STD



### Engine Bearing

MAIN : ML2201  
 CON.ROD : 17311-2231-0  
 T/W : L2201  
 C/B :  
 BUSH :

SIZE

STD



### Engine Valve

OEM NO. 17111-13110  
 IN 37.5 8.0 101.5  
 OEM NO. 17111-13120  
 EX 32.0 8.0 101.5

SIZE

STD

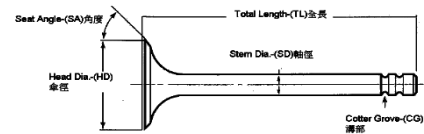

### Valve Seat

OEM NO.  
 IN  
 OEM NO.  
 EX

SIZE

STD

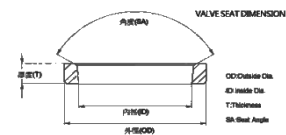

### Valve Guide

OEM NO. 13721-13580  
 IN 40.0 8.0 13.0  
 OEM NO. 13721-13560/90  
 EX 47.0 8.0 13.0

SIZE

STD

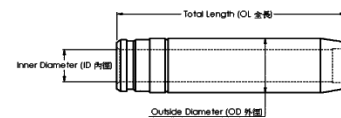

### Gasket Set

OEM NO.



**Piston kit-Set**

OEM NO.

Piston

SIZE

Comp : 43.5 Height : -16.0 Length : 80.0  
Top Shape : Ø47.0  
Direct Injection  
Pin : 25.0 Length : 64.0

STD



**Piston Ring**

OEM NO. 1G790-2105-3  
NPR :

OEM Ring Groove

SIZE

Top : 2.0  
2nd : 2.0  
Oil : 4.0

STD



**Cylinder Liner**

OEM NO.

Liner&Sleeve

SIZE

In Diameter :  
Out Diameter :  
Total length :  
Flange :

STD



**Engine Bearing**

MAIN :  
CON.ROD :  
T/W :  
C/B :  
BUSH :

SIZE

STD



**Engine Valve**

OEM NO.  
IN  
OEM NO.  
EX

SIZE

STD

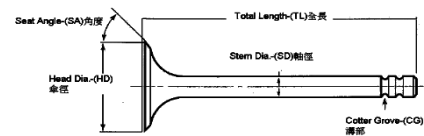

**Valve Seat**

OEM NO.  
IN  
OEM NO.  
EX

SIZE

STD

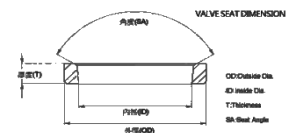

**Valve Guide**

OEM NO.  
IN  
OEM NO.  
EX

SIZE

STD

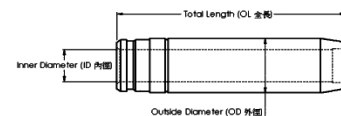

**Gasket Set**

OEM NO.



# KUBOTA V2607

**Application :**  
**Number of Cylinders 4**  
**Cylinder dia. 87.0 MM**  
**Swept Volume 2615 ccm**

## Piston kit-Set

OEM NO. 1J700-21110



Piston

SIZE

Comp : 39.15 w/al-fin Height : -16.0 Length : 80.2 MOS2  
 Top Shape : Ø45.5  
 Direct Injection  
 Pin : 26.0 Length : 68.0

STD

## Piston Ring

OEM NO. 1J700-21050

NPR :



OEM Ring Groove

SIZE

Top : 2.0  
 2nd : 1.5  
 Oil : 3.0

STD

## Cylinder Liner

OEM NO.



Liner&Sleeve

SIZE

In Diameter :  
 Out Diameter :  
 Total length :  
 Flange :

STD

## Engine Bearing

MAIN :  
 CON.ROD : 17311-2231-0  
 T/W :  
 C/B :  
 BUSH :



SIZE

STD

## Engine Valve

OEM NO. 1J700-13110  
 IN 29.5 6.0 93.0  
 OEM NO. 1J700-13120  
 EX 26.0 6.0 93.0

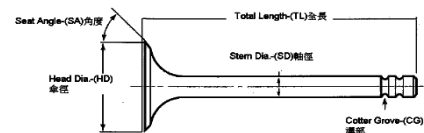

SIZE

STD

## Valve Seat

OEM NO.  
 IN  
 OEM NO.  
 EX

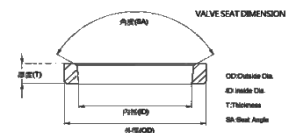

SIZE

STD

## Valve Guide

OEM NO. 1J700-13540  
 IN 37.0 6.0 10.5  
 OEM NO. 1J700-13560  
 EX 37.0 6.0 10.5

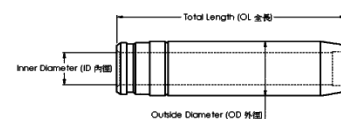

SIZE

STD

## Gasket Set

OEM NO.



# KUBOTA

## V3300-B

**Application :**  
**Number of Cylinders 4**  
**Cylinder dia. 98.0 MM**  
**Swept Volume 3318 ccm**

### Piston kit-Set

OEM NO.

Piston

SIZE

Comp : 46.8 Height : -3.1 Length : 92.0  
 Top Shape : Flower  
 Pin : 30.0  
 Length : 75.0

STD

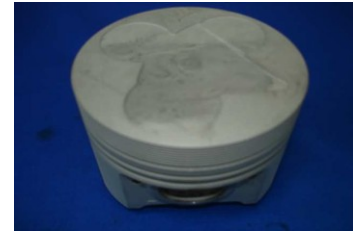

### Piston Ring

OEM NO. 1C010-21050

NPR :

OEM Ring Groove

SIZE

Top : 2.0K  
 2nd : 2.0  
 Oil : 4.0

STD



### Cylinder Liner

OEM NO.

Liner&Sleeve

SIZE

In Diameter :  
 Out Diameter :  
 Total length :  
 Flange :

STD



### Engine Bearing

MAIN : 1C020-23910

CON.ROD :

T/W :

C/B :

BUSH :

SIZE

STD



### Engine Valve

OEM NO. 1C020-13112

IN 31.0 7.0 101.2

OEM NO. 1C020-13122

EX 34.0 8.0 112.5

SIZE

STD

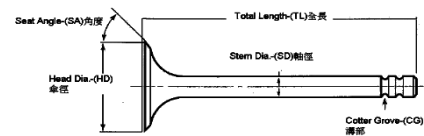

### Valve Seat

OEM NO.

IN

OEM NO.

EX

SIZE

STD

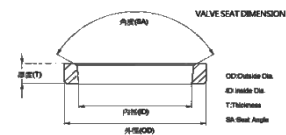

### Valve Guide

OEM NO. 16261-13560

IN 40.0 7.0 12.0

OEM NO. 16261-13540

EX 47.0 8.0 13.0

SIZE

STD

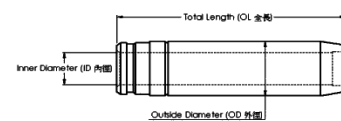

### Gasket Set

OEM NO.



# KUBOTA

## V3300-B

**Application :**  
**Number of Cylinders 4**  
**Cylinder dia. 98.0 MM**  
**Swept Volume 3318 ccm**

### Piston kit-Set

OEM NO. 1C010-21110

Piston	SIZE
Comp : 47.0 Height : -3.1 Length : 84.0 Top Shape : Flower Pin : 30.0 Length : 75.0	STD

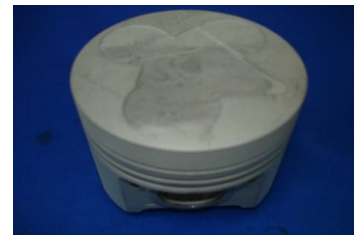

### Piston Ring

OEM NO. 1C010-21050/1C010-21090  
 NPR :

OEM Ring Groove	SIZE
Top : 2.0K 2nd : 2.0 Oil : 4.0	STD



### Cylinder Liner

OEM NO.

Liner&Sleeve	SIZE
In Diameter : Out Diameter : Total length : Flange :	STD



### Engine Bearing

MAIN : 1C020-23910  
 CON.ROD :  
 T/W :  
 C/B :  
 BUSH :

SIZE  
 STD



### Engine Valve

OEM NO. 1C020-13112  
 IN 31.0 7.0 101.2  
 OEM NO. 1C020-13122  
 EX 34.0 8.0 112.5

SIZE  
 STD

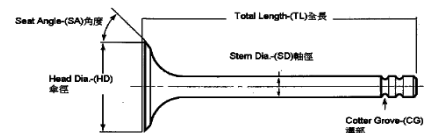

### Valve Seat

OEM NO.  
 IN  
 OEM NO.  
 EX

SIZE  
 STD

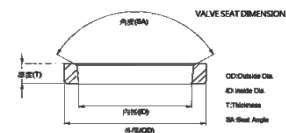

### Valve Guide

OEM NO. 16261-13560  
 IN 40.0 7.0 12.0  
 OEM NO. 16261-13540  
 EX 47.0 8.0 13.0

SIZE  
 STD

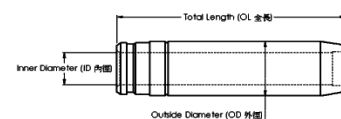

### Gasket Set

OEM NO.



### Piston kit-Set

OEM NO. 1C011-21110

Piston	SIZE
Comp : 46.8 Height : -3.1 Length : 91.7 Top Shape : Flower Pin : 30.0 Length : 75.0	STD



### Piston Ring

OEM NO. 1C010-21050/1C010-21090  
NPR :

OEM Ring Groove	SIZE
Top : 2.0HK 2nd : 2.0 Oil : 3.0	STD



### Cylinder Liner

OEM NO.

Liner&Sleeve	SIZE
In Diameter : Out Diameter : Total length : Flange :	STD



### Engine Bearing

MAIN : 1C020-23910  
CON.ROD :  
T/W :  
C/B :  
BUSH :

SIZE  
STD



### Engine Valve

OEM NO. 1C020-13112  
IN 31.0 7.0 101.2  
OEM NO. 1C020-13122  
EX 34.0 8.0 112.5

SIZE  
STD

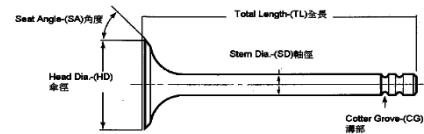

### Valve Seat

OEM NO.  
IN  
OEM NO.  
EX

SIZE  
STD

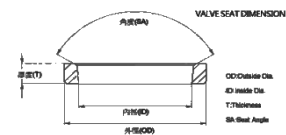

### Valve Guide

OEM NO. 16261-13560  
IN 40.0 7.0 12.0  
OEM NO. 16261-13540  
EX 47.0 8.0 13.0

SIZE  
STD

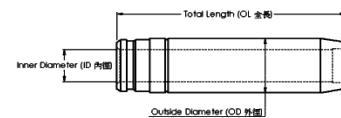

### Gasket Set

OEM NO.



# KUBOTA V3300-DIE

**Application :**  
**Number of Cylinders 4**  
**Cylinder dia. 98.0 MM**  
**Swept Volume ccm**

## Piston kit-Set

OEM NO. 1C050-21112

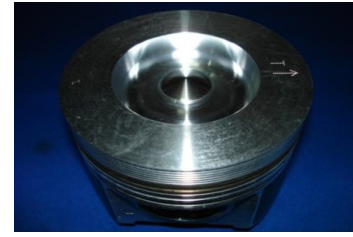

Piston

SIZE

Comp : 46.7 w/al-fin Height : -18.4 Length : 91.7 MOS2  
 Top Shape : Ø57.0  
 Direct Injection  
 Pin : Length :

STD

## Piston Ring

OEM NO.

NPR :



OEM Ring Groove

SIZE

Top : 2.0  
 2nd : 2.0  
 Oil : 3.0

STD

## Cylinder Liner

OEM NO.

Liner&Sleeve

SIZE

In Diameter :  
 Out Diameter :  
 Total length :  
 Flange :

STD



## Engine Bearing

MAIN :  
 CON.ROD :  
 T/W :  
 C/B :  
 BUSH :

SIZE

STD



## Engine Valve

OEM NO. 1C020-13112  
 IN 31.0 7.0 101.2  
 OEM NO. 1C020-13122  
 EX 34.0 8.0 112.5

SIZE

STD

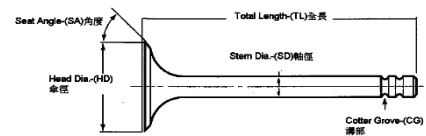

## Valve Seat

OEM NO.  
 IN  
 OEM NO.  
 EX

SIZE

STD

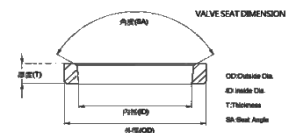

## Valve Guide

OEM NO. 16261-13560  
 IN 40.0 7.0 12.0  
 OEM NO. 16261-13540  
 EX 47.0 8.0 13.0

SIZE

STD

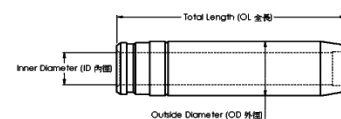

## Gasket Set

OEM NO.





# KUBOTA V3300-TIE

**Application :**  
**Number of Cylinders 4**  
**Cylinder dia. 98.0 MM**  
**Swept Volume 3318 ccm**

## Piston kit-Set

OEM NO. 1C050-21112-2

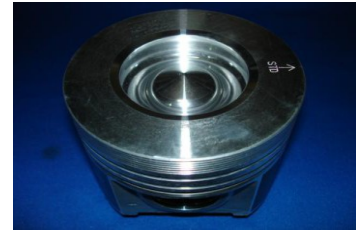

Piston

SIZE

Comp : 46.7 w/al-fin Height : -16.8 Length : 92.0 MOS2  
 Top Shape : Ø52.0  
 Direct Injection  
 Pin : 30.0 Length : 75.0

STD

## Piston Ring

OEM NO.

NPR :



OEM Ring Groove

SIZE

Top : 2.0  
 2nd : 2.0  
 Oil : 3.0

STD

## Cylinder Liner

OEM NO.

Liner&Sleeve

SIZE

In Diameter :  
 Out Diameter :  
 Total length :  
 Flange :

STD



## Engine Bearing

MAIN :  
 CON.ROD :  
 T/W :  
 C/B :  
 BUSH :

SIZE

STD



## Engine Valve

OEM NO. 1C020-13112  
 IN 31.0 7.0 101.2  
 OEM NO. 1C020-13122  
 EX 34.0 8.0 112.5

SIZE

STD

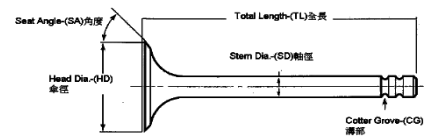

## Valve Seat

OEM NO.  
 IN  
 OEM NO.  
 EX

SIZE

STD

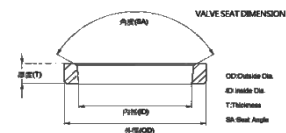

## Valve Guide

OEM NO. 16261-13560  
 IN 40.0 7.0 12.0  
 OEM NO. 16261-13540  
 EX 47.0 8.0 13.0

SIZE

STD

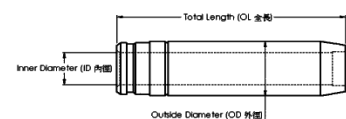

## Gasket Set

OEM NO.



# KUBOTA V3600

**Application :**  
**Number of Cylinders 4**  
**Cylinder dia. 98.0 MM**  
**Swept Volume 3620 ccm**

## Piston kit-Set

OEM NO. 1J500-21113



Piston

SIZE

Comp : 43.7 w/al-fin Height : -5.2 Length : 85.0 MOS2  
 Top Shape : Flower  
 Head Anodized  
 Pin : 30.0 Length : 74.0

STD

## Piston Ring

OEM NO. 1CO11-21052

NPR :



OEM Ring Groove

SIZE

Top : 2.0HK  
 2nd : 2.0  
 Oil : 3.0

STD

## Cylinder Liner

OEM NO.



Liner&Sleeve

SIZE

In Diameter :  
 Out Diameter :  
 Total length :  
 Flange :

STD

## Engine Bearing

MAIN :  
 CON.ROD :  
 T/W :  
 C/B :  
 BUSH :

SIZE



STD

## Engine Valve

OEM NO.  
 IN  
 OEM NO.  
 EX

SIZE

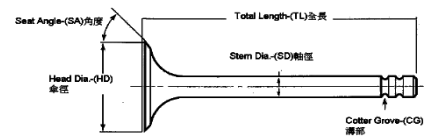

STD

## Valve Seat

OEM NO.  
 IN  
 OEM NO.  
 EX

SIZE

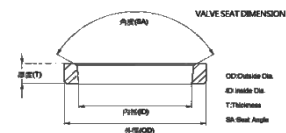

STD

## Valve Guide

OEM NO.  
 IN  
 OEM NO.  
 EX

SIZE

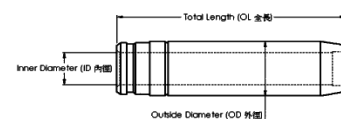

STD

## Gasket Set

OEM NO.



# KUBOTA

## V3800

**Application :**  
 Number of Cylinders 4  
 Cylinder dia. 100.0 MM  
 Swept Volume 3769 ccm

### Piston kit-Set

OEM NO. 1G574-21912



Piston

SIZE

Comp : 44.0 w/al-fin Height : -19.1 Length : 85.5 MOS2  
 Top Shape : Ø59.0  
 Direct Injection  
 Pin : 30.0 Length : 74.0

STD

### Piston Ring

OEM NO.

NPR :



OEM Ring Groove

SIZE

Top : 2.0  
 2nd : 2.0  
 Oil : 3.0

STD

### Cylinder Liner

OEM NO.

Liner&Sleeve

SIZE

In Diameter :  
 Out Diameter :  
 Total length :  
 Flange :

STD



### Engine Bearing

MAIN :  
 CON.ROD :  
 T/W :  
 C/B :  
 BUSH :

SIZE

STD



### Engine Valve

OEM NO. 1C020-13112  
 IN 31.0 7.0 101.2  
 OEM NO. 1C020-13122  
 EX 34.0 8.0 112.5

SIZE

STD

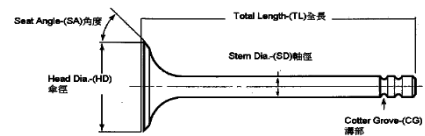

### Valve Seat

OEM NO.  
 IN  
 OEM NO.  
 EX

SIZE

STD

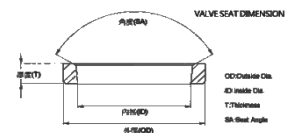

### Valve Guide

OEM NO. 16261-13560  
 IN 40.0 7.0 12.0  
 OEM NO. 16261-13540  
 EX 47.0 8.0 13.0

SIZE

STD

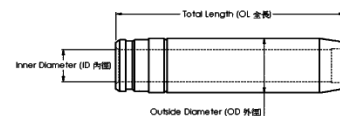

### Gasket Set

OEM NO.



# KUBOTA V3800T

**Application :**  
Number of Cylinders 4  
Cylinder dia. 100.0 MM  
Swept Volume 3769 ccm

## Piston kit-Set

OEM NO. 1G544-21110

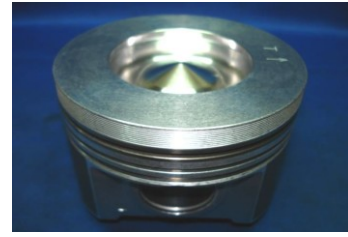

Piston	SIZE
Comp : 44.2 w/al-fin Height : -18.3 Length : 85.1 MOS2 Top Shape : Ø57.0 Direct Injection Pin : 30.0 Length : 74.0	STD

## Piston Ring

OEM NO. 1J500-21050

NPR :



OEM Ring Groove	SIZE
Top : 2.0 2nd : 2.0 Oil : 3.0	STD

## Cylinder Liner

OEM NO.



Liner&Sleeve	SIZE
In Diameter : Out Diameter : Total length : Flange :	STD

## Engine Bearing

MAIN :  
CON.ROD :  
T/W :  
C/B :  
BUSH :



	SIZE
	STD

## Engine Valve

OEM NO. 1C020-13112  
IN 31.0 7.0 101.2  
OEM NO. 1C020-13122  
EX 34.0 8.0 112.5

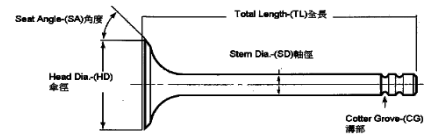

	SIZE
	STD

## Valve Seat

OEM NO.  
IN  
OEM NO.  
EX

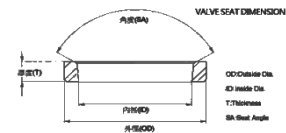

	SIZE
	STD

## Valve Guide

OEM NO. 16261-13560  
IN 40.0 7.0 12.0  
OEM NO. 16261-13540  
EX 47.0 8.0 13.0

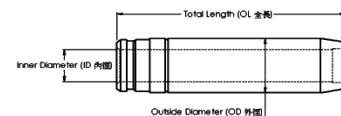

	SIZE
	STD

## Gasket Set

OEM NO.



# KUBOTA V4000-1A

**Application :**  
**Number of Cylinders 4**  
**Cylinder dia. 105.0 MM**  
**Swept Volume ccm**

## Piston kit-Set

OEM NO. 15451-21110

Piston	SIZE
Comp : 63.0 Height : -27.0 Length : 108.0 Top Shape : Ø49.5 Direct Injection Pin : 35.0 Length : 87.0	STD

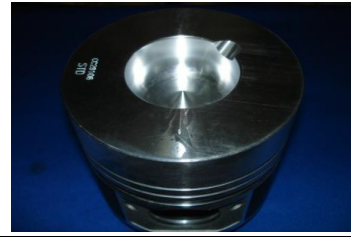

## Piston Ring

OEM NO. 15451-21050

NPR :

OEM Ring Groove	SIZE
Top : 2.5 2nd : 2.5 Oil : 5.5	STD



## Cylinder Liner

OEM NO.

Liner&Sleeve	SIZE
In Diameter : Out Diameter : Total length : Flange :	STD



## Engine Bearing

MAIN :	SIZE
CON.ROD : T/W : C/B : BUSH :	STD



## Engine Valve

OEM NO.	SIZE
IN OEM NO. EX	STD

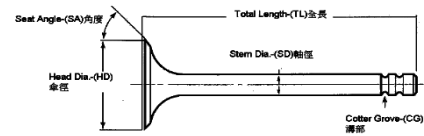

## Valve Seat

OEM NO.	SIZE
IN OEM NO. EX	STD

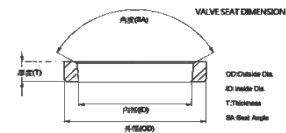

## Valve Guide

OEM NO.	SIZE
IN OEM NO. EX	STD

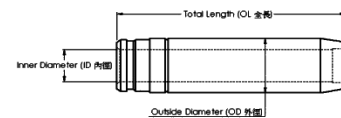

## Gasket Set

OEM NO.



# KUBOTA

## V4300-3A

**Application :**  
 Number of Cylinders 4  
 Cylinder dia. 109.0 MM  
 Swept Volume ccm

### Piston kit-Set

OEM NO. 16132-21110

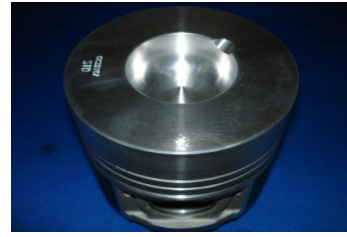

Piston

SIZE

Comp : 63.3 Height : -27.5 Length : 108.0  
 Top Shape : Ø51.8  
 Direct Injection  
 Pin : 35.0 Length : 87.0

STD

### Piston Ring

OEM NO.  
 NPR :



OEM Ring Groove

SIZE

Top : 2.5  
 2nd : 2.5  
 Oil : 5.5

STD

### Cylinder Liner

OEM NO.



Liner&Sleeve

SIZE

In Diameter :  
 Out Diameter :  
 Total length :  
 Flange :

STD

### Engine Bearing

MAIN :  
 CON.ROD :  
 T/W :  
 C/B :  
 BUSH :

SIZE



STD

### Engine Valve

OEM NO.  
 IN  
 OEM NO.  
 EX

SIZE

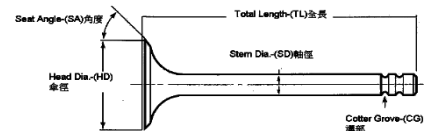

STD

### Valve Seat

OEM NO.  
 IN  
 OEM NO.  
 EX

SIZE

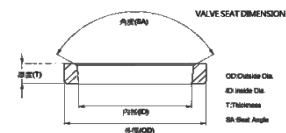

STD

### Valve Guide

OEM NO.  
 IN  
 OEM NO.  
 EX

SIZE

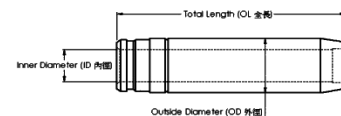

STD

### Gasket Set

OEM NO.



# KUBOTA V4702

**Application :**  
Number of Cylinders 4  
Cylinder dia. MM  
Swept Volume ccm

## Piston kit-Set

OEM NO.

Piston

SIZE

Comp : Height : Length :  
Top Shape :  
Pin :  
Length :

STD

## Piston Ring

OEM NO.

NPR :

OEM Ring Groove

SIZE

Top :  
2nd :  
Oil :

STD



## Cylinder Liner

OEM NO.

Liner&Sleeve

SIZE

In Diameter :  
Out Diameter :  
Total length :  
Flange :

STD



## Engine Bearing

MAIN :  
CON.ROD :  
T/W :  
C/B :  
BUSH :

SIZE

STD



## Engine Valve

OEM NO.  
IN  
OEM NO.  
EX

SIZE

STD

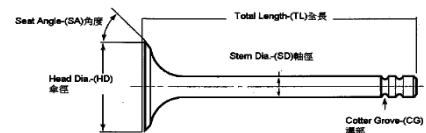

## Valve Seat

OEM NO.  
IN  
OEM NO.  
EX

SIZE

STD

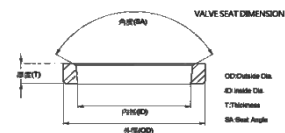

## Valve Guide

OEM NO.  
IN  
OEM NO.  
EX

SIZE

STD

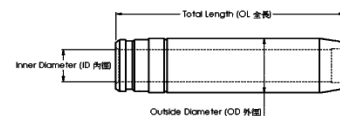

## Gasket Set

OEM NO.



# KUBOTA Z482-B

**Application :**  
**Number of Cylinders 2**  
**Cylinder dia. 67.0 MM**  
**Swept Volume 479 ccm**

## Piston kit-Set

OEM NO.

Piston

SIZE

Comp : Height : Length :  
 Top Shape :  
 Pin :  
 Length :

STD

## Piston Ring

OEM NO.

NPR :

OEM Ring Groove

SIZE

Top :  
 2nd :  
 Oil :

STD



## Cylinder Liner

OEM NO.

Liner&Sleeve

SIZE

In Diameter :  
 Out Diameter :  
 Total length :  
 Flange :

STD



## Engine Bearing

MAIN :  
 CON.ROD :  
 T/W :  
 C/B :  
 BUSH :

SIZE

STD



## Engine Valve

OEM NO.  
 IN  
 OEM NO.  
 EX

SIZE

STD

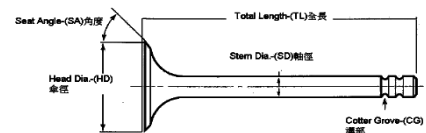

## Valve Seat

OEM NO.  
 IN  
 OEM NO.  
 EX

SIZE

STD

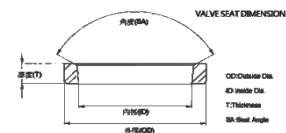

## Valve Guide

OEM NO.  
 IN  
 OEM NO.  
 EX

SIZE

STD

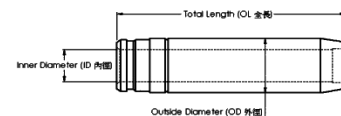

## Gasket Set

OEM NO.







# YANMATR

## 3/4TN78

**Application :**  
**Number of Cylinders 3/4**  
**Cylinder dia. 78.0 MM**  
**Swept Volume ccm**

### Piston kit-Set

OEM NO. 129100-22080



Piston	SIZE
Comp : 50.3 Height : -16.0 Length : 86.7 Top Shape : Ø42.0 Direct Injection Pin : 26.0 Length : 66.0	STD 0.50

### Piston Ring

OEM NO. 129590-22510

NPR :



OEM Ring Groove	SIZE
Top : 2.0 2nd : 2.0 Oil : 4.0	STD 0.50

### Cylinder Liner

OEM NO.

Liner&Sleeve

SIZE

In Diameter : 78.0 Out Diameter : 82.0 Total length : 146.0 Flange : 87.0*3.5+1	STD
--	-----



### Engine Bearing

MAIN : 719150-02800  
 CON.ROD : 729150-23600  
 T/W : 719620-02930  
 C/B :  
 BUSH :

SIZE

STD



### Engine Valve

OEM NO.  
 IN 35.0 8.0 109.0  
 OEM NO.  
 EX 30.0 8.0 109.0

SIZE

STD

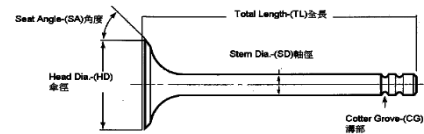

### Valve Seat

OEM NO.  
 IN  
 OEM NO.  
 EX

SIZE

STD

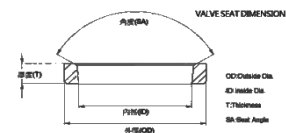

### Valve Guide

OEM NO.  
 IN 49.0 13.0 8.0  
 OEM NO.  
 EX 46.0 13.0 8.0

SIZE

STD

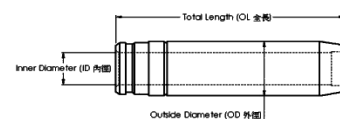

### Gasket Set

OEM NO.



# YANMATR 3/4TN78T

**Application :**  
**Number of Cylinders 3/4**  
**Cylinder dia. 78.0 MM**  
**Swept Volume ccm**

## Piston kit-Set

OEM NO.

Piston

SIZE

Comp : 48.4 Height : -14.0 Length : 84.9  
 Top Shape : Ø42.0  
 Direct Injection  
 Pin : 26.0 Length : 66.0

STD



## Piston Ring

OEM NO.

NPR :

OEM Ring Groove

SIZE

Top :  
 2nd :  
 Oil :

STD



## Cylinder Liner

OEM NO.

Liner&Sleeve

SIZE

In Diameter : 78.0  
 Out Diameter : 82.0  
 Total length : 146.0  
 Flange : 87.0\*3.5+1

STD



## Engine Bearing

MAIN : 719150-02800  
 CON.ROD : 729150-23600  
 T/W :  
 C/B :  
 BUSH :

SIZE

STD



## Engine Valve

OEM NO.  
 IN 35.0 8.0 109.0  
 OEM NO.  
 EX 30.0 8.0 109.0

SIZE

STD

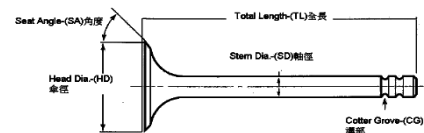

## Valve Seat

OEM NO.  
 IN  
 OEM NO.  
 EX

SIZE

STD

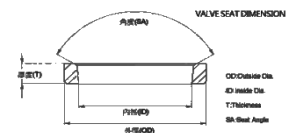

## Valve Guide

OEM NO.  
 IN 49.0 13.0 8.0  
 OEM NO.  
 EX 46.0 13.0 8.0

SIZE

STD

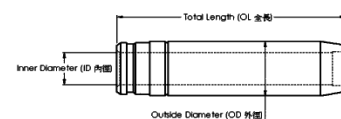

## Gasket Set

OEM NO.



# YANMATR

## 3/4TN82

**Application :**  
**Number of Cylinders 3/4**  
**Cylinder dia. 82.0 MM**  
**Swept Volume 1425 ccm(3cyl.)**

### Piston kit-Set

OEM NO.

Piston

SIZE

Comp : 50.4 Height : -16.0 Length : 86.5  
 Top Shape : Ø44.0  
 Direct Injection  
 Pin : 26.0 Length : 66.0

STD  
 0.60



### Piston Ring

OEM NO.

NPR :

OEM Ring Groove

SIZE

Top :  
 2nd :  
 Oil :

STD



### Cylinder Liner

OEM NO.

Liner&Sleeve

SIZE

In Diameter : 78.0  
 Out Diameter : 82.0  
 Total length : 146.0  
 Flange : 87.0\*3.5+1

STD



### Engine Bearing

MAIN : 719150-02800  
 CON.ROD : 729150-23600  
 T/W : 129150-02930  
 C/B :  
 BUSH :

SIZE

STD



### Engine Valve

OEM NO.

IN 35.0 8.0 109.0

OEM NO.

EX 30.0 8.0 109.0

SIZE

STD

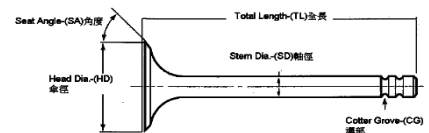

### Valve Seat

OEM NO.

IN

OEM NO.

EX

SIZE

STD

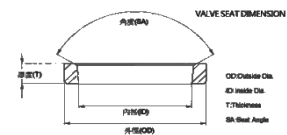

### Valve Guide

OEM NO.

IN 49.0 13.0 8.0

OEM NO.

EX 46.0 13.0 8.0

SIZE

STD

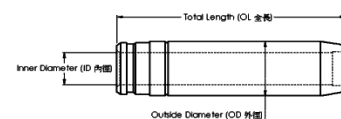

### Gasket Set

OEM NO.



# YANMATR 3/4TN84

**Application :**  
Number of Cylinders 3/4  
Cylinder dia. 84.0 MM  
Swept Volume ccm

## Piston kit-Set

OEM NO. 129105-22080



Piston	SIZE
Comp : 50.0 Height : -16.0 Length : 87.0 Top Shape : Ø45.5 Direct Injection Pin : 26.0 Length : 66.0	STD 0.50

## Piston Ring

OEM NO. 129105-22500

NPR :



OEM Ring Groove	SIZE
Top : 2.0 2nd : 2.0 Oil : 4.0	STD 0.50

## Cylinder Liner

OEM NO.



Liner&Sleeve	SIZE
In Diameter : Out Diameter : Total length : Flange :	STD

## Engine Bearing

MAIN : 719150-02800  
CON.ROD : 729150-23600  
T/W : 129150-02930  
C/B : 129795-02411  
BUSH : 729402-23100



	SIZE
	STD

## Engine Valve

OEM NO.  
IN 35.0 8.0 109.0  
OEM NO.  
EX 30.0 8.0 109.0

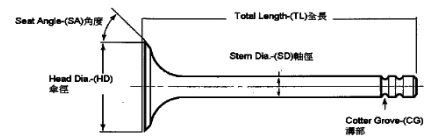

	SIZE
	STD

## Valve Seat

OEM NO.  
IN  
OEM NO.  
EX

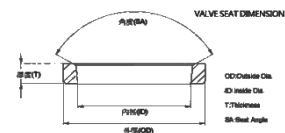

	SIZE
	STD

## Valve Guide

OEM NO.  
IN 49.0 13.0 8.0  
OEM NO.  
EX 46.0 13.0 8.0

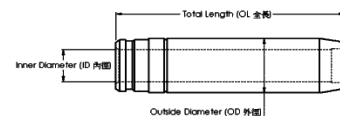

	SIZE
	STD

## Gasket Set

OEM NO.



# YANMATR

## 3/4TNC88

**Application :**  
**Number of Cylinders 3/4**  
**Cylinder dia. 88.0 MM**  
**Swept Volume 1642 / 2189 ccm(3/4cyl.)**

### Piston kit-Set

OEM NO. 129001-22081

Piston	SIZE
Comp : 47.7 Height : -18.0 Length : 84.0 Top Shape : Ø47.0 Direct Injection Pin : 26.0 Length : 70.0	STD 0.50



### Piston Ring

OEM NO. 129001-22500  
 NPR : SDY10-188AA

OEM Ring Groove	SIZE
Top : 2.0 2nd : 2.0 Oil : 4.0	STD 0.50



### Cylinder Liner

OEM NO.

Liner&Sleeve	SIZE
In Diameter : Out Diameter : Total length : Flange :	STD



### Engine Bearing

MAIN : 719150-02800  
 CON.ROD : 729150-23600  
 T/W : 129150-02930  
 C/B : 129795-02411  
 BUSH : 729402-23100

SIZE  
  
STD



### Engine Valve

OEM NO.  
 IN 35.0 8.0 109.0  
 OEM NO.  
 EX 30.0 8.0 109.0

SIZE  
  
STD

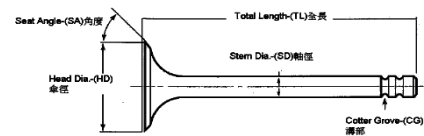

### Valve Seat

OEM NO.  
 IN  
 OEM NO.  
 EX

SIZE  
  
STD

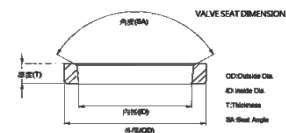

### Valve Guide

OEM NO.  
 IN 49.0 13.0 8.0  
 OEM NO.  
 EX 46.0 13.0 8.0

SIZE  
  
STD

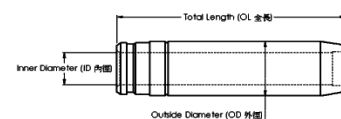

### Gasket Set

OEM NO.



# YANMATR 3T84

**Application :**  
Number of Cylinders 3  
Cylinder dia. 84.0 MM  
Swept Volume ccm

## Piston kit-Set

OEM NO.

Piston

SIZE

Comp : 43.0 Height : Length : 84.0

Top Shape :

Pin : 26.0

Length : 66.0

STD



## Piston Ring

OEM NO.

NPR :

OEM Ring Groove

SIZE

Top : 2.0

2nd : 2.0

Oil : 4.0

STD



## Cylinder Liner

OEM NO.

Liner&Sleeve

SIZE

In Diameter : 84.0

Out Diameter : 88.0

Total length : 147.0

Flange : 93.0\*5.0

STD



## Engine Bearing

MAIN : 129350-02100/02130/02330

CON.ROD : CR003169

T/W :

C/B :

BUSH :

SIZE

STD



## Engine Valve

OEM NO. 129322-11100

IN 37.0 8.0 100.0

OEM NO. 129322-11110

EX 31.0 8.0 100.0

SIZE

STD

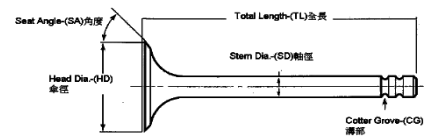

## Valve Seat

OEM NO.

IN

OEM NO.

EX

SIZE

STD

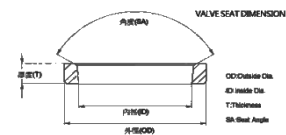

## Valve Guide

OEM NO.

IN 49.0 8.0 13.0

OEM NO.

EX

SIZE

STD

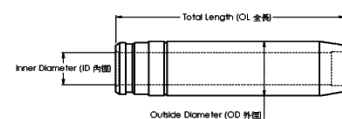

## Gasket Set

OEM NO.



# YANMATR

## 3TN72

**Application :**  
 Number of Cylinders 3  
 Cylinder dia. 72.0 MM  
 Swept Volume 878ccm

### Piston kit-Set

OEM NO.

Piston

SIZE

Comp : 38.0 Height : Length : 65.5

Top Shape :

Pin : 21.0

Length : 53.0

STD



### Piston Ring

OEM NO.

NPR :

OEM Ring Groove

SIZE

Top : 2.0K

2nd : 1.5

Oil : 4.0

STD



### Cylinder Liner

OEM NO.

Liner&Sleeve

SIZE

In Diameter :

Out Diameter :

Total length :

Flange :

STD



### Engine Bearing

MAIN : 719260-02800

CON.ROD : 719620-23600

T/W : 719620-02930

C/B :

BUSH :

SIZE

STD



### Engine Valve

OEM NO.

IN 29.5 7.0 87.2 45°

OEM NO.

EX 25.0 7.0 87.2 45°

SIZE

STD

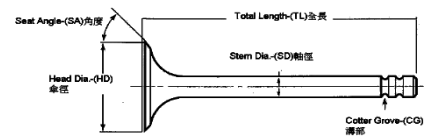

### Valve Seat

OEM NO.

IN

OEM NO.

EX

SIZE

STD

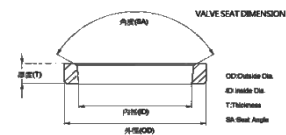

### Valve Guide

OEM NO. 119620-11801

IN/EX 35.0 12.0 7.0

SIZE

STD

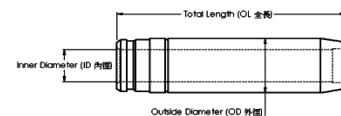

### Gasket Set

OEM NO.





# YANMATR

## 3TN100

**Application :**  
**Number of Cylinders 3**  
**Cylinder dia. 100.0 MM**  
**Swept Volume ccm**

### Piston kit-Set

OEM NO. 119000-22000



Piston

SIZE

Comp : 59.5 Height : -19.0 Length : 100.4  
 Top Shape : Ø57.0  
 Direct Injection  
 Pin : 34.0 Length : 83.0

STD

### Piston Ring

OEM NO. 119000-22500

NPR :



OEM Ring Groove

SIZE

Top : 1.5  
 2nd : 2.0  
 Oil : 3.0

STD

### Cylinder Liner

OEM NO.



Liner&Sleeve

SIZE

In Diameter :  
 Out Diameter :  
 Total length :  
 Flange :

STD

### Engine Bearing

MAIN : 119000-12800  
 CON.ROD : 119000-23300  
 T/W : 719000-02930  
 C/B :  
 BUSH :

SIZE



STD

### Engine Valve

OEM NO. EVYM-12-I  
 IN 43.5 9.0 121.0  
 OEM NO. EVYM-12-E  
 EX 37.5 8.0 121.0

SIZE

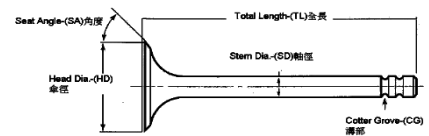

STD

### Valve Seat

OEM NO.  
 IN  
 OEM NO.  
 EX

SIZE

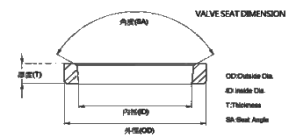

STD

### Valve Guide

OEM NO.  
 IN 50.5 13.5 9.0  
 OEM NO.  
 EX 51.5 13.5 9.0

SIZE

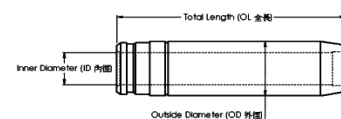

STD

### Gasket Set

OEM NO.



# YANMATR 3TNA66

**Application :**  
**Number of Cylinders 3**  
**Cylinder dia. 66.0 MM**  
**Swept Volume 658 ccm**

## Piston kit-Set

OEM NO. 119270-22010

Piston	SIZE
Comp : 33.0 Height : Length : 58.0 Top Shape : Flower Pin : 20.0 Length :	STD



## Piston Ring

OEM NO. 719270-22501

NPR :

OEM Ring Groove	SIZE
Top : 1.5 2nd : 1.5 Oil : 3.5	STD



## Cylinder Liner

OEM NO.

Liner&Sleeve	SIZE
In Diameter : Out Diameter : Total length : Flange :	STD



## Engine Bearing

MAIN : 119260-02800  
 CON.ROD : 719620-23600  
 T/W : 719620-02930  
 C/B :  
 BUSH :

SIZE  
STD



## Engine Valve

OEM NO. EVYM-02-I  
 IN 27.0 5.5 77.2 60°  
 OEM NO. EVYM-02-E  
 EX 23.0 5.5 76.7

SIZE  
STD

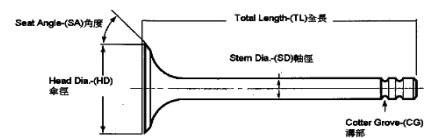

## Valve Seat

OEM NO.  
 IN  
 OEM NO.  
 EX

SIZE  
STD

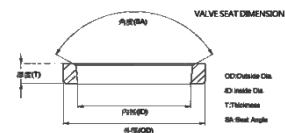

## Valve Guide

OEM NO. 119260-11800  
 IN/EX 30.0 5.5 10.0

SIZE  
STD

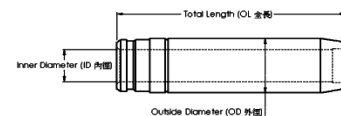

## Gasket Set

OEM NO.



# YANMATR 3TNA68

**Application :**  
**Number of Cylinders 3**  
**Cylinder dia. 68.0 MM**  
**Swept Volume 898 ccm**

## Piston kit-Set

OEM NO.

Piston

SIZE

Comp : 37.6 Height : -1.0 Length : 65.5  
 Top Shape : Flower  
 Pin : 21.0  
 Length : 56.0

STD



## Piston Ring

OEM NO. 119630-22502

NPR :

OEM Ring Groove

SIZE

Top : 1.5  
 2nd : 1.5  
 Oil : 3.5

STD



## Cylinder Liner

OEM NO.

Liner&Sleeve

SIZE

In Diameter :  
 Out Diameter :  
 Total length :  
 Flange :

STD



## Engine Bearing

MAIN : 719260-02800  
 CON.ROD : 719620-23600  
 T/W : 719620-02930  
 C/B :  
 BUSH :

SIZE

STD



## Engine Valve

OEM NO.

IN 29.6 7.0 87.2

OEM NO.

EX 25.0 7.0 87.2

SIZE

STD

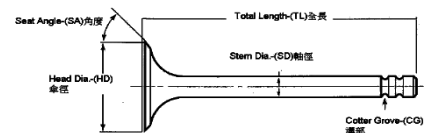

## Valve Seat

OEM NO.

IN

OEM NO.

EX

SIZE

STD

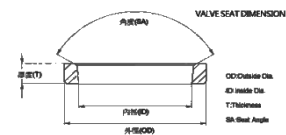

## Valve Guide

OEM NO. 119620-11801

IN/EX 35.0 12.0 7.0

SIZE

STD

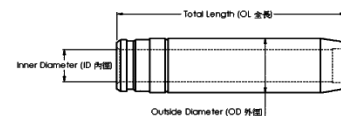

## Gasket Set

OEM NO.



# YANMATR

## 3TNA72

**Application :**  
**Number of Cylinders 3**  
**Cylinder dia. 72.0 MM**  
**Swept Volume ccm**

### Piston kit-Set

OEM NO.

Piston

SIZE

Comp : 38.0 Height : -1.0 Length : 65.5  
 Top Shape : Flower  
 Pin : 21.0  
 Length : 56.5

STD



### Piston Ring

OEM NO.

NPR :

OEM Ring Groove

SIZE

Top :  
 2nd :  
 Oil :

STD



### Cylinder Liner

OEM NO.

Liner&Sleeve

SIZE

In Diameter :  
 Out Diameter :  
 Total length :  
 Flange :

STD



### Engine Bearing

MAIN : 719260-02800  
 CON.ROD : 719620-23600  
 T/W : 719620-02930  
 C/B :  
 BUSH :

SIZE

STD



### Engine Valve

OEM NO. EVYM-01-I  
 IN 32.0 7.0 91.0  
 OEM NO. EVYM-01-E  
 EX 26.0 7.0 91.0

SIZE

STD

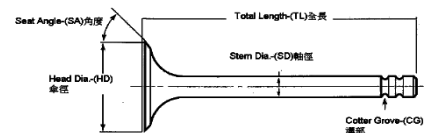

### Valve Seat

OEM NO.  
 IN  
 OEM NO.  
 EX

SIZE

STD

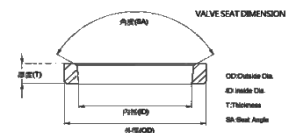

### Valve Guide

OEM NO.  
 IN  
 OEM NO.  
 EX

SIZE

STD

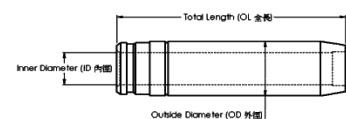

### Gasket Set

OEM NO.



# YANMATR 3TNE84

**Application :**  
**Number of Cylinders 3**  
**Cylinder dia. 84.0 MM**  
**Swept Volume ccm**

## Piston kit-Set

OEM NO. 129157-22090



Piston

SIZE

Comp : 49.2 Height : -16.0 Length : 85.7  
 Top Shape : Ø47.0  
 Direct Injection  
 Pin : 26.0 Length : 66.0

STD  
0.50

## Piston Ring

OEM NO.

NPR :



OEM Ring Groove

SIZE

Top :  
2nd :  
Oil :

STD

## Cylinder Liner

OEM NO.



Liner&Sleeve

SIZE

In Diameter :  
Out Diameter :  
Total length :  
Flange :

STD

## Engine Bearing

MAIN : 729150-02800  
 CON.ROD : 729150-23600  
 T/W : 129150-02930  
 C/B : 129795-02411  
 BUSH : 729402-23100

SIZE



STD

## Engine Valve

OEM NO. 129100-11100  
 IN 35.0 8.0 109.0 60/45°  
 OEM NO. 129100-11110/30  
 EX 30.0 8.0 109.0

SIZE

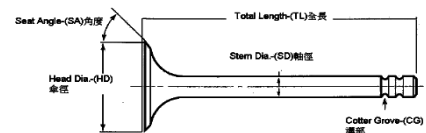

STD

## Valve Seat

OEM NO.  
IN  
OEM NO.  
EX

SIZE

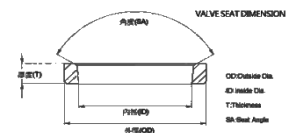

STD

## Valve Guide

OEM NO. 120130-11860  
 IN 46.0 13.0 8.0  
 OEM NO. 129150-11810  
 EX 49.0 13.0 8.0

SIZE

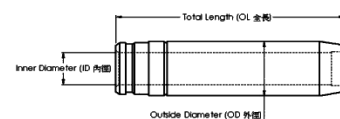

STD

## Gasket Set

OEM NO.



# YANMATR 3TNC78

**Application :**  
Number of Cylinders 3  
Cylinder dia. 78.0 MM  
Swept Volume ccm

## Piston kit-Set

OEM NO. 119811-22080



Piston

SIZE

Comp : 42.4 Height : -14.0 Length : 74.0  
Top Shape : Ø42.0  
Direct Injection  
Pin : 23.0 Length : 62.0

STD  
0.50

## Piston Ring

OEM NO.  
NPR :



OEM Ring Groove

SIZE

Top :  
2nd :  
Oil :

STD

## Cylinder Liner

OEM NO.



Liner&Sleeve

SIZE

In Diameter :  
Out Diameter :  
Total length :  
Flange :

STD

## Engine Bearing

MAIN :  
CON.ROD :  
T/W :  
C/B :  
BUSH :

SIZE



STD

## Engine Valve

OEM NO. 129100-11100  
IN 35.0 8.0 109.0 60/45°  
OEM NO. 129100-11110/30  
EX 30.0 8.0 109.0

SIZE

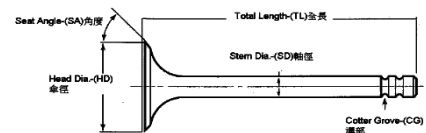

STD

## Valve Seat

OEM NO.  
IN  
OEM NO.  
EX

SIZE

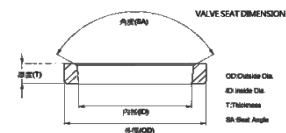

STD

## Valve Guide

OEM NO. 120130-11860  
IN 46.0 13.0 8.0  
OEM NO. 129150-11810  
EX 49.0 13.0 8.0

SIZE

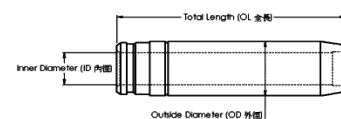

STD

## Gasket Set

OEM NO.



# YANMATR 3TNC80

**Application :**  
**Number of Cylinders 3**  
**Cylinder dia. 80.0 MM**  
**Swept Volume 1206 ccm**

## Piston kit-Set

OEM NO.

Piston

SIZE

Comp : 41.0 Height : -14.0 Length : 73.0  
 Top Shape : Ø43.5  
 Direct Injection  
 Pin : 23.0 Length : 65.0

STD  
0.50



## Piston Ring

OEM NO.

NPR :

OEM Ring Groove

SIZE

Top :  
2nd :  
Oil :

STD



## Cylinder Liner

OEM NO.

Liner&Sleeve

SIZE

In Diameter :  
Out Diameter :  
Total length :  
Flange :

STD



## Engine Bearing

MAIN :  
CON.ROD :  
T/W :  
C/B :  
BUSH :

SIZE

STD



## Engine Valve

OEM NO. EVYM-67-I  
IN 32.0 7.0 95.0  
OEM NO. EVYM-67-E  
EX 27.0 7.0 95.0

SIZE

STD

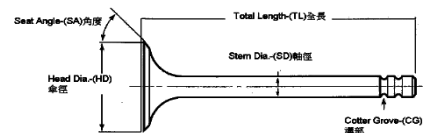

## Valve Seat

OEM NO.  
IN  
OEM NO.  
EX

SIZE

STD

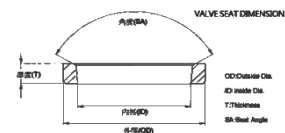

## Valve Guide

OEM NO.  
IN  
OEM NO.  
EX

SIZE

STD

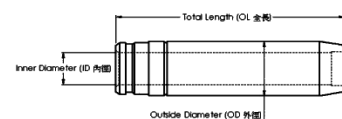

## Gasket Set

OEM NO.



# YANMATR 3TNE66

**Application :**  
**Number of Cylinders 3**  
**Cylinder dia. 66.0 MM**  
**Swept Volume ccm**

## Piston kit-Set

OEM NO. 719209-22080

Piston	SIZE
Comp : 28.1 Height : Length : 58.0 Top Shape : Flower Pin : 20.0 Length :	STD

## Piston Ring

OEM NO.  
NPR :

OEM Ring Groove	SIZE
Top : 1.5 2nd : 1.5 Oil : 3.5	STD



## Cylinder Liner

OEM NO.

Liner&Sleeve	SIZE
In Diameter : Out Diameter : Total length : Flange :	STD



## Engine Bearing

MAIN : 119260-02800  
CON.ROD : 719620-23600  
T/W : 119260-02930  
C/B :  
BUSH :

SIZE  
STD



## Engine Valve

OEM NO.  
IN  
OEM NO.  
EX

SIZE  
STD

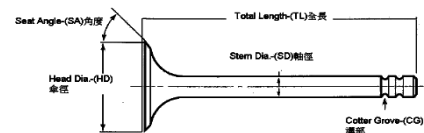

## Valve Seat

OEM NO.  
IN  
OEM NO.  
EX

SIZE  
STD

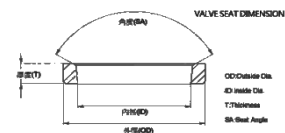

## Valve Guide

OEM NO.  
IN  
OEM NO.  
EX

SIZE  
STD

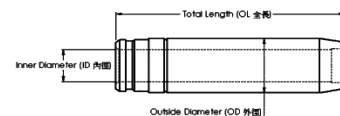

## Gasket Set

OEM NO.





# YANMATR

## 3TNE68

**Application :**  
**Number of Cylinders 3**  
**Cylinder dia. 66.0 MM**  
**Swept Volume 784 ccm**

### Piston kit-Set

OEM NO.

Piston

SIZE

Comp : 38.0 Height : -1.0 Length : 53.4  
 Top Shape : Flower  
 Pin : 20.0  
 Length : 55.0

STD



### Piston Ring

OEM NO. 119265-22500

NPR :

OEM Ring Groove

SIZE

Top : 1.5K  
 2nd : 1.5  
 Oil : 3.0

STD



### Cylinder Liner

OEM NO.

Liner&Sleeve

SIZE

In Diameter :  
 Out Diameter :  
 Total length :  
 Flange :

STD



### Engine Bearing

MAIN : 159261-23931-8  
 CON.ROD : 15694-22971  
 T/W :  
 C/B :  
 BUSH :

SIZE

STD



### Engine Valve

OEM NO. EVYM-02-I  
 IN 27.0 5.5 77.2 60°  
 OEM NO. EVYM-02-E  
 EX 23.0 5.5 76.7

SIZE

STD

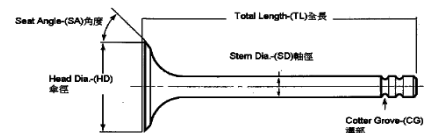

### Valve Seat

OEM NO.  
 IN  
 OEM NO.  
 EX

SIZE

STD

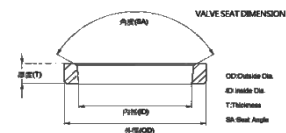

### Valve Guide

OEM NO. 119260-11800  
 IN/EX 30.0 5.5 10.0

SIZE

STD

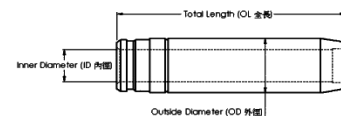

### Gasket Set

OEM NO.



# YANMATR 3TNE82A

**Application :**  
**Number of Cylinders 3**  
**Cylinder dia. 82.0 MM**  
**Swept Volume 1330 ccm**

## Piston kit-Set

OEM NO. 119813-22080



Piston

SIZE

Comp : 39.0 Height : -15.5 Length : 71.0  
 Top Shape : Ø44.0  
 Direct Injection  
 Pin : 23.0 Length : 65.0

STD

## Piston Ring

OEM NO. 119813-22500

NPR :



OEM Ring Groove

SIZE

Top : 2.0  
 2nd : 2.0  
 Oil : 4.0

STD

## Cylinder Liner

OEM NO.



Liner&Sleeve

SIZE

In Diameter :  
 Out Diameter :  
 Total length :  
 Flange :

STD

## Engine Bearing

MAIN :  
 CON.ROD :  
 T/W :  
 C/B :  
 BUSH :

SIZE



STD

## Engine Valve

OEM NO.  
 IN  
 OEM NO.  
 EX

SIZE

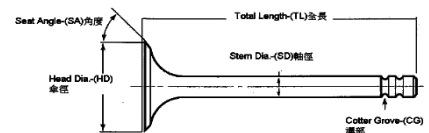

STD

## Valve Seat

OEM NO.  
 IN  
 OEM NO.  
 EX

SIZE

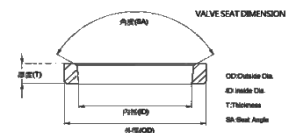

STD

## Valve Guide

OEM NO.  
 IN  
 OEM NO.  
 EX

SIZE

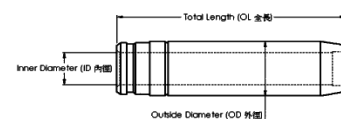

STD

## Gasket Set

OEM NO.



# YANMATR 3TNE84

**Application :**  
**Number of Cylinders 3**  
**Cylinder dia. 84.0 MM**  
**Swept Volume 1496 ccm**

## Piston kit-Set

OEM NO. 129157-22090

Piston	SIZE
Comp : 47.0 w/al-fin Height : -17.0 Length : 84.0 Top Shape : Ø45.0 Direct Injection Pin : 26.0 Length : 69.5	STD



## Piston Ring

OEM NO. 119813-22500

NPR :

OEM Ring Groove	SIZE
Top : 2.0 2nd : 2.0 Oil : 4.0	STD



## Cylinder Liner

OEM NO.

Liner&Sleeve	SIZE
In Diameter : Out Diameter : Total length : Flange :	STD



## Engine Bearing

	SIZE
MAIN : 129150-02800 CON.ROD : 129150-23600 T/W : 139150-02930 C/B : 129795-02411 BUSH : 729402-23100	STD



## Engine Valve

	SIZE
OEM NO. 129100-11100 IN 35.0 8.0 109.0 60/45° OEM NO. 129100-11110/30 EX 30.0 8.0 109.0	STD

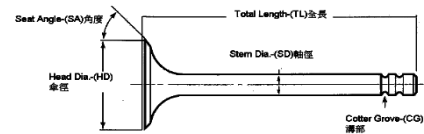

## Valve Seat

	SIZE
OEM NO. 120130-11860 IN 46.0 13.0 8.0 OEM NO. 129150-11810 EX 49.0 13.0 8.0	STD

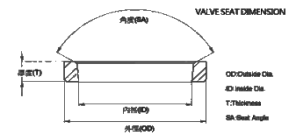

## Valve Guide

	SIZE
OEM NO. 129150-11810 IN 49.0 13.0 8.0 OEM NO. 129150-11810 EX 49.0 13.0 8.0	STD

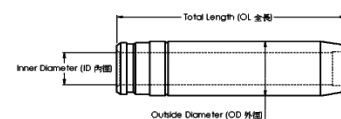

## Gasket Set

OEM NO.



# YANMATR 3TNV70-PSJ

**Application :**  
**Number of Cylinders 3**  
**Cylinder dia. 70.0 MM**  
**Swept Volume 854 ccm**

## Piston kit-Set

OEM NO. 119515-22080



Piston

SIZE

Comp : 34.0 Height : -2.0 Length : 62.0 MOS2  
 Top Shape : Flower  
 Pin : 22.0  
 Length : 52.5

STD

## Piston Ring

OEM NO. 119515-2250

NPR :



OEM Ring Groove

SIZE

Top : 1.5HK  
 2nd : 1.5  
 Oil : 3.0

STD

## Cylinder Liner

OEM NO.



Liner&Sleeve

SIZE

In Diameter :  
 Out Diameter :  
 Total length :  
 Flange :

STD

## Engine Bearing

MAIN : 119717-02900  
 CON.ROD : 119515-23601  
 T/W : 119717-02930  
 C/B :  
 BUSH :



SIZE

STD

## Engine Valve

OEM NO. 119515-11101  
 IN 29.6 6.0 82.5  
 OEM NO. 119515-11110  
 EX 24.6 6.0 82.5

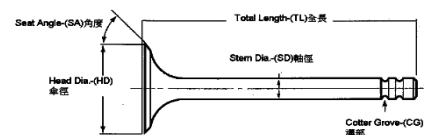

SIZE

STD

## Valve Seat

OEM NO.  
 IN  
 OEM NO.  
 EX

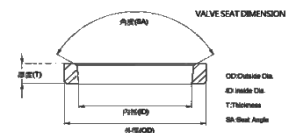

SIZE

STD

## Valve Guide

OEM NO. VGYM-53-Z  
 IN/EX 32.0 10.0 6.0

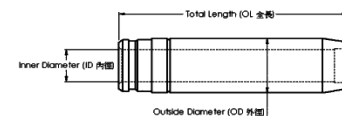

SIZE

STD

## Gasket Set

OEM NO.



# YANMATR 3TNV76

**Application :**  
**Number of Cylinders 3**  
**Cylinder dia. 76.0 MM**  
**Swept Volume 1116 ccm**

## Piston kit-Set

OEM NO. 119717-22080



Piston	SIZE
Comp : 36.5 Height : -2.6 Length : 68.5 MOS2 Top Shape : Flower Pin : 22.0 Length : 58.5	STD

## Piston Ring

OEM NO. 119717-22500

NPR :



OEM Ring Groove	SIZE
Top : 1.5HK 2nd : 2.0 Oil : 3.0	STD 0.50

## Cylinder Liner

OEM NO.



Liner&Sleeve	SIZE
In Diameter : Out Diameter : Total length : Flange :	STD

## Engine Bearing

MAIN : 719717-02900  
 CON.ROD : 119717-23600  
 T/W : 119717-02930  
 C/B :  
 BUSH :



	SIZE
	STD

## Engine Valve

OEM NO.  
 IN  
 OEM NO.  
 EX

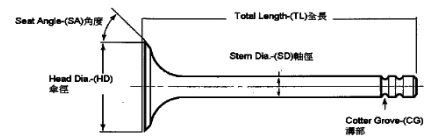

	SIZE
	STD

## Valve Seat

OEM NO.  
 IN  
 OEM NO.  
 EX

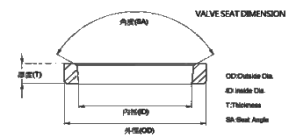

	SIZE
	STD

## Valve Guide

OEM NO.  
 IN 35.0 10.0 6.0  
 OEM NO.  
 EX 35.0 10.0 6.0

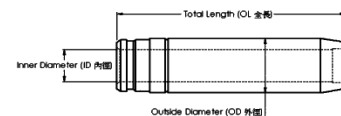

	SIZE
	STD

## Gasket Set

OEM NO.



# YANMATR 3TNV82A

**Application :**  
**Number of Cylinders 3**  
**Cylinder dia. 82.0 MM**  
**Swept Volume ccm**

## Piston kit-Set

OEM NO.

Piston

SIZE

Comp : 39.2 Height : -14.7 Length : 71.1  
 Top Shape : Ø39.75  
 Direct Injection  
 Pin : 23.0 Length : 65.0

STD  
0.50

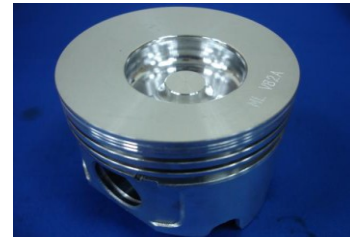

## Piston Ring

OEM NO.

NPR :

OEM Ring Groove

SIZE

Top : 2.0  
 2nd : 2.0  
 Oil : 3.0

STD  
0.50



## Cylinder Liner

OEM NO.

Liner&Sleeve

SIZE

In Diameter :  
 Out Diameter :  
 Total length :  
 Flange :

STD



## Engine Bearing

MAIN :  
 CON.ROD :  
 T/W :  
 C/B :  
 BUSH :

SIZE

STD



## Engine Valve

OEM NO.  
 IN  
 OEM NO.  
 EX

SIZE

STD

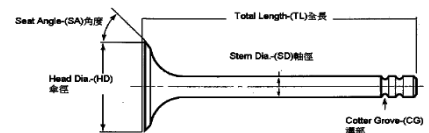

## Valve Seat

OEM NO.  
 IN  
 OEM NO.  
 EX

SIZE

STD

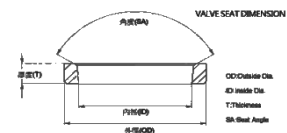

## Valve Guide

OEM NO.  
 IN  
 OEM NO.  
 EX

SIZE

STD

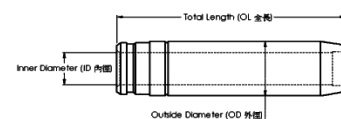

## Gasket Set

OEM NO.



# YANMATR

## 4TN100

**Application :**  
**Number of Cylinders 4**  
**Cylinder dia. 100.0 MM**  
**Swept Volume ccm**

### Piston kit-Set

OEM NO.

Piston

SIZE

Comp : 59.5 Height : -19.0 Length : 100.4  
 Top Shape : Ø57.0  
 Direct Injection  
 Pin : 34.0 Length : 83.0

STD



### Piston Ring

OEM NO. 119000-22500

NPR :

OEM Ring Groove

SIZE

Top : 1.5  
 2nd : 2.0  
 Oil : 3.0

STD



### Cylinder Liner

OEM NO.

Liner&Sleeve

SIZE

In Diameter :  
 Out Diameter :  
 Total length :  
 Flange :

STD



### Engine Bearing

MAIN : 119000-12800  
 CON.ROD : 119000-23300  
 T/W : 119000-02930  
 C/B :  
 BUSH :

SIZE

STD



### Engine Valve

OEM NO. EVYM-12-I  
 IN 43.5 9.0 121.0  
 OEM NO. EVYM-12-E  
 EX 37.5 8.0 121.0

SIZE

STD

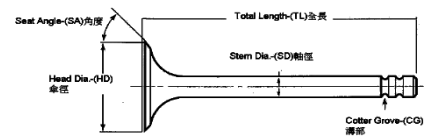

### Valve Seat

OEM NO.  
 IN  
 OEM NO.  
 EX

SIZE

STD

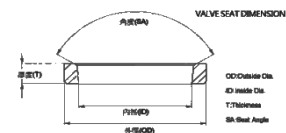

### Valve Guide

OEM NO.  
 IN 50.5 13.5 9.0  
 OEM NO.  
 EX 51.5 13.5 9.0

SIZE

STD

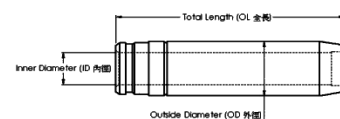

### Gasket Set

OEM NO.



# YANMATR 4TNE92(4D92E)

**Application :**  
**Number of Cylinders 4**  
**Cylinder dia. 92.0 MM**  
**Swept Volume ccm**

## Piston kit-Set

OEM NO. 129904-22120

Piston	SIZE
Comp : 59.7 w/al-fin Height : -2.0 Length : 103.75 Top Shape : Flower Pin : 30.0 Length : 73.0	STD 0.50



## Piston Ring

OEM NO. 129004-22050

NPR :

OEM Ring Groove	SIZE
Top : 2.0K 2nd : 2.0 Oil : 3.0	STD 0.50



## Cylinder Liner

OEM NO.

Liner&Sleeve	SIZE
In Diameter : Out Diameter : Total length : Flange :	STD



## Engine Bearing

MAIN : 129900-02800  
 CON.ROD : 129900-23600  
 T/W : 129900-02930  
 C/B : 129900-02410  
 BUSH : P412H

SIZE  
  
STD



## Engine Valve

OEM NO. 129900-11100  
 IN 41.0 8.0 115.0  
 OEM NO. 129900-11110  
 EX 35.0 8.0 115.0

SIZE  
  
STD

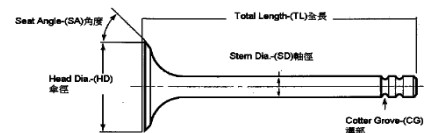

## Valve Seat

OEM NO. 129901-11080  
 IN 43.0 37.0 6.0  
 OEM NO. 129901-11090  
 EX 37.0 31.0 6.0

SIZE  
  
STD

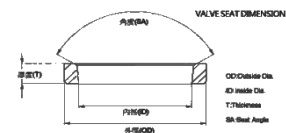

## Valve Guide

OEM NO. 129150-11810  
 IN/EX 45.9 13.0 8.0

SIZE  
  
STD

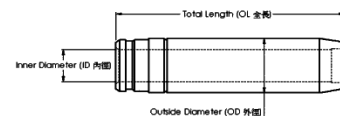

## Gasket Set

OEM NO.





# YANMATR 4TNE94

**Application :**  
Number of Cylinders 4  
Cylinder dia. 94.0 MM  
Swept Volume 3053 ccm

## Piston kit-Set

OEM NO. 6142-31-2113 (KOMATSU NO)

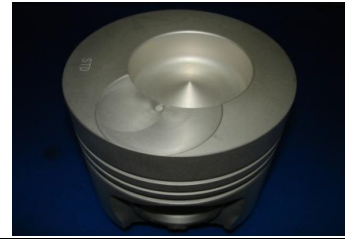

Piston	SIZE
Comp : 55.5 Height : -18.0 Length : 98.15 Top Shape : Ø49.6 Pin : 30.0 Length : 70.0	STD 0.50

## Piston Ring

OEM NO.  
NPR :



OEM Ring Groove	SIZE
Top : 2.9 2nd : 2.5 Oil : 5.0	STD

## Cylinder Liner

OEM NO.



Liner&Sleeve	SIZE
In Diameter : Out Diameter : Total length : Flange :	STD

## Engine Bearing

MAIN :  
CON.ROD :  
T/W :  
C/B :  
BUSH :



	SIZE
	STD

## Engine Valve

OEM NO. 129900-11100  
IN 41.0 8.0 115.0  
OEM NO. 129900-11110  
EX 35.0 8.0 115.0

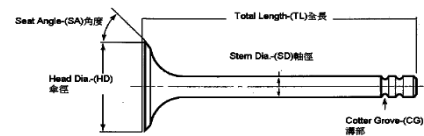

	SIZE
	STD

## Valve Seat

OEM NO. 129901-11080  
IN 43.0 37.0 6.0  
OEM NO. 129901-11090  
EX 37.0 31.0 6.0

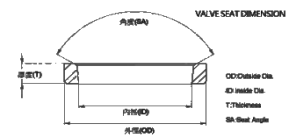

	SIZE
	STD

## Valve Guide

OEM NO. 129150-11810  
IN/EX 45.9 13.0 8.0

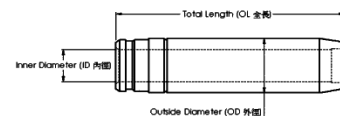

	SIZE
	STD

## Gasket Set

OEM NO.



# YANMATR 4TNE94(4D94E)

Application : Komatsu model 12  
Number of Cylinders 4  
Cylinder dia. 94.0 MM  
Swept Volume 2775 ccm

## Piston kit-Set

OEM NO. 129901-22080



Piston	SIZE
Comp : 59.8 Height : -1.7 Length : 104.0 Top Shape : Flower Pin : 30.0 Length : 73.0	STD 0.50

## Piston Ring

OEM NO. 127610-33612

NPR :



OEM Ring Groove	SIZE
Top : 2.0K 2nd : 2.0 Oil : 3.0	STD 0.50

## Cylinder Liner

OEM NO.



Liner&Sleeve	SIZE
In Diameter : Out Diameter : Total length : Flange :	STD

## Engine Bearing

MAIN : 129900-02800  
CON.ROD : 129900-23600  
T/W : 129900-02930  
C/B : 129900-02410  
BUSH : P412H



	SIZE
	STD

## Engine Valve

OEM NO. 129900-11100  
IN 41.0 8.0 115.0  
OEM NO. 129900-11110  
EX 35.0 8.0 115.0

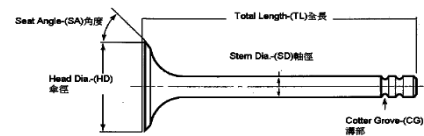

	SIZE
	STD

## Valve Seat

OEM NO. 129901-11080  
IN 43.0 37.0 6.0  
OEM NO. 129901-11090  
EX 37.0 31.0 6.0

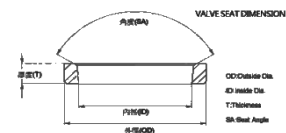

	SIZE
	STD

## Valve Guide

OEM NO. 129150-11810  
IN/EX 45.9 13.0 8.0

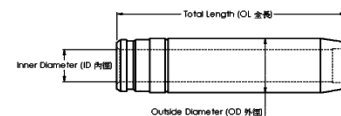

	SIZE
	STD

## Gasket Set

OEM NO.



# YANMATR 4TNE94(4D94LE)

**Application :**  
Number of Cylinders 4  
Cylinder dia. 94.0 MM  
Swept Volume ccm

## Piston kit-Set

OEM NO. 129931-22100

Piston	SIZE
Comp : 55.5 w/al-fin Height : -1.5 Length : 99.5 Top Shape : Flower Pin : 30.0 Length : 73.0	STD 0.50



## Piston Ring

OEM NO. 127610-33612

NPR :

OEM Ring Groove	SIZE
Top : 2.0K 2nd : 2.0 Oil : 3.0	STD 0.50



## Cylinder Liner

OEM NO.

Liner&Sleeve	SIZE
In Diameter : Out Diameter : Total length : Flange :	STD



## Engine Bearing

MAIN : 129900-02800  
CON.ROD : 129900-23600  
T/W : 129900-02930  
C/B : 129900-02410  
BUSH : P412H

SIZE

STD



## Engine Valve

OEM NO. 129900-11100  
IN 41.0 8.0 115.0  
OEM NO. 129900-11110  
EX 35.0 8.0 115.0

SIZE

STD

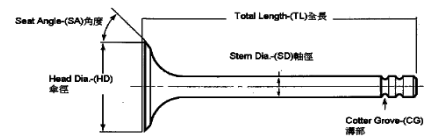

## Valve Seat

OEM NO. 129901-11080  
IN 43.0 37.0 6.0  
OEM NO. 129901-11090  
EX 37.0 31.0 6.0

SIZE

STD

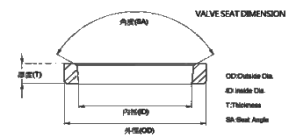

## Valve Guide

OEM NO. 129150-11810  
IN/EX 45.9 13.0 8.0

SIZE

STD

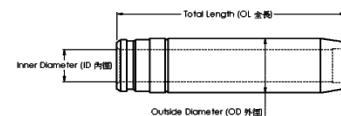

## Gasket Set

OEM NO.



# YANMATR

## 4TNE94E(4D94E)

**Application :**  
**Number of Cylinders 4**  
**Cylinder dia. 94.0 MM**  
**Swept Volume 3053 ccm**

### Piston kit-Set

OEM NO. 129900-22080

Piston	SIZE
Comp : 59.8 Height : -19.0 Length : 103.7 Top Shape : Ø50.8 Direct Injection Pin : 30.0 Length : 72.5	STD 0.50

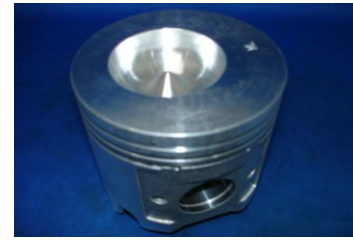

### Piston Ring

OEM NO. 127610-33612

NPR :

OEM Ring Groove	SIZE
Top : 2.0K 2nd : 2.0 Oil : 3.0	STD 0.50



### Cylinder Liner

OEM NO.

Liner&Sleeve	SIZE
In Diameter : Out Diameter : Total length : Flange :	STD



### Engine Bearing

MAIN : 129900-02800  
 CON.ROD : 129900-23600  
 T/W : 129900-02930  
 C/B : 129900-02410  
 BUSH : P412H

SIZE

STD



### Engine Valve

OEM NO. 129900-11100  
 IN 41.0 8.0 115.0  
 OEM NO. 129900-11110  
 EX 35.0 8.0 115.0

SIZE

STD

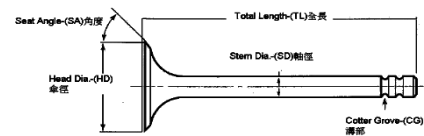

### Valve Seat

OEM NO. 129901-11080  
 IN 43.0 37.0 6.0  
 OEM NO. 129901-11090  
 EX 37.0 31.0 6.0

SIZE

STD

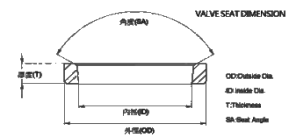

### Valve Guide

OEM NO. 129150-11810  
 IN/EX 45.9 13.0 8.0

SIZE

STD

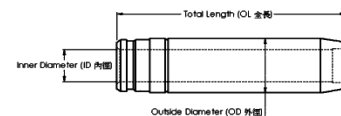

### Gasket Set

OEM NO.



# YANMATR 4TNE98(4D98E)

Application : Komatsu model 13  
Number of Cylinders 4  
Cylinder dia. 98.0 MM  
Swept Volume 3318 ccm

## Piston kit-Set

OEM NO. 129903-22081

Piston	SIZE
Comp : 55.6 Height : -4.2 Length : 99.3 Top Shape : Flower Pin : 30.0 Length : 72.0	STD 0.50

## Piston Ring

OEM NO. 129903-22050

NPR :

OEM Ring Groove	SIZE
Top : 2.0K 2nd : 2.0 Oil : 3.0	STD



## Cylinder Liner

OEM NO.

Liner&Sleeve	SIZE
In Diameter : Out Diameter : Total length : Flange :	STD



## Engine Bearing

MAIN : 129900-02800  
CON.ROD : 129900-23600  
T/W : 129900-02930  
C/B :  
BUSH :

SIZE  
STD



## Engine Valve

OEM NO. 129900-11100  
IN 41.0 8.0 115.0  
OEM NO. 129900-11110  
EX 35.0 8.0 115.0

SIZE  
STD

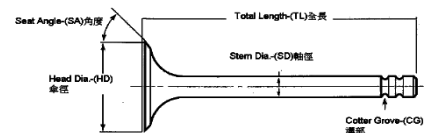

## Valve Seat

OEM NO. 129901-11080  
IN 43.0 37.0 6.0  
OEM NO. 129901-11090  
EX 37.0 31.0 6.0

SIZE  
STD

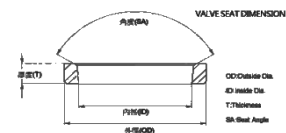

## Valve Guide

OEM NO. 129150-11810  
IN/EX 45.9 13.0 8.0

SIZE  
STD

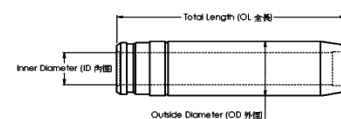

## Gasket Set

OEM NO.



# YANMATR

## 4TNE98-DI(4D98E)

Application : Komatsu model 13  
Number of Cylinders 4  
Cylinder dia. 98.0 MM  
Swept Volume 3318 ccm

### Piston kit-Set

OEM NO.

Piston

SIZE

Comp : 54.8 Height : -20.0 Length : 98.6  
Top Shape : Ø53.3  
Direct Injection  
Pin : 30.0 Length : 72.0

STD  
0.50

### Piston Ring

OEM NO. 129903-22050  
NPR :

OEM Ring Groove

SIZE

Top : 2.0K  
2nd : 2.0  
Oil : 3.0

STD  
0.50



### Cylinder Liner

OEM NO.

Liner&Sleeve

SIZE

In Diameter :  
Out Diameter :  
Total length :  
Flange :

STD



### Engine Bearing

MAIN : 129900-02800  
CON.ROD : 129900-23600  
T/W : 129900-02930  
C/B :  
BUSH :

SIZE

STD



### Engine Valve

OEM NO. 129900-11100  
IN 41.0 8.0 115.0  
OEM NO. 129900-11110  
EX 35.0 8.0 115.0

SIZE

STD

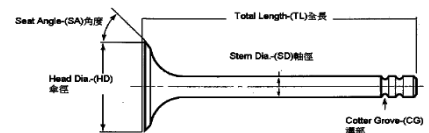

### Valve Seat

OEM NO. 129901-11080  
IN 43.0 37.0 6.0  
OEM NO. 129901-11090  
EX 37.0 31.0 6.0

SIZE

STD

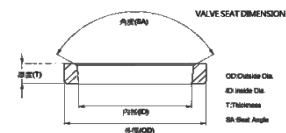

### Valve Guide

OEM NO. 129150-11810  
IN/EX 45.9 13.0 8.0

SIZE

STD

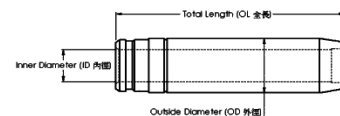

### Gasket Set

OEM NO.



# YANMATR 4TNV94

**Application :**  
**Number of Cylinders 4**  
**Cylinder dia. 94.0 MM**  
**Swept Volume 3053 ccm**

## Piston kit-Set

OEM NO. 129906-22080

Piston	SIZE
Comp : 55.0 w/al-fin Height : -17.2 Length : 99.0 Top Shape : Ø48.0 Direct Injection Pin : 30.0 Length : 74.4	STD 0.50

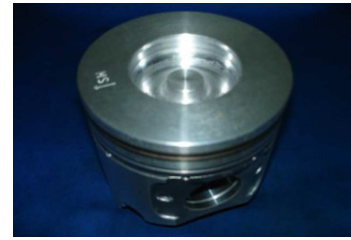

## Piston Ring

OEM NO. 127610-33612

NPR :

OEM Ring Groove	SIZE
Top : 2.0K 2nd : 2.0 Oil : 3.0	STD 0.50



## Cylinder Liner

OEM NO.

Liner&Sleeve	SIZE
In Diameter : Out Diameter : Total length : Flange :	STD



## Engine Bearing

MAIN : 129900-02800  
 CON.ROD : 129900-23600  
 T/W : 129900-02930  
 C/B : 129900-02410  
 BUSH :

SIZE  
  
STD



## Engine Valve

OEM NO. 129907-11100  
 IN 33.0 7.0 102.7  
 OEM NO. 129907-11110  
 EX 28.0 7.0 102.7

SIZE  
  
STD

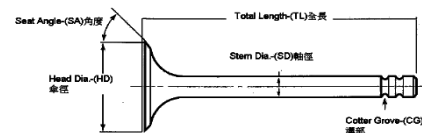

## Valve Seat

OEM NO.  
 IN  
 OEM NO.  
 EX

SIZE  
  
STD

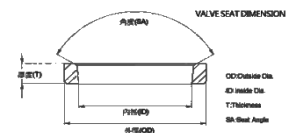

## Valve Guide

OEM NO. 129907-11800  
 IN 43.0 7.0 12.0

SIZE  
  
STD

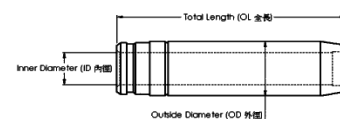

## Gasket Set

OEM NO.



# YANMATR 4TNV98TNLANG

**Application :**  
Number of Cylinders 4  
Cylinder dia. 98.0 MM  
Swept Volume ccm

## Piston kit-Set

OEM NO. 129908-22080

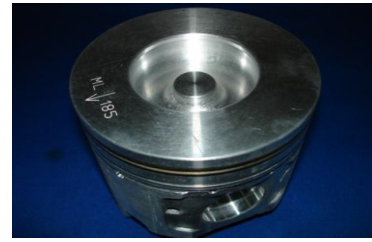

Piston	SIZE
Comp : 55.0 w/al-fin Height : -20.0 Length : 98.9 MOS2 Top Shape : Ø50.0 Direct Injection Pin : 30.0 Length : 72.0	STD 0.50

## Piston Ring

OEM NO. 129903-22050

NPR :



OEM Ring Groove	SIZE
Top : 2.0HK 2nd : 2.0 Oil : 3.0	STD 0.50

## Cylinder Liner

OEM NO.



Liner&Sleeve	SIZE
In Diameter : Out Diameter : Total length : Flange :	STD

## Engine Bearing

MAIN : 129900-02800  
CON.ROD : 129900-23600  
T/W : 129900-02930  
C/B :  
BUSH :



	SIZE
	STD

## Engine Valve

OEM NO. 129907-11100  
IN 33.0 7.0 102.7  
OEM NO. 129907-11110  
EX 28.0 7.0 102.7

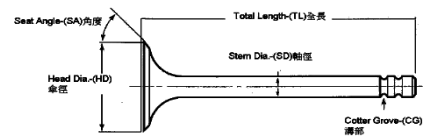

	SIZE
	STD

## Valve Seat

OEM NO.  
IN  
OEM NO.  
EX

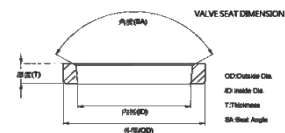

	SIZE
	STD

## Valve Guide

OEM NO. 129907-11800  
IN 43.0 7.0 12.0

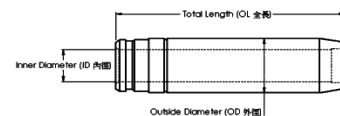

	SIZE
	STD

## Gasket Set

OEM NO.





# YANMATR 4TNV106T

**Application :**  
**Number of Cylinders 4**  
**Cylinder dia. 106.0 MM**  
**Swept Volume ccm**

## Piston kit-Set

OEM NO.

Piston

SIZE

Comp : 61.3 w/al-fin Height : -19.4 Length : 111.2  
 Top Shape : Ø60.5  
 Direct Injection  
 Pin : 37.0 Length : 83.5

STD  
0.50



## Piston Ring

OEM NO.

NPR :

OEM Ring Groove

SIZE

Top : 2.5K  
 2nd : 2.0  
 Oil : 3.0

STD



## Cylinder Liner

OEM NO.

Liner&Sleeve

SIZE

In Diameter :  
 Out Diameter :  
 Total length :  
 Flange :

STD



## Engine Bearing

MAIN :  
 CON.ROD :  
 T/W :  
 C/B :  
 BUSH :

SIZE

STD



## Engine Valve

OEM NO. 123907-11100  
 IN 36.5 7.0 117.6  
 OEM NO. 123907-11110  
 EX 31.0 7.0 117.5

SIZE

STD

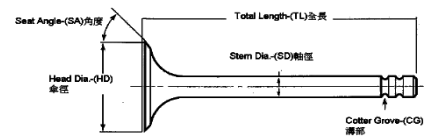

## Valve Seat

OEM NO.  
 IN  
 OEM NO.  
 EX

SIZE

STD

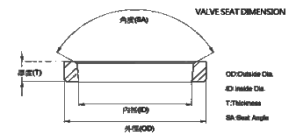

## Valve Guide

OEM NO.  
 IN  
 OEM NO.  
 EX

SIZE

STD

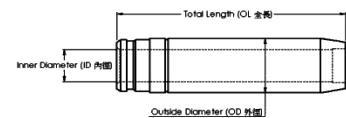

## Gasket Set

OEM NO.



# YANMATR 6CH105-DTF

**Application :**  
Number of Cylinders 6  
Cylinder dia. 105.0 MM  
Swept Volume ccm

## Piston kit-Set

OEM NO. 127616-22721

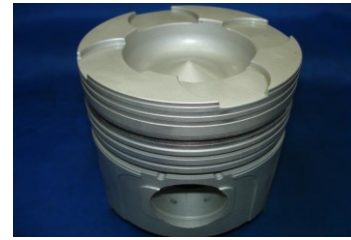

Piston

SIZE

Comp : 69.5 w/al-fin Height : -20.7 oil-cooled Length : 119.5  
Top Shape : Ø62.5  
Direct Injection  
Pin : 38.0 Length : 88.0

STD

## Piston Ring

OEM NO. 127610-22501

NPR :



OEM Ring Groove

SIZE

Top : 3.0  
2nd : 2.5  
3rd : 2.5  
Oil : 5.0

STD

## Cylinder Liner

OEM NO. 127418-01900

Liner&Sleeve

SIZE

In Diameter : 105.0  
Out Diameter : 120.0  
Total length : 230.0  
Flange : 128.0\*10.0+1.0

STD



## Engine Bearing

MAIN :  
CON.ROD :  
T/W :  
C/B :  
BUSH :

SIZE

STD



## Engine Valve

OEM NO. 127616-11100  
IN 35.0 8.0 131.2  
OEM NO. 127616-11110  
EX 35.0 8.0 131.0

SIZE

STD

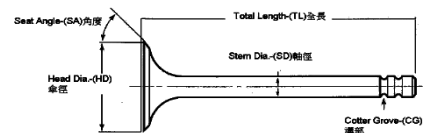

## Valve Seat

OEM NO. 127616-11808  
IN 37.0 29.9 6.5  
OEM NO. 127616-11090  
EX 37.0 29.9 6.5

SIZE

STD

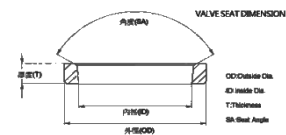

## Valve Guide

OEM NO. 127616-11160  
IN 55.0 13.0 8.0  
OEM NO. 127616-11170  
EX 52.0 13.0 8.0

SIZE

STD

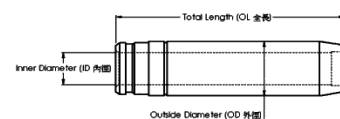

## Gasket Set

OEM NO.



# YANMATR 6CH105

**Application :**  
Number of Cylinders 6  
Cylinder dia. 105.0 MM  
Swept Volume ccm

## Piston kit-Set

OEM NO. 727620-22725

Piston	SIZE
Comp : 69.8 w/al-fin Height : -25.2 Length : 120.0 Top Shape : Ø58.8 Direct Injection Pin : 36.0 Length : 89.0	STD

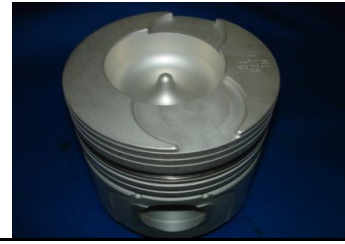

## Piston Ring

OEM NO. 127610-22501

NPR :

OEM Ring Groove	SIZE
Top : 3.0 2nd : 2.5 3rd : 2.5 Oil : 5.0	STD



## Cylinder Liner

OEM NO. 727418-01900

Liner&Sleeve	SIZE
In Diameter : 105.0 Out Diameter : 120.0 Total length : 230.0 Flange : 128.0*10.0+1.0	STD



## Engine Bearing

MAIN :	SIZE
CON.ROD :	STD
T/W :	
C/B :	
BUSH :	



## Engine Valve

OEM NO. 127610-11100	SIZE
IN 47.0 10.0 135.1 OEM NO. 127610-11110 EX 39.0 10.0 135.1	STD

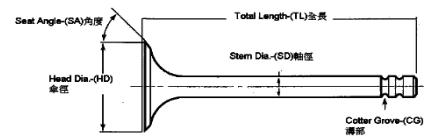

## Valve Seat

OEM NO. 127610-11080	SIZE
IN OEM NO. 127610-11090 EX	STD

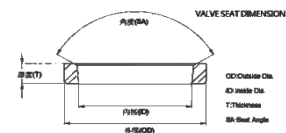

## Valve Guide

OEM NO. 127610-11150	SIZE
IN 54.0 17.0 10.0 OEM NO. 127610-11160 EX 57.0 17.0 10.0	STD

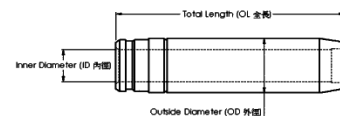

## Gasket Set

OEM NO.



# YANMATR 6T112

**Application :**  
**Number of Cylinders 6**  
**Cylinder dia. 112.0 MM**  
**Swept Volume ccm**

## Piston kit-Set

OEM NO. 123500-12090



Piston	SIZE
Comp : 69.5 Height : -25.0 Length : 119.5 Top Shape : Ø59.0 Direct Injection Pin : 38.0 Length : 88.0	STD

## Piston Ring

OEM NO.  
NPR :



OEM Ring Groove	SIZE
Top : 3.0 2nd : 2.5 Oil : 5.0	STD

## Cylinder Liner

OEM NO.



Liner&Sleeve	SIZE
In Diameter : 112.0 Out Diameter : 117.0 Total length : 216.5 Flange : 122.0*5.05+1.0	STD

## Engine Bearing

MAIN :  
CON.ROD :  
T/W :  
C/B :  
BUSH :



	SIZE
	STD

## Engine Valve

OEM NO.  
IN  
OEM NO.  
EX

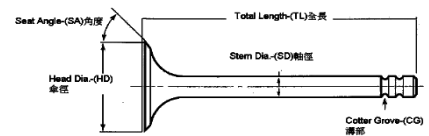

	SIZE
	STD

## Valve Seat

OEM NO.  
IN  
OEM NO.  
EX

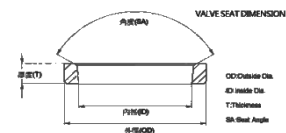

	SIZE
	STD

## Valve Guide

OEM NO. 127610-11150  
IN 54.0 17.0 10.0  
OEM NO. 127610-11160  
EX 57.0 17.0 10.0

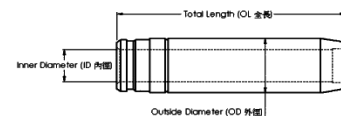

	SIZE
	STD

## Gasket Set

OEM NO.

