



Taiwan Excellent Auto Engine Parts  
**Warranty for**

**2 Year / 20,000 km**

# KOMATSU

## Diesel Engine Parts

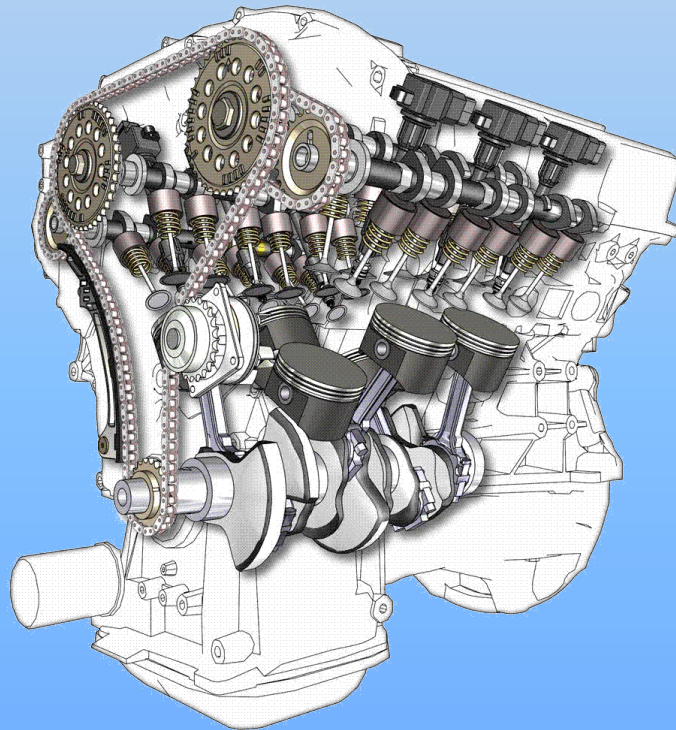

Contact Person: Mr. Jacky Tsai  
Email 1: [eton.jacky@msa.hinet.net](mailto:eton.jacky@msa.hinet.net)  
Email 2: [valveparts2866@gmail.com](mailto:valveparts2866@gmail.com)  
Tel : (8864) 2293-6969  
Fax : (8864) 2293-7070  
No. 90, Wenchang 1<sup>st</sup> St., North District,  
Taichung City, Taiwan. 40464

**E & T SCIENCE INC.**

**ISO/TS 16949  
QS9000**



# PISTON TERMINOLOGY

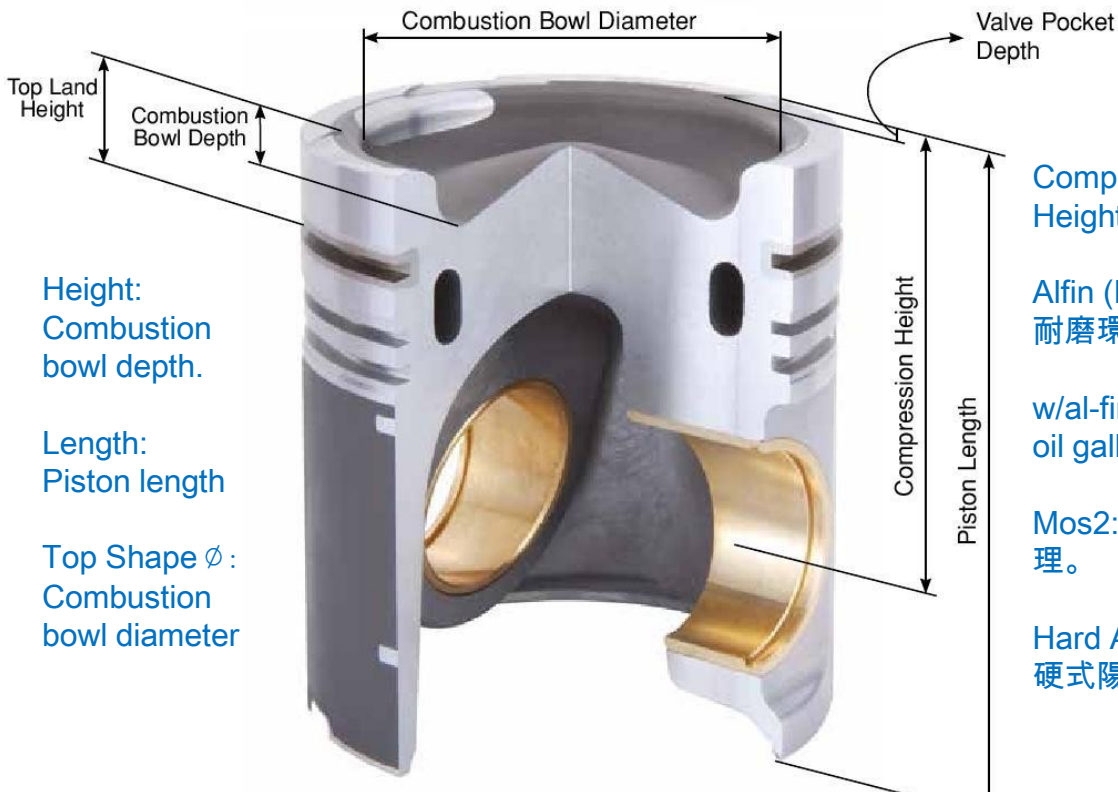
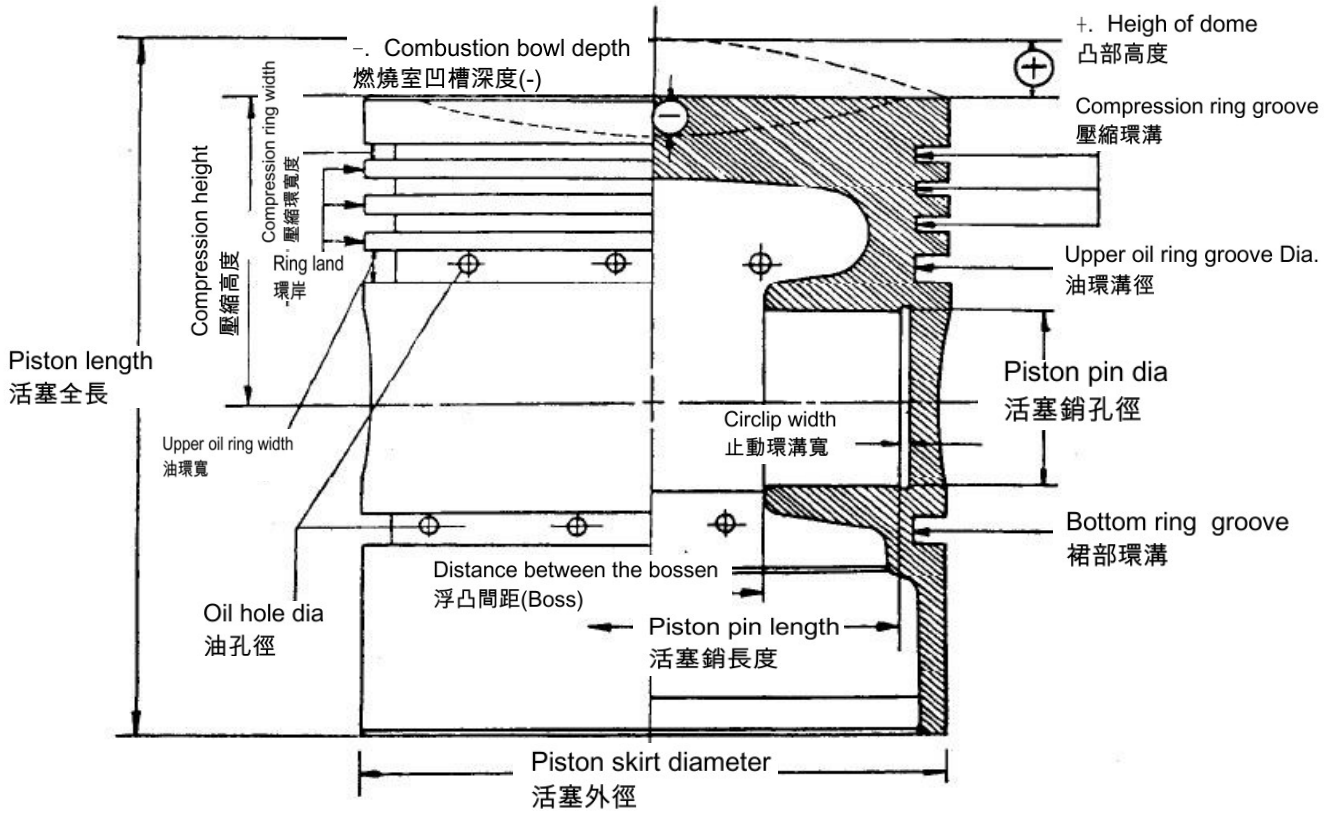

Height:  
Combustion bowl depth.

Length:  
Piston length

Top Shape  $\phi$  :  
Combustion bowl diameter

Comp: Compression Height 壓縮高度

Alfin (Ring Carrier) 耐磨環

w/al-fin: Alfin and with oil gallery.

Mos2: 裙部二硫化鉬處理。

Hard Anodizing: 硬式陽極處理。



# PISTON RING TERMINOLOGY

## Free Ring(Unstressed)

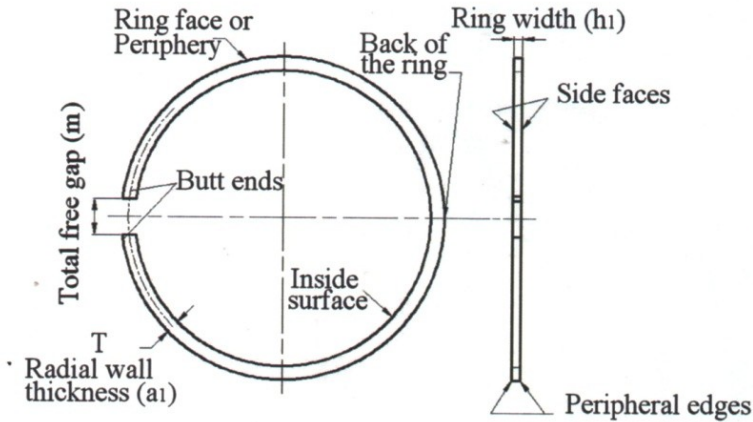

## Closed Ring

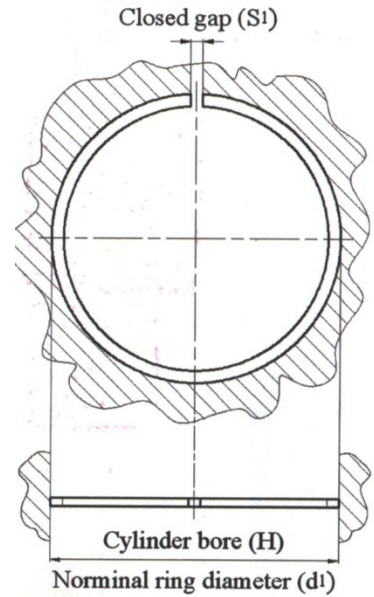

## Compression Ring

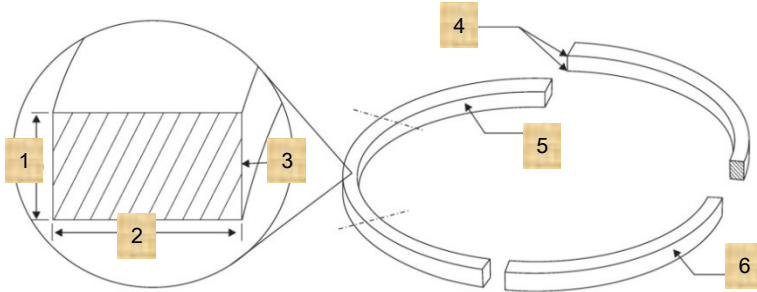

- 1. Piston ring width
- 2. Piston ring thickness
- 3. Inside edge of gap
- 4. Inside edges
- 5. Inside surface
- 6. Peripheral surface

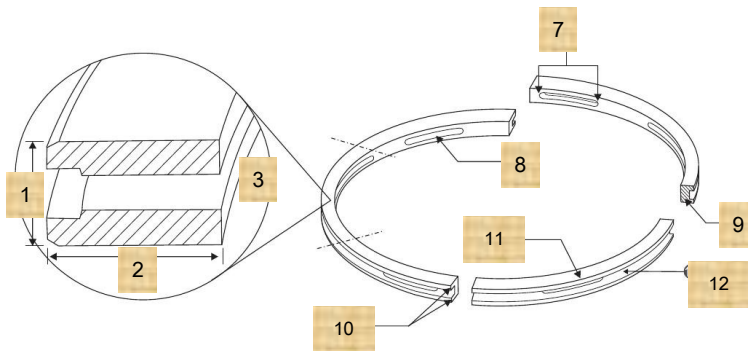

- 7. Inside edges of slot
- 8. Slot face
- 9. Gap face
- 10. Outside gap corners
- 11. Side face
- 12. Outside groove face

## Oil Control Ring



# LINER/SLEEVE TERMINOLOGY

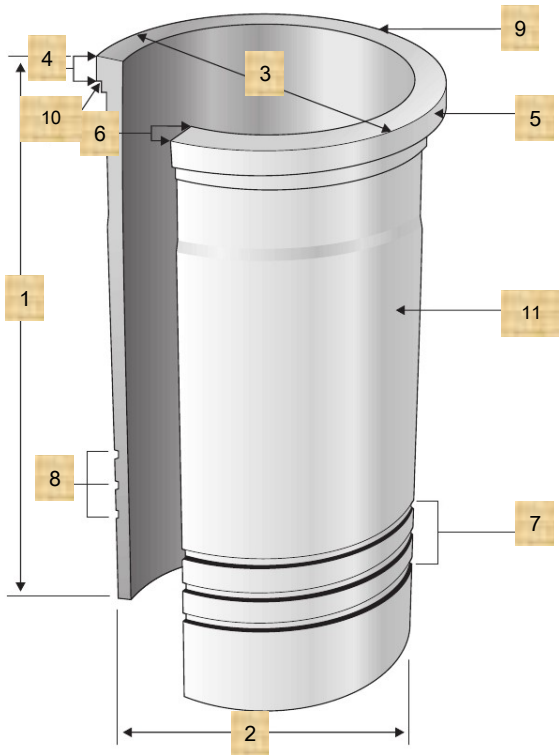

- 1. Total length
- 2. Outside diameter
- 3. Flange diameter  
(Register diameter)
- 4. Flange depth  
(Collar height)
- 5. Flange
- 6. Top land width
- 7. Sealing area
- 8. O-Ring groove
- 9. Firewall
- 10. Machining relief
- 11. Barel



Wet Cylinder Liner

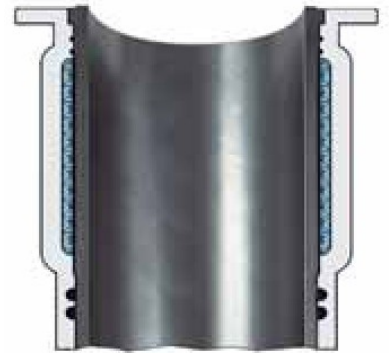

Dry Cylinder Liner

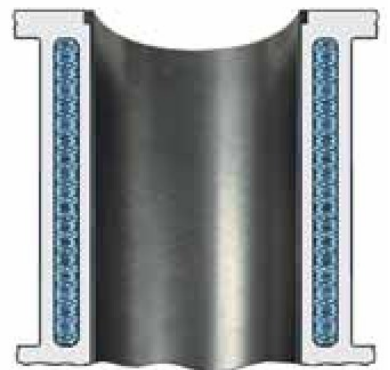



# BEARINGS TERMINOLOGY



Rocker arm bushes



Con rod bushes



Connecting rod bearing



Main bearing



Flanged bearing



Thrust washers



Camshaft bearing

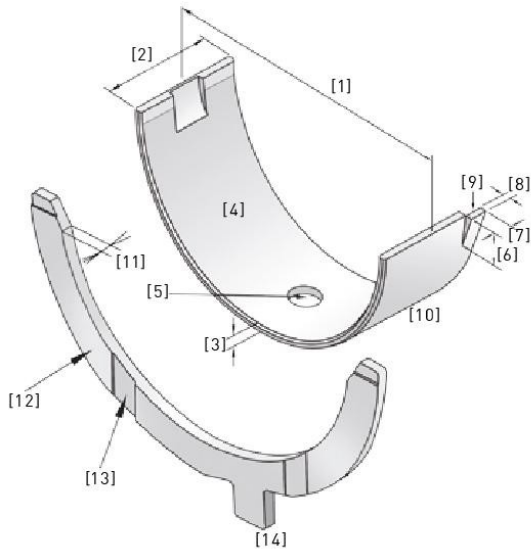

## Bearing Shell

1. Free spread
2. Bearing length
3. Bearing wall thickness
4. Bearing surface
5. Lubrication hole
6. Length of locating lug
7. Width of locating lug
8. Height of locating lug
9. Locating lug relief
10. Bearing back

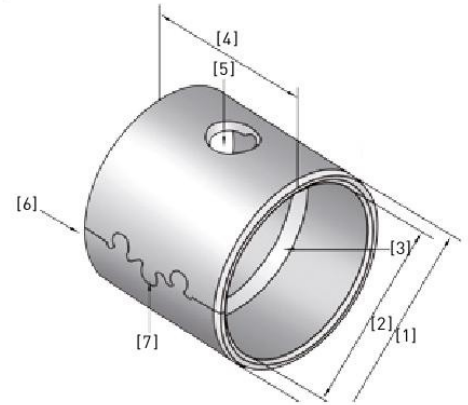

## Bushing

1. Outside diameter
2. Inside diameter
3. Oil groove
4. Bushing length
5. Lubrication hole
6. Joint
7. Clinch

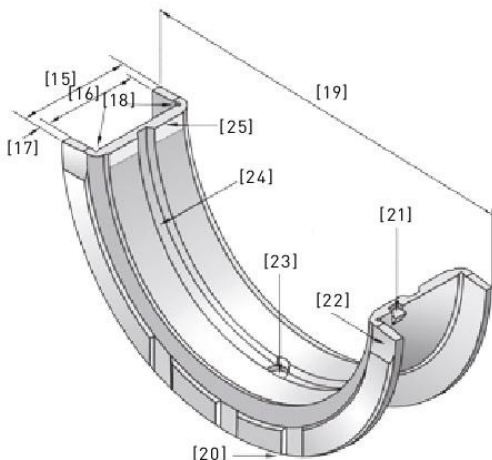

## Flange Bearing

15. Flange bearing length
16. Distance between flange
17. Flange thickness
18. Flange relief grooves
19. Flange diameter
20. Relief at joint face
21. Locating lug
22. Relief at joint face
23. Lubrication hole
24. Oil groove
25. Relief at surface
26. Flange and Bearing assembly

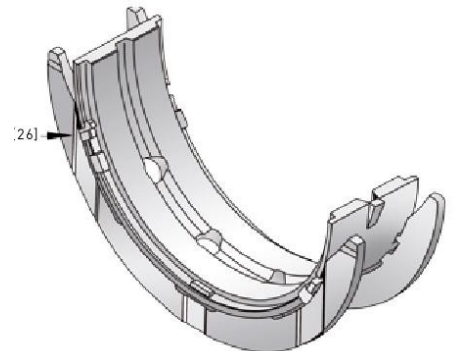



# ENGINE VALVE SPECIFICATION

## ENGINE VALVE DIMENSION

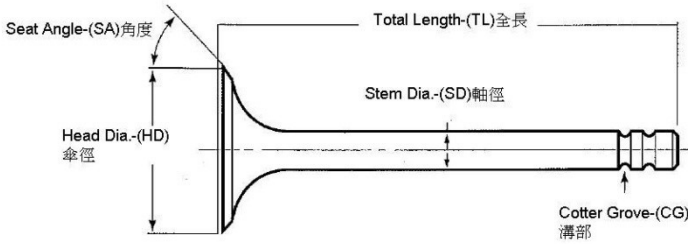

Stem Top Hardness:  
**HRC 45~60**

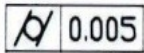

Roundness Tolerance  
**≤0.005mm**

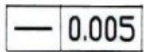

Straightness Tolerance  
**≤0.005mm**

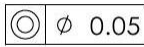

Concentricity Tolerance  
**≤0.05mm**

## SPECIFICATION



## SHAPE OF COTTER GROOVE (CG)

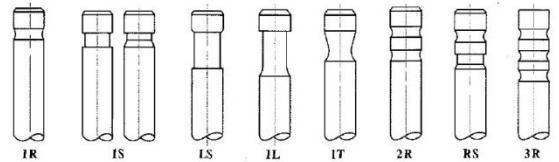

## 引擎汽門(Engine Valve)使用鋼材對照

材料代號對照					材料化學成分								適用於
Martensitic Steel 麻田散鐵													IN/EX
ISO	JIS	SAE	DIN/BS	大陸	C	Si	Mn	P	S	Ni	Cr	Mo	
42CrMo4	SCM440	4140	EN49		0.43	0.35	0.85				1.2	0.3	
X45CrSi93	SUH1	HNV3	X45CrSi9 3	45Cr9Si3	0.4-0.5	3.0-3.5	≤0.60	≤0.03	≤0.03	≤0.5	7.5-9.0		
	SUH3		X40CrSiMo10-2	40Cr10Si2Mo	0.30-0.45	1.8-2.5	≤0.60	≤0.03	≤0.03	≤0.6	10.0-12.0	0.7-1.3	
	SUH4(XB)	ENV6	EN59	80Cr20Si2Ni	0.75-0.85	1.75-2.25	0.2-0.6	≤0.03	≤0.03	1.15-1.65	19.0-20.5		
X50CrSi82	SUH11	HNV3	EN52	51Cr8Si2	0.45-0.55	1.0-2.0	≤0.60	≤0.03	≤0.03		7.5-9.5		
Austenitic Steel 奧斯田鐵 Non-magnetic													EX
	SUH31	EV9		45Cr14Ni14W2Mo	0.3-0.45	1.5-2.5	≤0.60	≤0.04	≤0.03	13.0-15.0	14.0-16.0		
X53CrMnNiN214	SUH35(21-4N)	EV8	349S54	53Cr21Mn9Ni4N	0.58	≤0.35	8.0-10.0	≤0.01	≤0.03	3.25-4.5	20.0-22.0		
	SUH37(21-12N)	EV4	381S34	20Cr21Ni12N	0.15-0.25	0.75-1.0	1.0-1.5	≤0.025	≤0.025	10.5-12.5	20.0-22.0		
	SUH38				0.25-0.35	≤1.0	≤1.2	0.18-0.25	≤0.03	10.0-12.0	19.0-21.0	1.8-2.5	
Nickel Basic alloy 鎳基合金													EX
NiCr20TiAl	NiMonic 80A	2.4952(HEV5)		GH4080A	0.10max	1.0	1.0		Fe 3.0 max	65.0min	18.0-21.0	Al 1.0-1.5	
NiCr15Fe7TiAl	751	2.4669(HEV3)	NiCr15FeTiAl	GH4751									

## STELLITE 鈷鎳鉻合金鋼(軸端與盤面焊補材質)

	C	Cr	W	Fe	Co	HRC
Stellite #1	2.5	30.0	12.0	3.0 Max	Balance	54
Stellite #6	1.0	28.0	4.0	3.0 Max	Balance	44
Stellite #12	1.35	29.0	8.0	2.0	Balance	47



# VALVE SEAT & GUIDE SPECIFICATION

Valve Seat:  
High Chrome Alloy Steel  
Hardness :HRC 36~47

- 0.03 Parallelism Tolerance  $\leq 0.03\text{mm}$
- 0.012 Verticality Tolerance  $\leq 0.012\text{mm}$
- $\phi$  0.05 Concentricity Tolerance  $\leq 0.05\text{mm}$

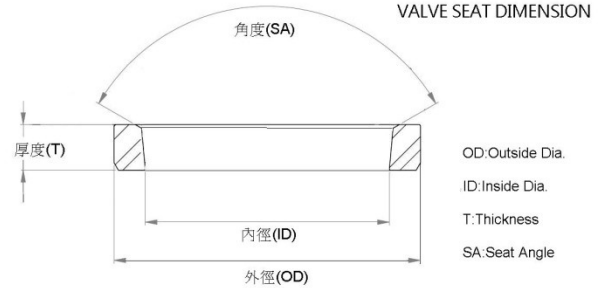

## Valve Seat Material

汽門座圈材料成份表

材質:高鉻合金High Chrome Alloy Steel(耐熱合金鑄造鋼)



	C	Si	Mn	P	S	Cr	Mo	Ni	V	Hardness 硬度HRC
高鉻合金 High Chrome Alloy Steel	1.5~2.0	1.5~2.0	0.6~1.2	$\leq 0.10$	$\leq 0.10$	13.5~15	0.35~0.5			36~47

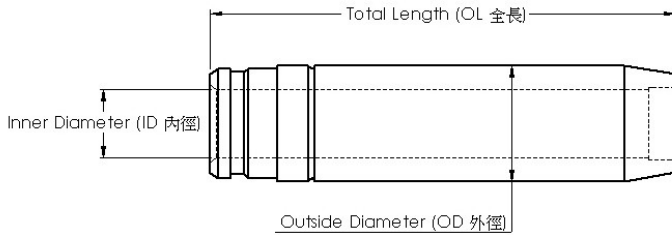

(mm)	Inlet valve ( $\mu\text{m}$ )	Exhaust valve ( $\mu\text{m}$ )
Stem dia. 6 - 7	10 - 40	25 - 55
Stem dia. 8 - 9	20 - 50	35 - 65
Stem dia. 10 - 12	40 - 70	55 - 85

## Valve Guide: Cast Iron FC25

Hardness :HRB 92~102°

- Surface finish Ra  $\leq 0.8\mu\text{m}$
- Inner diameter tolerance  $\leq 0.01\text{mm}$
- Outer diameter tolerance  $\leq 0.01\text{mm}$
- Concentricity diameter tolerance  $\leq 0.05\text{mm}$

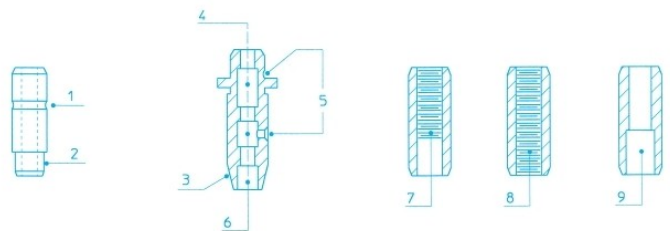

- 1.Outer groove for snap ring
- 2.Narrower end
- 3.Conical end
- 4.Recessd area in the bore

- 5.Lubrification holes
- 6.Counterbore at end of guides
- 7/8.Lubrification threads
- 9.Counter bore

$\phi$  0.05

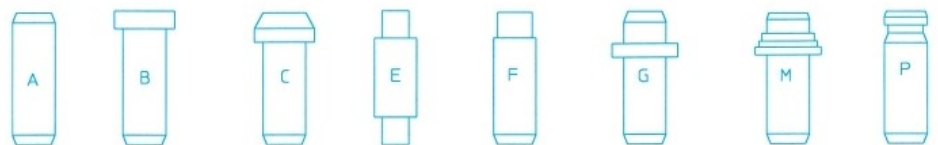





### Piston kit-Set

OEM NO. 6142-32-2110-830T1

Piston	SIZE
Comp : 55.5 Height : Length : 99.0 Top Shape : Flower Pin : 32.0 Length : 74.0	STD

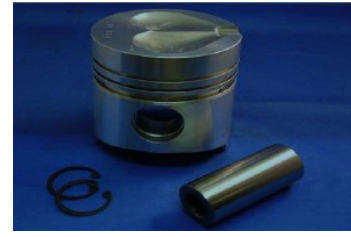

### Piston Ring

OEM NO.6142-32-2020  
NPR :

OEM Ring Groove	SIZE
Top : 2.9 2nd : 2.5 Oil : 5.0	STD



### Cylinder Liner

OEM NO. 6144-21-2211

Liner&Sleeve	SIZE
In Diameter : 94.0 Out Diameter : 108.0 Total length : 181.0 Flange : 117.0*10.0+1.0	STD



### Engine Bearing

MAIN : 6142-22-8010  
CON.ROD : 6140-31-3040  
T/W : 6140-21-8050  
C/B :  
BUSH : 6140-31-3131

SIZE  
STD



### Engine Valve

OEM NO. 6140-41-4111  
IN 40.0 9.0 134.0  
OEM NO. 6140-41-4211  
EX 35.0 9.0 134.0

SIZE  
STD

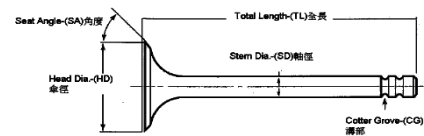

### Valve Seat

OEM NO. 6142-11-1410  
IN 43.0 35.4 6.5  
OEM NO. 6142-11-1420  
EX 38.0 28.4 6.5

SIZE  
STD

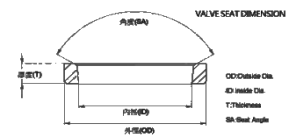

### Valve Guide

OEM NO. 6142-19-1310  
IN/EX 78.0 9.0 14.0

SIZE  
STD

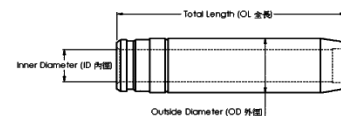

### Gasket Set

OEM NO.



### Piston kit-Set

OEM NO. 6142-32-2110



Piston

SIZE

Comp : 55.5 Height : -10.0 Length : 99.3  
Top Shape : Flower  
Pin : 32.0  
Length : 74.0

STD

### Piston Ring

OEM NO.6142-32-2020  
NPR :



OEM Ring Groove

SIZE

Top : 2.9  
2nd : 2.5  
Oil : 5.0

STD

### Cylinder Liner

OEM NO. 6144-21-2211



Liner&Sleeve

SIZE

In Diameter : 94.0  
Out Diameter : 108.0  
Total length : 181.0  
Flange : 117.0\*10.0+1.0

STD

### Engine Bearing

MAIN : 6142-22-8010  
CON.ROD : 6140-31-3040  
T/W : 6140-21-8050  
C/B :  
BUSH : 6140-31-3131

SIZE



STD

### Engine Valve

OEM NO. 6140-41-4111  
IN 40.0 9.0 134.0  
OEM NO. 6140-41-4211  
EX 35.0 9.0 134.0

SIZE

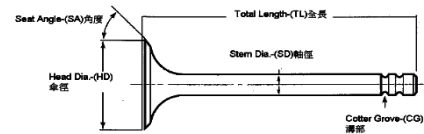

STD

### Valve Seat

OEM NO. 6142-11-1410  
IN 43.0 35.4 6.5  
OEM NO. 6142-11-1420  
EX 38.0 28.4 6.5

SIZE

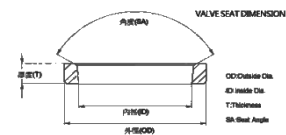

STD

### Valve Guide

OEM NO. 6142-19-1310  
IN/EX 78.0 9.0 14.0

SIZE

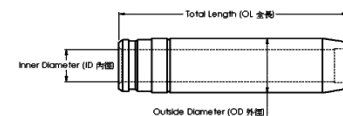

STD

### Gasket Set

OEM NO.



### Piston kit-Set

OEM NO. 6142-32-2120

Piston	SIZE
Comp : 55.4 Height : -9.0 Length : 99.0 Top Shape : Flower Pin : 32.0 Length : 74.0	STD



### Piston Ring

 OEM NO.6142-32-2020  
 NPR :

OEM Ring Groove	SIZE
Top : 2.9 2nd : 2.5 Oil : 5.0	STD



### Cylinder Liner

OEM NO. 6144-21-2211

Liner&Sleeve	SIZE
In Diameter : 94.0 Out Diameter : 108.0 Total length : 181.0 Flange : 117.0*10.0+1.0	STD



### Engine Bearing

 MAIN : 6142-22-8010  
 CON.ROD : 6140-31-3040  
 T/W : 6140-21-8050  
 C/B :  
 BUSH : 6140-31-3131

SIZE
STD



### Engine Valve

 OEM NO. 6140-41-4111  
 IN 40.0 9.0 134.0  
 OEM NO. 6140-41-4211  
 EX 35.0 9.0 134.0

SIZE
STD

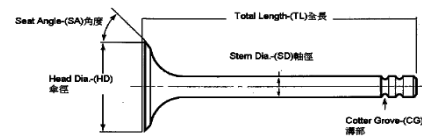

### Valve Seat

 OEM NO. 6142-11-1410  
 IN 43.0 35.4 6.5  
 OEM NO. 6142-11-1420  
 EX 38.0 28.4 6.5

SIZE
STD

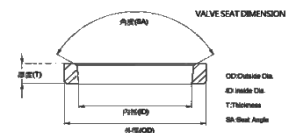

### Valve Guide

 OEM NO. 6142-19-1310  
 IN/EX 78.0 9.0 14.0

SIZE
STD

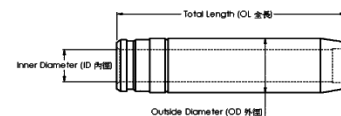

### Gasket Set

OEM NO.



# KOMATSU 4D94E(4TNE94)

Application : Komatsu model 12  
Number of Cylinders 4  
Cylinder dia. 94.0 MM  
Swept Volume 2275 ccm

## Piston kit-Set

OEM NO. 129901-22080 Refer YANMAR:4TNE94

Piston	SIZE
Comp : 59.8 w/al-fin Height : -1.7 Length : 104.0 Top Shape : Flower Pin : 30.0 Length : 73.0	STD



## Piston Ring

OEM Ring Groove	SIZE
Top : 2.0K 2nd : 2.0 Oil : 3.0	STD 0.50



## Cylinder Liner

Liner&Sleeve	SIZE
In Diameter : 94.0 Out Diameter : 97.0 Total length : 181.0 Flange :	STD



## Engine Bearing

	SIZE
MAIN : 129900-02800 CON.ROD : 129900-23600 T/W : 129900-02930 C/B : BUSH :	STD



## Engine Valve

	SIZE
OEM NO. 129900-11100 IN 41.0 8.0 115.0 60.0 OEM NO. 129900-11110 EX 35.0 8.0 115.2 45.0	STD

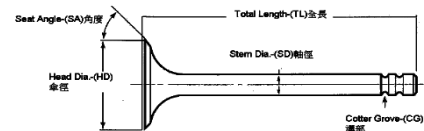

## Valve Seat

	SIZE
OEM NO. 129901-11080 IN 43.0 37.0 6.0 OEM NO. 129901-11090 EX 37.0 31.0 6.0	STD

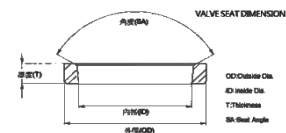

## Valve Guide

	SIZE
OEM NO. 121400-11340 IN 42.0 13.0 8.0 OEM NO. 129150-11810 EX 48.0 13.0 8.0	STD

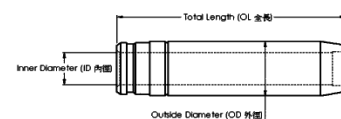

## Gasket Set

OEM NO.



# KOMATSU

## 4TNV94

**Application :**  
**Number of Cylinders 4**  
**Cylinder dia. 94.0 MM**  
**Swept Volume 3053 ccm**

### Piston kit-Set

OEM NO. 129906-22080

Piston	SIZE
Comp : 55.0 w/al-fin Height : -17.0 Length : 99.0 Top Shape : Ø48.0 Direct Injection Pin : 30.0 Length : 73.0	STD



### Piston Ring

OEM NO.  
 NPR :

OEM Ring Groove	SIZE
Top : 2.0K 2nd : 2.0 Oil : 3.0	STD 0.50



### Cylinder Liner

OEM NO.

Liner&Sleeve	SIZE
In Diameter : 94.0 Out Diameter : 97.0 Total length : 181.0 Flange :	STD



### Engine Bearing

MAIN : 129900-02800  
 CON.ROD : 129900-23600  
 T/W : 129900-02930  
 C/B :  
 BUSH :

SIZE  
 STD



### Engine Valve

OEM NO. 129900-11100  
 IN 41.0 8.0 115.0 60.0  
 OEM NO. 129900-11110  
 EX 35.0 8.0 115.2 45.0

SIZE  
 STD

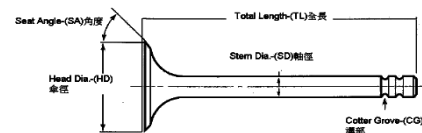

### Valve Seat

OEM NO. 129901-11080  
 IN 43.0 37.0 6.0  
 OEM NO. 129901-11090  
 EX 37.0 31.0 6.0

SIZE  
 STD

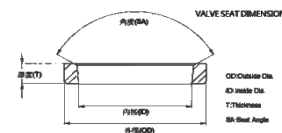

### Valve Guide

OEM NO. 121400-11340  
 IN 42.0 13.0 8.0  
 OEM NO. 129150-11810  
 EX 48.0 13.0 8.0

SIZE  
 STD

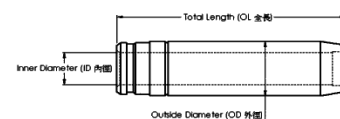

### Gasket Set

OEM NO.



# KOMATSU 4D95A

**Application :**  
**Number of Cylinders 4**  
**Cylinder dia. 95.0 MM**  
**Swept Volume 3260 ccm**

## Piston kit-Set

OEM NO. 6202-33-2160/6202-32-2121

Piston	SIZE
Comp : 61.0 Height : -16.0 Length : 104.0 Top Shape : Ø51.0 Direct Injection Pin : 30.0 Length : 74.0	STD



## Piston Ring

OEM NO.6204-31-2202

NPR :

OEM Ring Groove	SIZE
Top : 2.0 2nd : 2.0 Oil : 4.0	STD 0.50



## Cylinder Liner

OEM NO.

Liner&Sleeve	SIZE
In Diameter : Out Diameter : Total length : Flange :	STD



## Engine Bearing

MAIN : 6204-21-8010  
 CON.ROD : 6204-31-3410  
 T/W : 6204-21-8500  
 C/B : 6204-21-1410(NO.1-3)  
 BUSH : 6204-31-3130

SIZE

STD



## Engine Valve

OEM NO. 6204-41-4110  
 IN 44.0 8.0 128.0  
 OEM NO. 6204-41-4210  
 EX 38.0 8.0 128.0

SIZE

STD

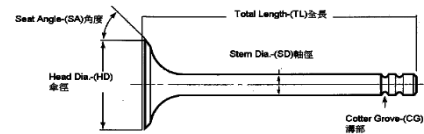

## Valve Seat

OEM NO. 6207-11-1430  
 IN 45.0 38.0 8.8  
 OEM NO. 6207-11-1440  
 EX 39.0 31.5 6.8

SIZE

STD

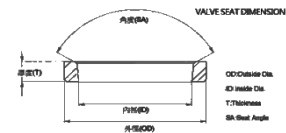

## Valve Guide

OEM NO. 6204-19-1310  
 IN/EX 52.0 8.0 12.0

SIZE

STD

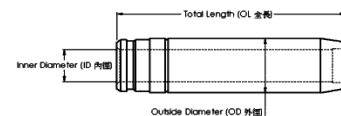

## Gasket Set

OEM NO.



### Piston kit-Set

OEM NO. 6202-32-2120/6204-23-2120



Piston	SIZE
Comp : 51.2 Height : -3.15 Length : 94.0 Top Shape : Flower Pin : 30.0 Length : 74.0	STD

### Piston Ring

OEM NO.6202-32-2300  
NPR :



OEM Ring Groove	SIZE
Top : 2.2K 2nd : 2.0 Oil : 4.0	STD 0.50

### Cylinder Liner

OEM NO.



Liner&Sleeve	SIZE
In Diameter : Out Diameter : Total length : Flange :	STD

### Engine Bearing

MAIN : 6204-21-8010  
CON.ROD : 6204-31-3410  
T/W : 6204-21-8500  
C/B : 6204-21-1410(NO.1-3)  
BUSH : 6204-31-3130



	SIZE
	STD

### Engine Valve

OEM NO. 6204-41-4110  
IN 44.0 8.0 128.0  
OEM NO. 6204-41-4210  
EX 38.0 8.0 128.0

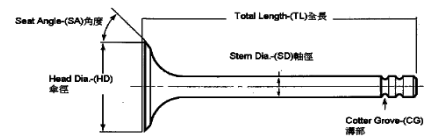

	SIZE
	STD

### Valve Seat

OEM NO. 6207-11-1430  
IN 45.0 38.0 8.8  
OEM NO. 6207-11-1440  
EX 39.0 31.5 6.8

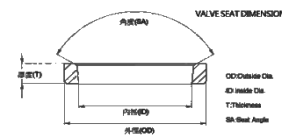

	SIZE
	STD

### Valve Guide

OEM NO. 6204-19-1310  
IN/EX 52.0 8.0 12.0

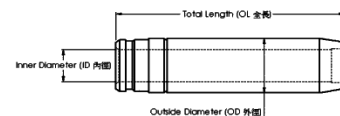

	SIZE
	STD

### Gasket Set

OEM NO.







# KOMATSU 4D95LE

**Application :**  
Number of Cylinders 4  
Cylinder dia. 95.0 MM  
Swept Volume ccm

## Piston kit-Set

OEM NO. 6204-31-2141

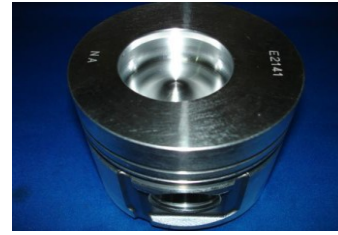

Piston

SIZE

Comp : 51.3 Height : -21.0 Length : 84.4  
Top Shape : Ø45.5  
Direct Injection  
Pin : 30.0 Length : 74.0

STD

## Piston Ring

OEM NO.6204-31-2200  
NPR : SDK04031ZZ



OEM Ring Groove

SIZE

Top : 2.0  
2nd : 2.0  
Oil : 4.0

STD

## Cylinder Liner

OEM NO.



Liner&Sleeve

SIZE

In Diameter :  
Out Diameter :  
Total length :  
Flange :

STD

## Engine Bearing

MAIN :  
CON.ROD :  
T/W :  
C/B :  
BUSH :

SIZE



STD

## Engine Valve

OEM NO. 6204-41-4110  
IN 44.0 8.0 128.0  
OEM NO. 6204-41-4210  
EX 38.0 8.0 128.0

SIZE

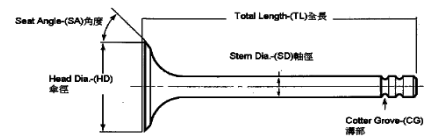

STD

## Valve Seat

OEM NO. 6207-11-1430  
IN 45.0 38.0 8.8  
OEM NO. 6207-11-1440  
EX 39.0 31.5 6.8

SIZE

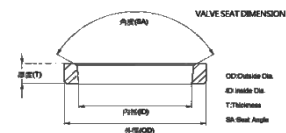

STD

## Valve Guide

OEM NO. 6204-19-1310  
IN/EX 52.0 8.0 12.0

SIZE

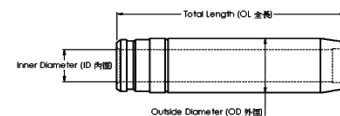

STD

## Gasket Set

OEM NO.



# KOMATSU 4D95LE-3

**Application :**  
Number of Cylinders 4  
Cylinder dia. 95.0 MM  
Swept Volume ccm

## Piston kit-Set

OEM NO. 6204-31-2190

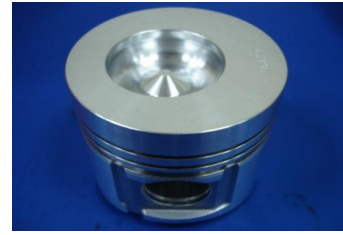

Piston

SIZE

Comp : 50.8 Height : -19.6 Length : 83.8  
Top Shape : Ø50.0  
Direct Injection  
Pin : 30.0 Length : 74.0

STD

## Piston Ring

OEM NO.6204-31-2200  
NPR : SDK04031ZZ



OEM Ring Groove

SIZE

Top : 2.0  
2nd : 2.0  
Oil : 4.0

STD

## Cylinder Liner

OEM NO.



Liner&Sleeve

SIZE

In Diameter :  
Out Diameter :  
Total length :  
Flange :

STD

## Engine Bearing

MAIN :  
CON.ROD :  
T/W :  
C/B :  
BUSH :



SIZE

STD

## Engine Valve

OEM NO. 6204-41-4110  
IN 44.0 8.0 128.0  
OEM NO. 6204-41-4210  
EX 38.0 8.0 128.0

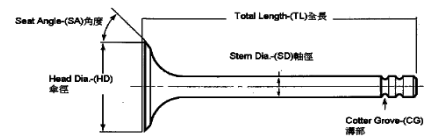

SIZE

STD

## Valve Seat

OEM NO. 6207-11-1430  
IN 45.0 38.0 8.8  
OEM NO. 6207-11-1440  
EX 39.0 31.5 6.8

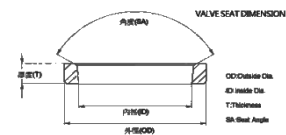

SIZE

STD

## Valve Guide

OEM NO. 6204-19-1310  
IN/EX 52.0 8.0 12.0

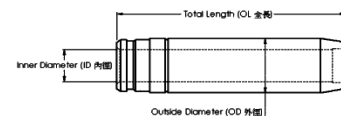

SIZE

STD

## Gasket Set

OEM NO.



# KOMATSU 4D95S

**Application :**  
**Number of Cylinders 4**  
**Cylinder dia. 95.0 MM**  
**Swept Volume 3260 ccm**

## Piston kit-Set

OEM NO. 6201-31-2111/6201-32-2121/6202-33-2150



Piston	SIZE
Comp : 61.0 Height : -4.4 Length : 104 Top Shape : Flower Pin : 30.0 Length : 74.0	STD

## Piston Ring

OEM NO.6202-32-2200

NPR :



OEM Ring Groove	SIZE
Top : 2.2K 2nd : 2.0 Oil : 4.0	STD 0.50

## Cylinder Liner

OEM NO.



Liner&Sleeve	SIZE
In Diameter : Out Diameter : Total length : Flange :	STD

## Engine Bearing

MAIN : 6204-21-8010  
 CON.ROD : 6204-31-3410  
 T/W : 6204-21-8500  
 C/B : 6204-21-1410(NO.1-3)  
 BUSH : 6204-31-3130



	SIZE
	STD

## Engine Valve

OEM NO. 6204-41-4110  
 IN 44.0 8.0 128.0  
 OEM NO. 6204-41-4210  
 EX 38.0 8.0 128.0

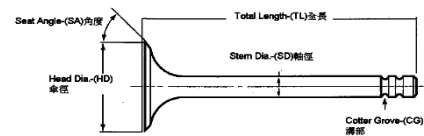

	SIZE
	STD

## Valve Seat

OEM NO. 6207-11-1430  
 IN 45.0 38.0 8.8  
 OEM NO. 6207-11-1440  
 EX 39.0 31.5 6.8

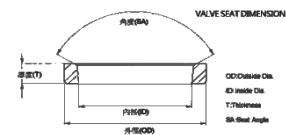

	SIZE
	STD

## Valve Guide

OEM NO. 6204-19-1310  
 IN/EX 52.0 8.0 12.0

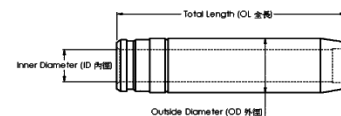

	SIZE
	STD

## Gasket Set

OEM NO.



# KOMATSU

## S4D95 Turbo

**Application :**  
**Number of Cylinders 4**  
**Cylinder dia. 95.0 MM**  
**Swept Volume 3260 ccm**

### Piston kit-Set

OEM NO. 6207-31-2120/6207-31-2141

Piston	SIZE
Comp : 51.2 w/al-fin Height : -19.0 Length : 94.0 Top Shape : Ø56.0 Direct Injection Pin : 30.0 Length : 74.0	STD



### Piston Ring

OEM NO.6207-31-2500  
 NPR :

OEM Ring Groove	SIZE
Top : 2.5DK 2nd : 2.2 Oil : 4.0	STD



### Cylinder Liner

OEM NO.

Liner&Sleeve	SIZE
In Diameter : Out Diameter : Total length : Flange :	STD



### Engine Bearing

MAIN : 6204-21-8100  
 CON.ROD : 6204-31-3400  
 T/W : 6204-21-8500  
 C/B : 6204-21-1420(NO.2-4)  
 BUSH : 6207-31-3150

SIZE  
 STD



### Engine Valve

OEM NO. 6204-41-4110  
 IN 44.0 8.0 128.0  
 OEM NO. 6204-41-4210  
 EX 38.0 8.0 128.0

SIZE  
 STD

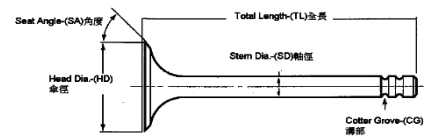

### Valve Seat

OEM NO. 6207-11-1430  
 IN 45.0 38.0 8.8  
 OEM NO. 6207-11-1440  
 EX 39.0 31.5 6.8

SIZE  
 STD

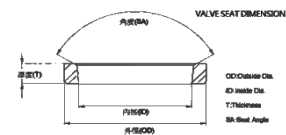

### Valve Guide

OEM NO. 6204-19-1310  
 IN/EX 52.0 8.0 12.0

SIZE  
 STD

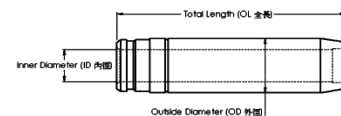

### Gasket Set

OEM NO.



# KOMATSU 4D95T

**Application :**  
**Number of Cylinders 4**  
**Cylinder dia. 95.0 MM**  
**Swept Volume 3260ccm**

## Piston kit-Set

OEM NO. 6205-31-2170



Piston	SIZE
Comp : 50.8 w/al-fin Height : -19.7 Length : 83.8 Top Shape : Ø50.0 Direct Injection Pin : 30.0 Length : 74.0	STD

## Piston Ring

OEM NO.6207-31-2200  
NPR : SDK04032ZZ



OEM Ring Groove	SIZE
Top : 2.5DK 2nd : 2.0 Oil : 4.0	STD

## Cylinder Liner

OEM NO.



Liner&Sleeve	SIZE
In Diameter : Out Diameter : Total length : Flange :	STD

## Engine Bearing

MAIN :  
CON.ROD :  
T/W :  
C/B :  
BUSH :



	SIZE
	STD

## Engine Valve

OEM NO. 6204-41-4110  
IN 44.0 8.0 128.0  
OEM NO. 6204-41-4210  
EX 38.0 8.0 128.0

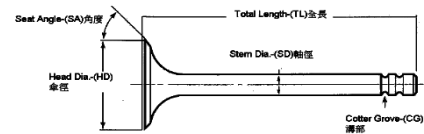

	SIZE
	STD

## Valve Seat

OEM NO. 6207-11-1430  
IN 45.0 38.0 8.8  
OEM NO. 6207-11-1440  
EX 39.0 31.5 6.8

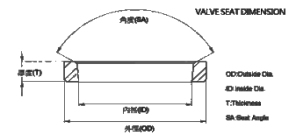

	SIZE
	STD

## Valve Guide

OEM NO. 6204-19-1310  
IN/EX 52.0 8.0 12.0

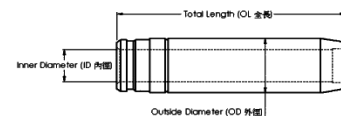

	SIZE
	STD

## Gasket Set

OEM NO.



# KOMATSU 4D98E

**Application :**  
**Number of Cylinders 4**  
**Cylinder dia. 98.0 MM**  
**Swept Volume 3318 ccm**

## Piston kit-Set

OEM NO.

Piston

SIZE

Comp : 54.8 Height : -20.0 Length : 98.6  
 Top Shape : Ø53.3  
 Direct Injection  
 Pin : 30.0 Length : 72.0

STD



## Piston Ring

OEM NO.129903-22050

NPR :

OEM Ring Groove

SIZE

Top : 2.0K  
 2nd : 2.0  
 Oil : 3.0

STD



## Cylinder Liner

OEM NO.

Liner&Sleeve

SIZE

In Diameter :  
 Out Diameter :  
 Total length :  
 Flange :

STD



## Engine Bearing

MAIN : 129900-02800  
 CON.ROD : 129900-23600  
 T/W : 129900-02930  
 C/B :  
 BUSH :

SIZE

STD



## Engine Valve

OEM NO. 129900-11100  
 IN 41.0 8.0 115.0 60.0  
 OEM NO. 129900-11110  
 EX 35.0 8.0 115.2 45.0

SIZE

STD

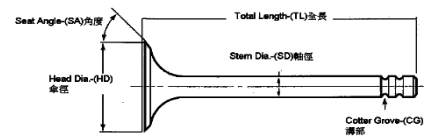

## Valve Seat

OEM NO. 129901-11080  
 IN 43.0 37.0 6.0  
 OEM NO. 129901-11090  
 EX 37.0 31.0 6.0

SIZE

STD

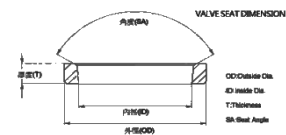

## Valve Guide

OEM NO. 121400-11340  
 IN 42.0 13.0 8.0  
 OEM NO. 129150-11810  
 EX 48.0 13.0 8.0

SIZE

STD

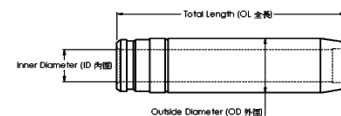

## Gasket Set

OEM NO.



# KOMATSU 4D98E

**Application :**  
**Number of Cylinders 4**  
**Cylinder dia. 98.0 MM**  
**Swept Volume 3318 ccm**

## Piston kit-Set

OEM NO. 139903-22081

Piston	SIZE
Comp : 55.6 Height : -4.2 Length : 99.3 Top Shape : Flower Pin : 30.0 Length : 72.0	STD



## Piston Ring

OEM NO.129903-22050  
NPR :

OEM Ring Groove	SIZE
Top : 2.0K 2nd : 2.0 Oil : 3.0	STD



## Cylinder Liner

OEM NO.

Liner&Sleeve	SIZE
In Diameter : Out Diameter : Total length : Flange :	STD



## Engine Bearing

MAIN : 129900-02800  
CON.ROD : 129900-23600  
T/W : 129900-02930  
C/B :  
BUSH :

SIZE  
STD



## Engine Valve

OEM NO. 129900-11100  
IN 41.0 8.0 115.0 60.0  
OEM NO. 129900-11110  
EX 35.0 8.0 115.2 45.0

SIZE  
STD

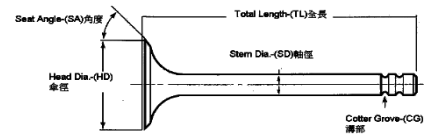

## Valve Seat

OEM NO. 129901-11080  
IN 43.0 37.0 6.0  
OEM NO. 129901-11090  
EX 37.0 31.0 6.0

SIZE  
STD

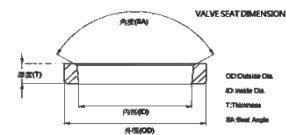

## Valve Guide

OEM NO. 121400-11340  
IN 42.0 13.0 8.0  
OEM NO. 129150-11810  
EX 48.0 13.0 8.0

SIZE  
STD

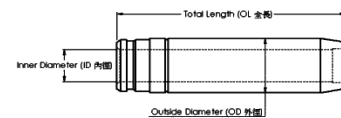

## Gasket Set

OEM NO.



# KOMATSU 4D105-3

**Application :**  
**Number of Cylinders 4**  
**Cylinder dia. 105.0 MM**  
**Swept Volume 3980 ccm**

## Piston kit-Set

OEM NO. 6130-31-2100/6130-32-2110/6131-31-2120/6131-31-2120/6131-32-2120



Piston	SIZE
Comp : 69.0 Height : -23.0 Length : 107.5 Top Shape : Ø61.0 Direct Injection Pin : 38.0 Length : 88.0	STD

## Piston Ring

OEM NO. 6136-31-2010  
NPR :



OEM Ring Groove	SIZE
Top : 3.0 2nd : 2.5 Oil : 5.0	STD

## Cylinder Liner

OEM NO. 6130-22-2310



Liner&Sleeve	SIZE
In Diameter : 105.0 Out Diameter : 118.0 Total length : 223.0 Flange : 125.5*10.0+1.0	STD

## Engine Bearing

MAIN : 6136-21-8010  
CON.ROD : 6136-21-3040  
T/W : 6136-21-8050  
C/B : 6136-21-1400  
BUSH : 6138-31-3133



	SIZE
	STD

## Engine Valve

OEM NO. 6130-41-4121  
IN 46.0 10.0 150.5 60°  
OEM NO. 6130-41-4210  
EX 40.0 10.0 150.5

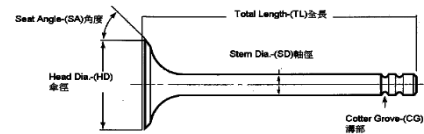

	SIZE
	STD

## Valve Seat

OEM NO. 6136-12-1310  
IN 48.5 40.8 8.8  
OEM NO. 6136-12-1320  
EX 44.0 34.6 9.3

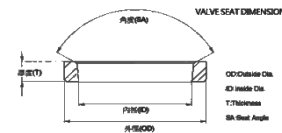

	SIZE
	STD

## Valve Guide

OEM NO. 6136-19-1330  
IN/EX 69.7 10.0 16.0

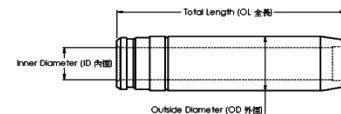

	SIZE
	STD

## Gasket Set

OEM NO.





### Piston kit-Set

OEM NO. 6110-33-2131

Piston	SIZE
Comp : 90.1 Height : Length : 135.5 Top Shape : Flower Pin : 44.0 Length : 100.0	STD



### Piston Ring

OEM NO.6110-30-2301  
NPR :

OEM Ring Groove	SIZE
Top : 3.5 2nd : 2.5 Oil : 5.5	STD



### Cylinder Liner

OEM NO. 6110-21-2212

Liner&Sleeve	SIZE
In Diameter : 120.0 Out Diameter : 140.0 Total length : 293.0 Flange : 150.0*13.0+1.0	STD



### Engine Bearing

MAIN : 6112-23-8000  
CON.ROD : 6110-30-3500  
T/W : 6112-23-8550  
C/B :  
BUSH : 6110-23-1442

SIZE  
STD



### Engine Valve

OEM NO. 6110-43-4110  
IN 53.0 11.0 172.0  
OEM NO. 6110-43-4210  
EX 49.0 11.0 173.0

SIZE  
STD

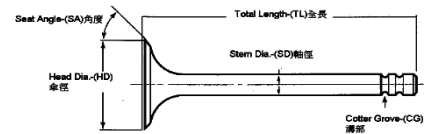

### Valve Seat

OEM NO. 6110-13-1181  
IN 56.0 48.0 9.2  
OEM NO. 6110-13-1171  
EX 52.0 42.0 9.2

SIZE  
STD

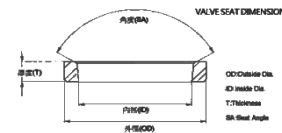

### Valve Guide

OEM NO. 6110-13-1311  
IN/EX 83.0 11.0 18.0

SIZE  
STD

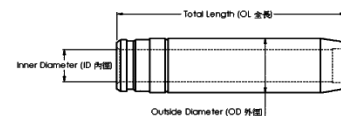

### Gasket Set

OEM NO.



### Piston kit-Set

OEM NO. 6110-33-2600/6114-31-2111



Piston	SIZE
Comp : 89.7 Height : Length : 135.3 Top Shape : Three Leaf Pin : 44.0 Length : 100.0	STD

### Piston Ring

OEM NO.6114-30-2303  
NPR :



OEM Ring Groove	SIZE
Top : 3.5 2nd : 2.5 Oil : 5.5	STD

### Cylinder Liner

OEM NO. 6115-21-2211



Liner&Sleeve	SIZE
In Diameter : 130.0 Out Diameter : 146.0 Total length : 293.0 Flange : 150.0*13.0+1.0	STD

### Engine Bearing

MAIN : 6112-23-8000  
CON.ROD : 6110-30-3500  
T/W : 6112-23-8550  
C/B :  
BUSH : 6110-23-1442



	SIZE
	STD

### Engine Valve

OEM NO. 6114-41-4110  
IN 53.0 11.0 172.0  
OEM NO. 6114-41-4210  
EX 49.0 11.0 173.0

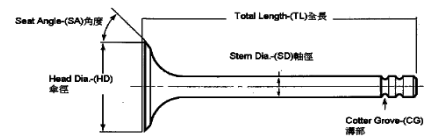

	SIZE
	STD

### Valve Seat

OEM NO. 6114-11-1180  
IN 56.0 48.0 9.2  
OEM NO. 6110-13-1171  
EX 52.0 44.0 9.2

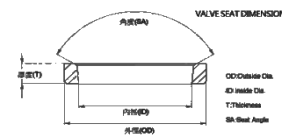

	SIZE
	STD

### Valve Guide

OEM NO. 6110-13-1311  
IN/EX 83.0 11.0 18.0

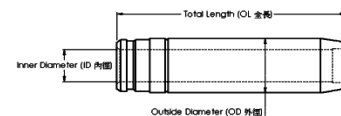

	SIZE
	STD

### Gasket Set

OEM NO.



# KOMATSU 6D105-1

**Application :**  
Number of Cylinders 6  
Cylinder dia. 105.0 MM  
Swept Volume 6490 ccm

## Piston kit-Set

OEM NO. 6136-31-2112

Piston	SIZE
Comp : 69.0 Height : -22.6 Length : 107.5 Top Shape : Ø49.0 Direct Injection Pin : 40.0 Length : 84.0	STD

## Piston Ring

OEM NO.6130-31-2201  
NPR :

OEM Ring Groove	SIZE
Top : 3.0DK 2nd : 2.5 Oil : 5.0	STD



## Cylinder Liner

OEM NO. 6137-21-2210

Liner&Sleeve	SIZE
In Diameter : 105.0 Out Diameter : 118.7 Total length : 223.0 Flange : 127.0*10.0+1.0	STD



## Engine Bearing

MAIN : 6136-21-8010  
CON.ROD : 6136-21-3040  
T/W : 6136-21-8050  
C/B : 6136-21-1400  
BUSH : 6138-31-3133

SIZE  
STD



## Engine Valve

OEM NO. 6136-42-4110  
IN 47.0 9.0 148.5  
OEM NO. 6136-42-4210  
EX 41.0 9.0 148.5

SIZE  
STD

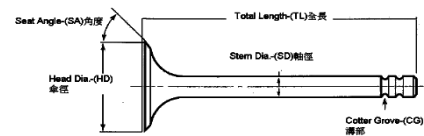

## Valve Seat

OEM NO. 6136-12-1310  
IN 48.5 40.7 8.8  
OEM NO. 6136-12-1320  
EX 44.0 34.6 9.3

SIZE  
STD

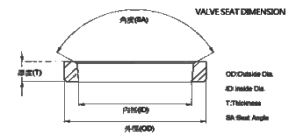

## Valve Guide

OEM NO. 6136-19-1430  
IN/EX 68.0 9.0 16.0

SIZE  
STD

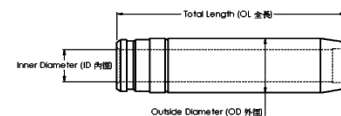

## Gasket Set

OEM NO.



### Piston kit-Set

OEM NO. 6136-32-2110

Piston	SIZE
Comp : 69.2 w/al-fin Height : -23.0 Length : 108.0 Top Shape : Ø58.0 Direct Injection Pin : 40.0 Length : 85.0	STD



### Piston Ring

OEM NO.6136-31-2030

NPR :

OEM Ring Groove	SIZE
Top : 3.0 2nd : 2.5 Oil : 5.0	STD



### Cylinder Liner

OEM NO. 6136-21-2210

Liner&Sleeve	SIZE
In Diameter : 105.0 Out Diameter : 118.7 Total length : 223.0 Flange : 127.0*10.0+1.0	STD



### Engine Bearing

MAIN : 6136-21-8010  
CON.ROD : 6136-21-3040  
T/W : 6136-21-8050  
C/B : 6136-21-1400  
BUSH : 6138-31-3133

SIZE  
STD



### Engine Valve

OEM NO. 6130-41-4121/31  
IN 46.0 10.0 150.5  
OEM NO.6130-41-4210  
EX 40.0 10.0 150.5

SIZE  
STD

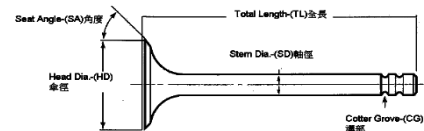

### Valve Seat

OEM NO. 6131-12-1310  
IN 48.5 40.7 8.8  
OEM NO. 6130-11-1323  
EX 44.0 34.6 9.3

SIZE  
STD

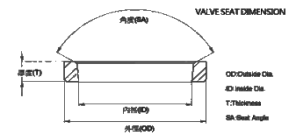

### Valve Guide

OEM NO. 6136-19-1331  
IN/EX 69.7 10.0 16.0

SIZE  
STD

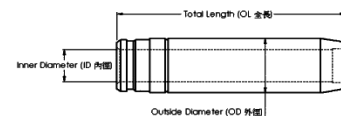

### Gasket Set

OEM NO.



# KOMATSU

## 6D114/6CT8.3 12V

**Application :**  
**Number of Cylinders 6**  
**Cylinder dia. 114.0 MM**  
**Swept Volume 8270 ccm**

### Piston kit-Set

OEM NO. 3923163

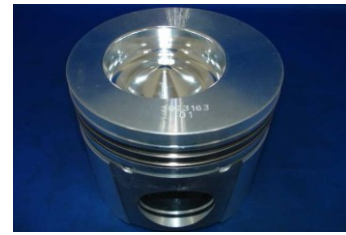

Piston

SIZE

Comp : 78.5 w/al-fin Height : -22.0 Length : 120.6  
 Top Shape : Ø63.5  
 Direct Injection  
 Pin : 45.0 Length : 91.0

STD

### Piston Ring

OEM NO.

NPR :



OEM Ring Groove

SIZE

Top : 3.5DK  
 2nd : 3.0DK  
 Oil : 4.0

STD

### Cylinder Liner

OEM NO. 3919937



Liner&Sleeve

SIZE

In Diameter : 114.0  
 Out Diameter : 125.679  
 Total length : 228.302  
 Flange : 130.949\*123.024+1.143

STD

### Engine Bearing

MAIN :

CON.ROD :

T/W :

C/B :

BUSH :

SIZE



STD

### Engine Valve

OEM NO. 3802463/3924492/6742-01-0150

IN 52.0 9.5 151.0 60°

OEM NO.3802085/3921444/6742-01-3000

EX 46.0 9.5 151.0

SIZE

STD

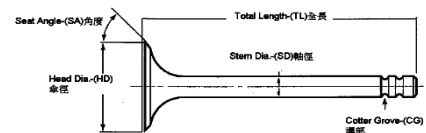

### Valve Seat

OEM NO. 3908830

IN 54.0 44.5 7.8 60°

OEM NO. 3904716

EX 47.0 40.0 5.8 45°

SIZE

STD

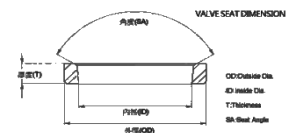

### Valve Guide

OEM NO. 3923564

IN/EX 72.0 9.5 16.0

SIZE

STD

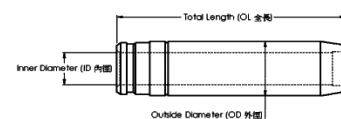

### Gasket Set

OEM NO.



**Piston kit-Set**

OEM NO. 6127-31-2140



Piston

SIZE

Comp : 103.0 w/al-fin Height : -16.0 Length : 167.7  
Top Shape : Ø133.0  
Direct Injection  
Pin : 60.0 Length : 130.0

STD

**Piston Ring**

OEM NO.6128-31-2060

NPR :



OEM Ring Groove

SIZE

Top : 3.68DK  
2nd : 3.55DK  
Oil : 4.75

STD

**Cylinder Liner**

OEM NO. 6128-21-2210

Liner&Sleeve

SIZE

In Diameter : 155.0  
Out Diameter : 176.0  
Total length : 327.0  
Flange : 186.0\*14.0+2.0

STD



**Engine Bearing**

MAIN : 6127-21-8000  
CON.ROD : 6127-31-3041  
T/W : 6127-21-8511  
C/B : 6127-21-1410  
BUSH : 6127-31-3130

SIZE

STD



**Engine Valve**

OEM NO. 6127-41-4214/4113  
IN 56.0 11.0 212.5  
OEM NO.6127-41-4213/4214  
EX 53.0 11.0 212.5

SIZE

STD

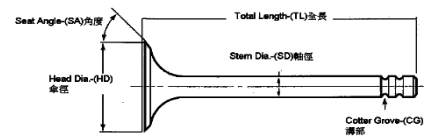

**Valve Seat**

OEM NO. 6127-11-1335  
IN 60.0 51.0 9.0  
OEM NO. 6127-11-1325  
EX 51.0 48.0 9.0

SIZE

STD

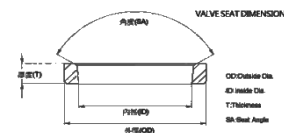

**Valve Guide**

OEM NO. 6107-11-1341  
IN/EX 85.0 11.0 18.0

SIZE

STD

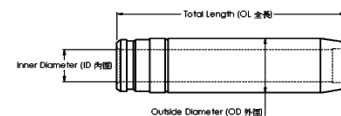

**Gasket Set**

OEM NO.



**Piston kit-Set**

OEM NO. 6128-31-2140



Piston	SIZE
Comp : 105.0 w/al-fin Height : Length : 170.0 Top Shape : Ø124.0 Direct Injection Pin : 60.0 Length : 130.0	STD

**Piston Ring**

OEM NO.6128-31-2060  
NPR :



OEM Ring Groove	SIZE
Top : 3.68DK 2nd : 3.55DK Oil : 4.75	STD

**Cylinder Liner**

OEM NO. 6128-21-2210



Liner&Sleeve	SIZE
In Diameter : 155.0 Out Diameter : 176.0 Total length : 327.0 Flange : 186.0*14.0+2.0	STD

**Engine Bearing**

MAIN : 6127-21-8000  
CON.ROD : 6127-31-3041  
T/W : 6127-21-8511  
C/B : 6127-21-1410  
BUSH : 6127-31-3130



	SIZE
	STD

**Engine Valve**

OEM NO. 6127-41-4214/4113  
IN 56.0 11.0 212.5  
OEM NO.6127-41-4213/4214  
EX 53.0 11.0 212.5

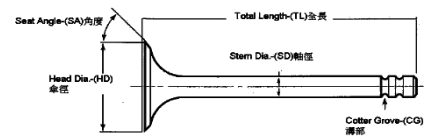

	SIZE
	STD

**Valve Seat**

OEM NO. 6127-11-1335  
IN 60.0 51.0 9.0  
OEM NO. 6127-11-1325  
EX 51.0 48.0 9.0

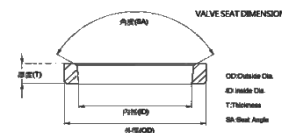

	SIZE
	STD

**Valve Guide**

OEM NO. 6107-11-1341  
IN/EX 85.0 11.0 18.0

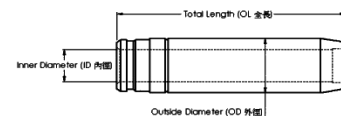

	SIZE
	STD

**Gasket Set**

OEM NO.



# KOMATSU NH220;6D130

**Application :**  
**Number of Cylinders 6**  
**Cylinder dia. 130.175 MM**  
**Swept Volume 12170 ccm**

## Piston kit-Set

OEM NO. 6620-31-2010



Piston	SIZE
Comp : 101.8 w/al-fin Height : -20.4 Length : 158.9 Top Shape : Ø101.0 Pin : 51.0 Length : 110.15	STD

## Piston Ring

OEM NO.  
NPR :



OEM Ring Groove	SIZE
Top : 3.968DK 2nd : 3.968 3rd : 3.968 Oil : 6.35	STD

## Cylinder Liner

OEM NO. 6610-21-2213



Liner&Sleeve	SIZE
In Diameter : 130.175 Out Diameter : 143 Total length : 303.0 Flange : 155.6*11.7+1.9	STD

## Engine Bearing

MAIN :  
CON.ROD :  
T/W :  
C/B :  
BUSH :



	SIZE
	STD

## Engine Valve

OEM NO.6610-41-4110  
IN 44.2 10.2 179.3  
OEM NO.6610-41-4210  
EX 44.2 10.2 179.3

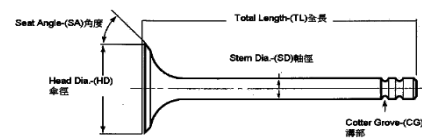

	SIZE
	STD

## Valve Seat

OEM NO. 6610-11-1120  
IN/EX 46.9 39.5 7.1

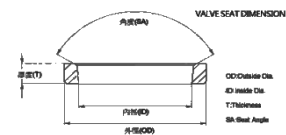

	SIZE
	STD

## Valve Guide

OEM NO. 6610-11-1311  
IN/EX 87.0 10.2 19.0

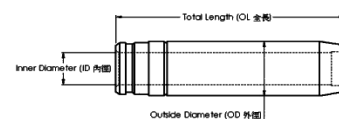

	SIZE
	STD

## Gasket Set

OEM NO.





### Piston kit-Set

OEM NO. 6711-31-2110

Piston	SIZE
Comp : 95.69 Height : Length : 155.3 Top Shape : Ø97.0 Pin : 50.78 Length : 119.3	STD

### Piston Ring

OEM NO.  
NPR :

OEM Ring Groove	SIZE
Top : 3.968DK 2nd : 3.175 3nd : 3.175 Oil : 4.762	STD



### Cylinder Liner

OEM NO. 6710-21-2210

Liner&Sleeve	SIZE
In Diameter : 139.7 Out Diameter : 152.7 Total length : 287.6 Flange : 166.7*9.3+1.85	STD



### Engine Bearing

MAIN :  
CON.ROD :  
T/W :  
C/B :  
BUSH :

SIZE  
STD



### Engine Valve

OEM NO.6712-41-4110  
IN 47.6 11.5 179.5  
OEM NO.6710-41-4210  
EX 47.6 11.5 179.5

SIZE  
STD

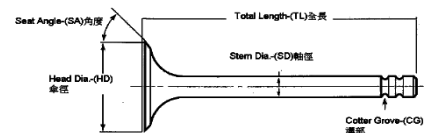

### Valve Seat

OEM NO. 6711-11-1120  
IN/EX 50.9 42.8 7.1

SIZE  
STD

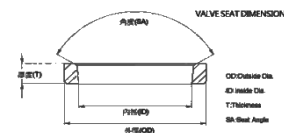

### Valve Guide

OEM NO. 6710-11-1311  
IN/EX 86.0 11.5 19.0

SIZE  
STD

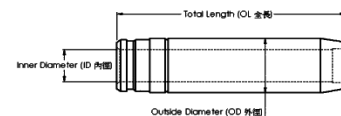

### Gasket Set

OEM NO.



### Piston kit-Set

OEM NO. 6735-31-2140

Piston	SIZE
Comp : 71.6 w/al-fin Height : -22.0 Length : 105.0 Top Shape : Ø51.0 Direct Injection Pin : 44.0 Length : 100.0	STD



### Piston Ring

OEM NO.  
NPR :

OEM Ring Groove	SIZE
Top : 2.87DK 2nd : 2.37 Oil : 4.0	STD



### Cylinder Liner

OEM NO. 6736-29-2210

Liner&Sleeve	SIZE
In Diameter : 102.0 Out Diameter : 105.0 Total length : 205.0 Flange :	STD



### Engine Bearing

MAIN : 6736-21-8110  
CON.ROD : 6732-31-3410  
T/W :  
C/B :  
BUSH : 6732-21-3130

SIZE  
STD



### Engine Valve

OEM NO.3920867/6736-41-4110  
IN 45.0 8.0 129.0  
OEM NO.3920868/6736-41-4210  
EX 42.0 8.0 129.0

SIZE  
STD

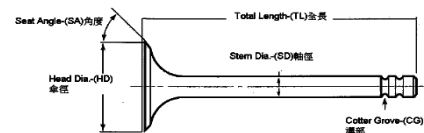

### Valve Seat

OEM NO. 6732-11-1180/3906854  
IN 47.0 38.0 7.0  
OEM NO.6732-11-1170/3904105  
EX 43.7 34.0 6.7

SIZE  
STD

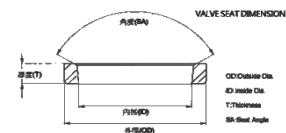

### Valve Guide

OEM NO. 3904408  
IN 60.5 8.0 14.0  
OEM NO.3904409  
EX 52.0 8.0 14.0

SIZE  
STD

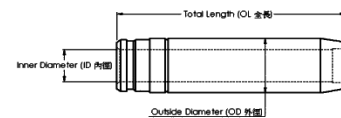

### Gasket Set

OEM NO.



**Piston kit-Set**

OEM NO. 6137-31-2110

Piston	SIZE
Comp : 69.2 Height : Length : 107.7 Top Shape : Ø54.5 Direct Injection Pin : 40.0 Length : 86.0	STD

**Piston Ring**

OEM NO.6130-31-2201  
NPR :

OEM Ring Groove	SIZE
Top : 3.0DK 2nd : 2.5 Oil : 5.0	STD



**Cylinder Liner**

OEM NO. 6137-21-2210

Liner&Sleeve	SIZE
In Diameter : 105.0 Out Diameter : 118.7 Total length : 223.0 Flange : 127.0*10.0+1.0	STD



**Engine Bearing**

MAIN : 6136-21-8010  
CON.ROD : 6136-21-3040  
T/W : 6136-21-8050  
C/B : 6136-21-1400  
BUSH : 6138-31-3133

SIZE  
STD



**Engine Valve**

OEM NO.6136-42-4110  
IN 47.0 9.0 148.5  
OEM NO.6136-42-4210  
EX 41.0 9.0 148.5

SIZE  
STD

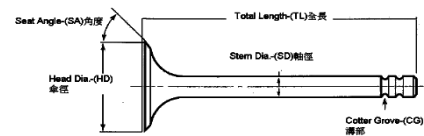

**Valve Seat**

OEM NO. 6136-12-1310  
IN 48.5 40.7 8.8  
OEM NO.6136-12-1320  
EX 44.0 34.6 9.3

SIZE  
STD

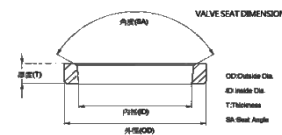

**Valve Guide**

OEM NO. 6136-19-1430  
IN/EX 68.0 9.0 16.0

SIZE  
STD

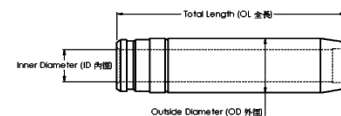

**Gasket Set**

OEM NO.



**Piston kit-Set**

OEM NO. 6137-32-2110/6137-32-2130-6137-32-2010

Piston	SIZE
Comp : 69.2 w/al-fin Height : -23.0 Length : 107.8 Top Shape : Ø59.0 Direct Injection Pin : 40.0 Length : 85.0	STD



**Piston Ring**

OEM NO.6130-31-2201  
NPR :

OEM Ring Groove	SIZE
Top : 3.0DK 2nd : 2.5 Oil : 5.0	STD



**Cylinder Liner**

OEM NO. 6136-21-2210

Liner&Sleeve	SIZE
In Diameter : 105.0 Out Diameter : 118.7 Total length : 223.0 Flange : 127.0*10.0+1.0	STD



**Engine Bearing**

MAIN : 6136-21-8010  
CON.ROD : 6136-21-3040  
T/W : 6136-21-8050  
C/B : 6136-21-1400  
BUSH : 6138-31-3133

SIZE  
STD



**Engine Valve**

OEM NO.6130-41-4121/31  
IN 46.0 10.0 150.5  
OEM NO.6130-41-4210  
EX 40.0 10.0 150.5

SIZE  
STD

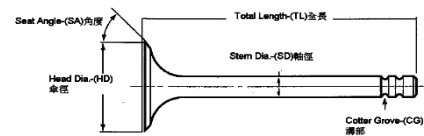

**Valve Seat**

OEM NO. 6136-12-1310  
IN 48.5 40.7 8.8  
OEM NO.6130-11-1320  
EX 44.0 34.6 9.3

SIZE  
STD

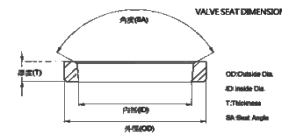

**Valve Guide**

OEM NO. 6139-19-1331/30  
IN/EX 69.7 10.0 16.0

SIZE  
STD

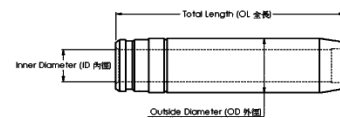

**Gasket Set**

OEM NO.



### Piston kit-Set

OEM NO. 6222-31-2116



Piston

SIZE

Comp : 68.5 w/al-fin Height : -22.0 Length : 113.0  
 Top Shape : Ø66.0  
 Direct Injection  
 Pin : 45.0 Length : 85.0

STD

### Piston Ring

OEM NO.6221-31-2200

NPR :



OEM Ring Groove

SIZE

Top : 2.5DK  
 2nd : 2.53  
 Oil : 4.0

STD

### Cylinder Liner

OEM NO. 6222-21-2210/6121-21-2220

Liner&Sleeve

SIZE

In Diameter : 108.0  
 Out Diameter : 111.5  
 Total length : 219.5  
 Flange : 125.0\*5.0+1.0

STD



### Engine Bearing

MAIN : 6221-21-8010  
 CON.ROD : 6221-31-3040  
 T/W : 6221-21-8050  
 C/B :  
 BUSH : 6221-31-3130

SIZE

STD



### Engine Valve

OEM NO.6221-41-4110  
 IN 50.0 9.0 148.5  
 OEM NO.6221-41-4210/11  
 EX 44.0 9.0 148.5

SIZE

STD

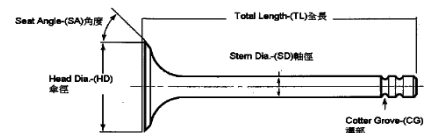

### Valve Seat

OEM NO. 6221-13-1360  
 IN 51.5 43.0 8.5  
 OEM NO.6221-11-1320  
 EX 45.5 38.0 9.0

SIZE

STD

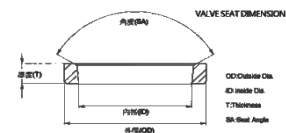

### Valve Guide

OEM NO. 6221-19-1311  
 IN/EX 59.0 9.0 14.0

SIZE

STD

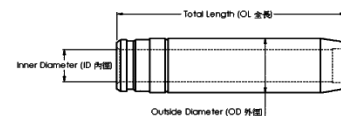

### Gasket Set

OEM NO.



**Piston kit-Set**

OEM NO. 6222-31-2110

Piston	SIZE
Comp : 66.0 w/al-fin Height : -26.0 Length : 113.0 Top Shape : Ø51.0 Direct Injection Pin : 45.0 Length : 85.0	STD



**Piston Ring**

OEM NO.6221-31-2200  
NPR :

OEM Ring Groove	SIZE
Top : 2.5DK 2nd : 2.53 Oil : 4.0	STD



**Cylinder Liner**

OEM NO. 6222-21-2210/6121-21-2220

Liner&Sleeve	SIZE
In Diameter : 108.0 Out Diameter : 111.5 Total length : 219.5 Flange : 125.0*5.0+1.0	STD



**Engine Bearing**

MAIN : 6221-21-8010  
CON.ROD : 6221-31-3040  
T/W : 6221-21-8050  
C/B :  
BUSH : 6221-31-3130

SIZE  
STD



**Engine Valve**

OEM NO.6221-41-4110  
IN 50.0 9.0 148.5  
OEM NO.6221-41-4210/6221-41-4211  
EX 44.0 9.0 148.5

SIZE  
STD

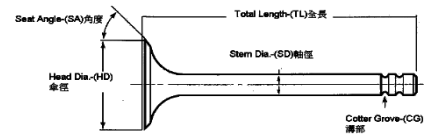

**Valve Seat**

OEM NO. 6221-13-1360  
IN 51.5 43.0 8.5  
OEM NO.6221-11-1320  
EX 45.5 38.0 9.0

SIZE  
STD

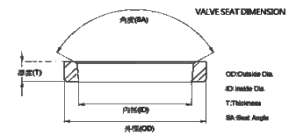

**Valve Guide**

OEM NO. 6221-19-1311  
IN/EX 59.0 9.0 14.0

SIZE  
STD

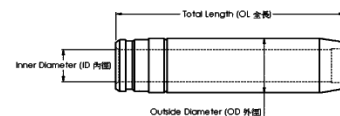

**Gasket Set**

OEM NO.



# KOMATSU

## S6D110-2

**Application :**  
**Number of Cylinders 6**  
**Cylinder dia. 110.0 MM**  
**Swept Volume 7130 ccm**

### Piston kit-Set

OEM NO. 6138-32-2120

Piston	SIZE
Comp : 69.1 w/al-fin Height : -22.0 Length : 111.0 Top Shape : Ø66.0 Direct Injection Pin : 40.0 Length : 90.0	STD



### Piston Ring

OEM NO.6138-32-2200  
 NPR :

OEM Ring Groove	SIZE
Top : 3.0DK 2nd : 2.5 Oil : 5.0	STD



### Cylinder Liner

OEM NO. 6138-21-2210

Liner&Sleeve	SIZE
In Diameter : 110.0 Out Diameter : 115.0 Total length : 225.0 Flange : 120.0*5.0+1.0 Semi/Finish	STD



### Engine Bearing

MAIN : 6136-21-8000  
 CON.ROD : 6136-31-3040  
 T/W : 6136-21-8050  
 C/B :  
 BUSH : 6136-32-3130

SIZE  
 STD



### Engine Valve

OEM NO.6136-42-4110  
 IN 47.0 9.0 148.5  
 OEM NO.6136-42-4210  
 EX 41.0 9.0 148.5

SIZE  
 STD

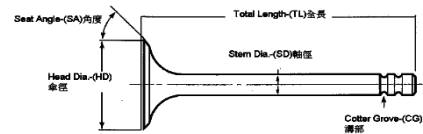

### Valve Seat

OEM NO. 6138-12-1310  
 IN 48.5 40.7 8.8  
 OEM NO. 6134-11-1320  
 EX 44.0 34.6 9.3

SIZE  
 STD

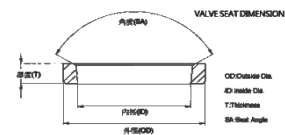

### Valve Guide

OEM NO. 6136-19-1430  
 IN/EX 68.0 9.0 16.0

SIZE  
 STD

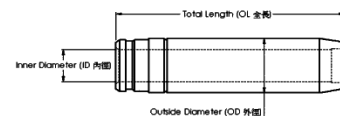

### Gasket Set

OEM NO.



### Piston kit-Set

OEM NO. 6138-31-2010

Piston	SIZE
Comp : 69.0 w/al-fin Height : -20.5 Length : 116.0 Top Shape : Ø61.6 Direct Injection Pin : 40.0 Length : 90.0	STD



### Piston Ring

OEM NO.6138-32-2200

NPR :

OEM Ring Groove	SIZE
Top : 3.0DK 2nd : 2.5 Oil : 5.0	STD



### Cylinder Liner

OEM NO. 6138-21-2210

Liner&Sleeve	SIZE
In Diameter : 110.0 Out Diameter : 115.0 Total length : 225.0 Flange : 120.0*5.0+1.0 Semi/Finish	STD



### Engine Bearing

 MAIN : 6136-21-8000  
 CON.ROD : 6136-31-3040  
 T/W : 6136-21-8050  
 C/B :  
 BUSH : 6136-32-3130

 SIZE  
  
STD

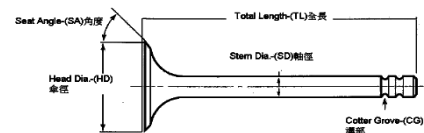

### Engine Valve

 OEM NO.6136-42-4110  
 IN 47.0 9.0 148.5  
 OEM NO.6136-42-4210  
 EX 41.0 9.0 148.5

 SIZE  
  
STD

### Valve Seat

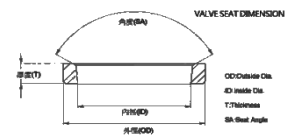
 OEM NO. 6138-12-1310  
 IN 48.5 40.7 8.8  
 OEM NO. 6134-11-1320  
 EX 44.0 34.6 9.3

 SIZE  
  
STD

### Valve Guide

 OEM NO. 6136-19-1430  
 IN/EX 68.0 9.0 16.0

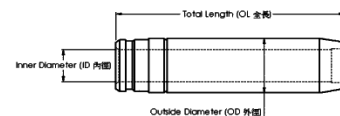
 SIZE  
  
STD

### Gasket Set

OEM NO.





### Piston kit-Set

OEM NO. 6138-32-2020



Piston

SIZE

Comp : 68.8 w/al-fin Height : -20.4 Length : 116.4  
 Top Shape : Ø62.0  
 Direct Injection  
 Pin : 40.0 Length : 90.0

STD

### Piston Ring

OEM NO.6138-32-2200

NPR :



OEM Ring Groove

SIZE

Top : 3.0DK  
 2nd : 2.5  
 Oil : 5.0

STD

### Cylinder Liner

OEM NO. 6138-21-2210

Liner&Sleeve

SIZE

In Diameter : 110.0  
 Out Diameter : 115.0  
 Total length : 225.0  
 Flange : 120.0\*5.0+1.0 Semi/Finish

STD



### Engine Bearing

MAIN : 6136-21-8000  
 CON.ROD : 6136-31-3040  
 T/W : 6136-21-8050  
 C/B :  
 BUSH : 6136-32-3130

SIZE

STD



### Engine Valve

OEM NO.6136-42-4110  
 IN 47.0 9.0 148.5  
 OEM NO.6136-42-4210  
 EX 41.0 9.0 148.5

SIZE

STD

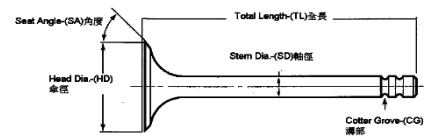

### Valve Seat

OEM NO. 6136-12-1310  
 IN  
 OEM NO. 6134-11-1320  
 EX

SIZE

STD

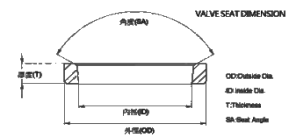

### Valve Guide

OEM NO. 6136-19-1430  
 IN/EX 68.0 9.0 16.0

SIZE

STD

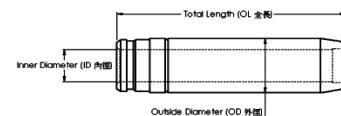

### Gasket Set

OEM NO.



**Piston kit-Set**

OEM NO. 6150-31-2113

Piston	SIZE
Comp : 80.0 w/al-fin Height : Length : 131.0 Top Shape : Ø70.0 Direct Injection Pin : 48.0 Length : 104.0	STD

**Piston Ring**

OEM NO.6150-31-2030  
NPR :

OEM Ring Groove	SIZE
Top : 2.5DK 2nd : 2.5 Oil : 4.0	STD



**Cylinder Liner**

OEM NO. 6150-21-2221

Liner&Sleeve	SIZE
In Diameter : 125.0 Out Diameter : 146.0 Total length : 293.0 Flange : 156.0*13.0+1.0	STD



**Engine Bearing**

MAIN : 6150-21-8000  
CON.ROD : 6150-31-3040  
T/W : 6150-21-8050  
C/B : 6150-21-1490  
BUSH : 6150-32-3130

SIZE  
STD



**Engine Valve**

OEM NO.6150-41-4111  
IN 45.0 9.0 169.5  
OEM NO.6150-41-4210  
EX 44.0 9.0 169.5

SIZE  
STD

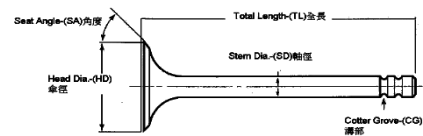

**Valve Seat**

OEM NO. 6150-11-1331  
IN 47.5 38.5 7.8  
OEM NO. 6150-11-1320  
EX 46.5 39.0 7.8

SIZE  
STD

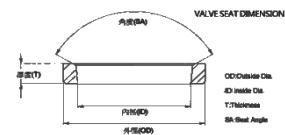

**Valve Guide**

OEM NO. 6150-12-1370/6150-12-1351  
IN/EX 67.8 9.0 16.0

SIZE  
STD

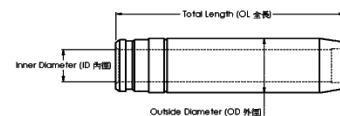

**Gasket Set**

OEM NO.



# KOMATSU S6D125(window)

**Application :**  
Number of Cylinders 6  
Cylinder dia. 125.0 MM  
Swept Volume 11040 ccm

## Piston kit-Set

OEM NO. 6151-31-2112

Piston	SIZE
Comp : 80.3 w/al-fin Height : Length : 122.3 Top Shape : Ø75.0 Direct Injection Pin : 48.0 Length : 99.0	STD



## Piston Ring

OEM NO.6150-31-2030  
NPR :

OEM Ring Groove	SIZE
Top : 2.5DK 2nd : 2.5 Oil : 4.0	STD



## Cylinder Liner

OEM NO. 6150-21-2221

Liner&Sleeve	SIZE
In Diameter : 125.0 Out Diameter : 146.0 Total length : 293.0 Flange : 156.0*13.0+1.0	STD



## Engine Bearing

MAIN : 6150-21-8000  
CON.ROD : 6150-31-3040  
T/W : 6150-21-8050  
C/B : 6150-21-1490  
BUSH : 6150-31-3130

SIZE  
STD



## Engine Valve

OEM NO.6150-41-4111  
IN 45.0 9.0 169.5  
OEM NO.6150-41-4210  
EX 44.0 9.0 169.5

SIZE  
STD

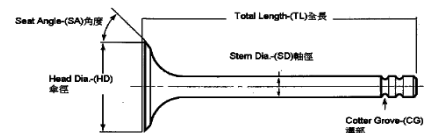

## Valve Seat

OEM NO. 6150-11-1331  
IN 47.5 38.5 7.8  
OEM NO. 6150-11-1320  
EX 46.5 39.0 7.8

SIZE  
STD

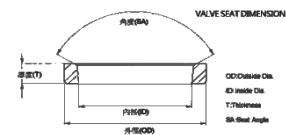

## Valve Guide

OEM NO. 6150-12-1370/6150-12-1351  
IN/EX 67.8 9.0 16.0

SIZE  
STD

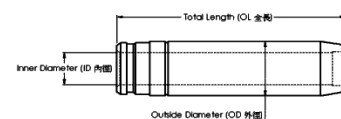

## Gasket Set

OEM NO.



# KOMATSU S6D125

**Application :**  
Number of Cylinders 6  
Cylinder dia. 125.0 MM  
Swept Volume 11040 ccm

## Piston kit-Set

OEM NO. 6151-31-2171

Piston	SIZE
Comp : 80.4 w/al-fin Height : -24.7 Length : 131.2 Top Shape : Ø75.0 Direct Injection Pin : 48.0 Length : 99.0	STD



## Piston Ring

OEM NO.6150-31-2030  
NPR :

OEM Ring Groove	SIZE
Top : 2.5DK 2nd : 2.5 Oil : 4.0	STD



## Cylinder Liner

OEM NO. 6150-21-2221

Liner&Sleeve	SIZE
In Diameter : 125.0 Out Diameter : 146.0 Total length : 293.0 Flange : 156.0*13.0+1.0	STD



## Engine Bearing

MAIN : 6150-21-8000  
CON.ROD : 6150-31-3040  
T/W : 6150-21-8050  
C/B : 6150-21-1490  
BUSH : 6150-31-3130

SIZE  
STD



## Engine Valve

OEM NO.6150-41-4111  
IN 45.0 9.0 169.5  
OEM NO.6150-41-4210  
EX 44.0 9.0 169.5

SIZE  
STD

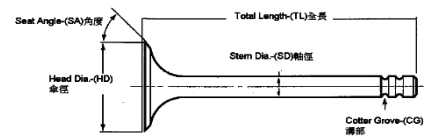

## Valve Seat

OEM NO. 6150-11-1331  
IN 47.5 38.5 7.8  
OEM NO. 6150-11-1320  
EX 46.5 39.0 7.8

SIZE  
STD

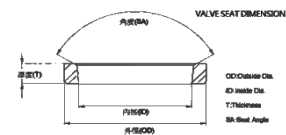

## Valve Guide

OEM NO. 6150-12-1370/6150-12-1351  
IN/EX 67.8 9.0 16.0

SIZE  
STD

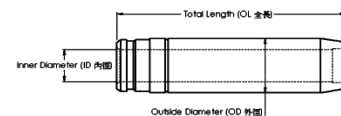

## Gasket Set

OEM NO.



# KOMATSU S6D125 New

**Application :**  
**Number of Cylinders 6**  
**Cylinder dia. 125.0 MM**  
**Swept Volume 11040 ccm**

## Piston kit-Set

OEM NO. 6151-31-2511



Piston

SIZE

Comp : 80.3 cast iron Height : -26.3 Length : 117.2  
 Top Shape : Ø75.0  
 Direct Injection  
 Pin : 48.0 Length : 99.0

STD

## Piston Ring

OEM NO.6150-31-2030

NPR :



OEM Ring Groove

SIZE

Top : 2.5DK  
 2nd : 2.5  
 Oil : 4.0

STD

## Cylinder Liner

OEM NO. 6150-21-2221

Liner&Sleeve

SIZE

In Diameter : 125.0  
 Out Diameter : 146.0  
 Total length : 293.0  
 Flange : 156.0\*13.0+1.0

STD



## Engine Bearing

MAIN : 6150-21-8000  
 CON.ROD : 6150-31-3040  
 T/W : 6150-21-8050  
 C/B : 6150-21-1490  
 BUSH : 6150-31-3130

SIZE

STD



## Engine Valve

OEM NO.6150-41-4111  
 IN 45.0 9.0 169.5  
 OEM NO.6150-41-4210  
 EX 44.0 9.0 169.5

SIZE

STD

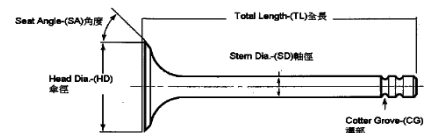

## Valve Seat

OEM NO. 6150-11-1331  
 IN 47.5 38.5 7.8  
 OEM NO. 6150-11-1320  
 EX 46.5 39.0 7.8

SIZE

STD

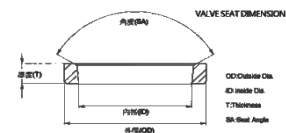

## Valve Guide

OEM NO. 6150-12-1370/6150-12-1351  
 IN/EX 67.8 9.0 16.0

SIZE

STD

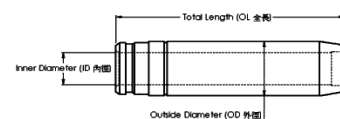

## Gasket Set

OEM NO.



### Piston kit-Set

OEM NO. 6152-31-2112

Piston	SIZE
Comp : 80.5 w/al-fin Height : -26.8 Length : 131.0 Top Shape : Ø62.0 Direct Injection Pin : 48.0 Length : 104.0	STD



### Piston Ring

OEM NO.6150-31-2030  
NPR :

OEM Ring Groove	SIZE
Top : 2.5DK 2nd : 2.5 Oil : 4.0	STD



### Cylinder Liner

OEM NO. 6150-21-2221

Liner&Sleeve	SIZE
In Diameter : 125.0 Out Diameter : 146.0 Total length : 293.0 Flange : 156.0*13.0+1.0	STD



### Engine Bearing

MAIN : 6150-21-8000  
CON.ROD : 6150-31-3040  
T/W : 6150-21-8050  
C/B : 6150-21-1490  
BUSH : 6150-31-3130

SIZE  
STD



### Engine Valve

OEM NO.6150-41-4111  
IN 45.0 9.0 169.5  
OEM NO.6150-41-4210  
EX 44.0 9.0 169.5

SIZE  
STD

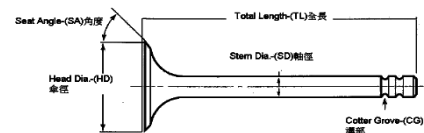

### Valve Seat

OEM NO. 6150-11-1331  
IN 47.5 38.5 7.8  
OEM NO. 6150-11-1320  
EX 46.5 39.0 7.8

SIZE  
STD

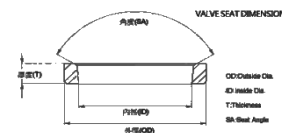

### Valve Guide

OEM NO. 6150-12-1370/6150-12-1351  
IN/EX 67.8 9.0 16.0

SIZE  
STD

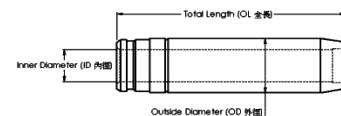

### Gasket Set

OEM NO.



# KOMATSU S6D125

**Application :**  
**Number of Cylinders 6**  
**Cylinder dia. 125.0 MM**  
**Swept Volume 11040 ccm**

## Piston kit-Set

OEM NO. 6152-32-2610

Piston	SIZE
Comp : 80.25 w/al-fin Height : -24.2 Length : 131.0 Top Shape : Ø66.4 Direct Injection Pin : 48.0 Length : 104.0	STD

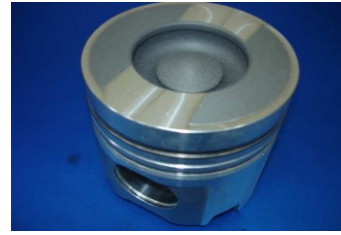

## Piston Ring

OEM NO.6150-31-2030

NPR :

OEM Ring Groove	SIZE
Top : 2.5DK 2nd : 2.5 Oil : 4.0	STD



## Cylinder Liner

OEM NO. 6150-21-2221

Liner&Sleeve	SIZE
In Diameter : 125.0 Out Diameter : 146.0 Total length : 293.0 Flange : 156.0*13.0+1.0	STD



## Engine Bearing

MAIN : 6150-21-8000  
 CON.ROD : 6150-31-3040  
 T/W : 6150-21-8050  
 C/B : 6150-21-1490  
 BUSH : 6150-31-3130

SIZE

STD



## Engine Valve

OEM NO.6150-41-4111  
 IN 45.0 9.0 169.5  
 OEM NO.6150-41-4210  
 EX 44.0 9.0 169.5

SIZE

STD

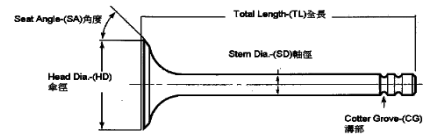

## Valve Seat

OEM NO. 6150-11-1331  
 IN 47.5 38.5 7.8  
 OEM NO. 6150-11-1320  
 EX 46.5 39.0 7.8

SIZE

STD

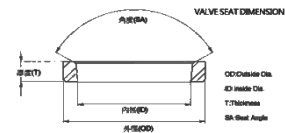

## Valve Guide

OEM NO. 6150-12-1370/6150-12-1351  
 IN/EX 67.8 9.0 16.0

SIZE

STD

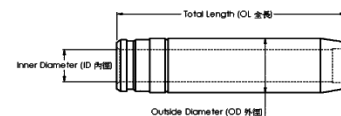

## Gasket Set

OEM NO.



### Piston kit-Set

OEM NO. 6152-32-2510

Piston	SIZE
Comp : 80.3 Csat Iron Height : -28.5 Length : 117.5 Top Shape : Ø63.1 Direct Injection Pin : 48.0 Length : 99.0	STD



### Piston Ring

OEM NO.6150-31-2032  
NPR : SDK04-022ZZ

OEM Ring Groove	SIZE
Top : 2.5DK 2nd : 2.5 Oil : 4.0	STD



### Cylinder Liner

OEM NO. 6150-21-2221

Liner&Sleeve	SIZE
In Diameter : 125.0 Out Diameter : 146.0 Total length : 293.0 Flange : 156.0*13.0+1.0	STD



### Engine Bearing

MAIN : 6150-21-8000  
CON.ROD : 6150-31-3040  
T/W : 6150-21-8050  
C/B : 6150-21-1490  
BUSH : 6150-31-3130

SIZE  
STD



### Engine Valve

OEM NO.6150-41-4111/6150-42-4110  
IN 45.0 9.0 169.5  
OEM NO.6150-41-4210  
EX 44.0 9.0 169.5

SIZE  
STD

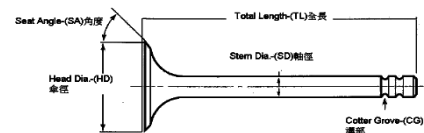

### Valve Seat

OEM NO. 6150-11-1331  
IN 47.5 38.7 7.8  
OEM NO. 6150-11-1320  
EX 46.5 39.0 7.8

SIZE  
STD

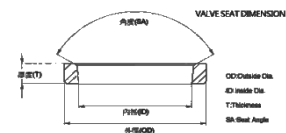

### Valve Guide

OEM NO. 6150-12-1370  
IN/EX 67.8 9.0 16.0

SIZE  
STD

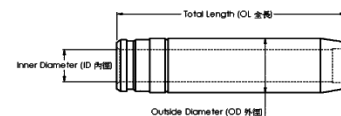

### Gasket Set

OEM NO.





**Piston kit-Set**

OEM NO. 6211-32-2130/6212-31-2151



Piston	SIZE
Comp : 85.3 Csat Iron Height : -32.3 Length : 125.3 Top Shape : Ø78.9 Direct Injection Pin : 52.0 Length : 110.0	STD

**Piston Ring**

OEM NO.6211-31-2031  
NPR :



OEM Ring Groove	SIZE
Top : 2.4DK 2nd : 2.4 Oil : 4.0	STD

**Cylinder Liner**

OEM NO. 6211-21-2210



Liner&Sleeve	SIZE
In Diameter : 140.0 Out Diameter : 158.0 Total length : 283.0 Flange : 170.5*11.0	STD

**Engine Bearing**

MAIN : 6210-21-8000  
CON.ROD : 6127-31-3041  
T/W : 6127-21-8511  
C/B : 6127-21-1410  
BUSH : 6127-31-3130



	SIZE
	STD

**Engine Valve**

OEM NO.6215-41-4110  
IN 52.0 10.0 169.2  
OEM NO.6215-41-4212  
EX 50.0 10.0 169.2

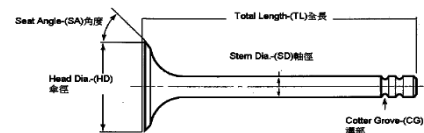

	SIZE
	STD

**Valve Seat**

OEM NO. 6210-11-1330  
IN 55.0 44.7 9.1  
OEM NO. 6210-11-1321  
EX 52.0 43.0 8.9

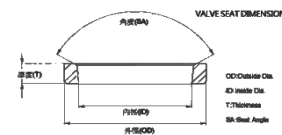

	SIZE
	STD

**Valve Guide**

OEM NO. 6212-16-1440  
IN/EX 72.3 10.0 16.0

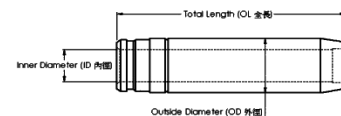

	SIZE
	STD

**Gasket Set**

OEM NO.



**Piston kit-Set**

OEM NO. 6212-31-2170



Piston

SIZE

Comp : 85.2 Csat Iron Height : -29.3 Length : 125.0  
Top Shape : Ø92.0  
Direct Injection  
Pin : 52.0 Length : 110.0

STD

**Piston Ring**

OEM NO.6211-31-2031

NPR :



OEM Ring Groove

SIZE

Top : 2.4DK  
2nd : 2.4  
Oil : 4.0

STD

**Cylinder Liner**

OEM NO. 6211-21-2210

Liner&Sleeve

SIZE

In Diameter : 140.0  
Out Diameter : 158.0  
Total length : 283.0  
Flange : 170.5\*11.0

STD



**Engine Bearing**

MAIN : 6210-21-8000  
CON.ROD : 6127-31-3041  
T/W : 6127-21-8511  
C/B : 6127-21-1410  
BUSH : 6127-31-3130

SIZE

STD



**Engine Valve**

OEM NO.6215-41-4110  
IN 52.0 10.0 169.2  
OEM NO.6215-41-4212  
EX 50.0 10.0 169.2

SIZE

STD

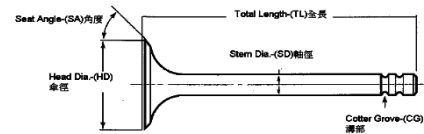

**Valve Seat**

OEM NO. 6210-11-1330  
IN 55.0 44.7 9.1  
OEM NO. 6210-11-1321  
EX 52.0 43.0 8.9

SIZE

STD

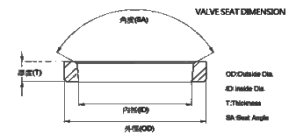

**Valve Guide**

OEM NO. 6212-16-1440  
IN/EX 72.3 10.0 16.0

SIZE

STD

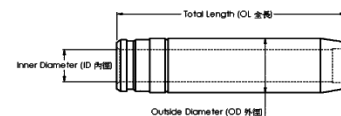

**Gasket Set**

OEM NO.



**Piston kit-Set**

OEM NO. 6217-31-2130



Piston

SIZE

Comp : 85.5 Csat Iron Height : -32.2 Length : 125.3  
Top Shape : Ø76.7  
Direct Injection  
Pin : 52.0 Length : 110.0

STD

**Piston Ring**

OEM NO.6211-31-2031  
NPR : SDK04-028ZZ



OEM Ring Groove

SIZE

Top : 2.4DK  
2nd : 2.4  
Oil : 4.0

STD

**Cylinder Liner**

OEM NO. 6111-21-2210



Liner&Sleeve

SIZE

In Diameter : 140.0  
Out Diameter : 158.3  
Total length : 283.0  
Flange : 170.5\*11.0

STD

**Engine Bearing**

MAIN : 6210-21-8000  
CON.ROD : 6127-31-3041  
T/W : 6127-21-8511  
C/B : 6127-21-1410  
BUSH : 6127-31-3130

SIZE



STD

**Engine Valve**

OEM NO.6215-41-4110  
IN 52.0 10.0 169.2  
OEM NO.6215-41-4212  
EX 50.0 10.0 169.5

SIZE

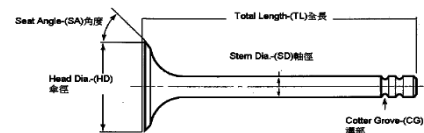

STD

**Valve Seat**

OEM NO. 6210-11-1330  
IN 55.0 44.7 9.1  
OEM NO. 6210-11-1321  
EX 52.0 43.0 8.9

SIZE

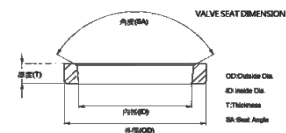

STD

**Valve Guide**

OEM NO. 6210-16-1340  
IN/EX 72.3 10.0 16.0

SIZE

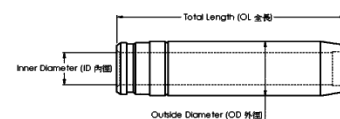

STD

**Gasket Set**

OEM NO.





# KOMATSU S6D170

**Application :**  
**Number of Cylinders 6**  
**Cylinder dia. 170.0 MM**  
**Swept Volume 23150 ccm**

## Piston kit-Set

OEM NO. 6162-33-2120

Piston	SIZE
Comp : 119.7 Height : - oil-cooled Length : 195.3 Top Shape : Ø126.0 Direct Injection/Head Anodized Pin : 68.0 Length : 142.0	STD



## Piston Ring

OEM NO.  
NPR :

OEM Ring Groove	SIZE
Top : 4.0DK 2nd : 4.0 Oil : 5.0	STD



## Cylinder Liner

OEM NO. 6162-23-2210

Liner&Sleeve	SIZE
In Diameter : 170.0 Out Diameter : 190.3 Total length : 342.0 Flange : 206.0*14.0+2.0	STD



## Engine Bearing

MAIN :	SIZE
CON.ROD :	STD
T/W :	
C/B :	
BUSH :	



## Engine Valve

OEM NO.6162-43-4110	SIZE
IN 57.0 12.0 196.4	STD
OEM NO.6162-43-4210	
EX 56.0 12.0 196.5	

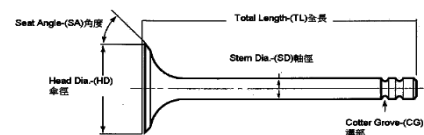

## Valve Seat

OEM NO. 6162-11-1330	SIZE
IN 63.0 50.0 8.5	STD
OEM NO. 6162-11-1332	
EX 61.0 47.9 8.7	

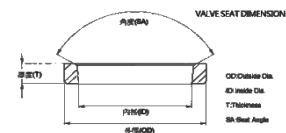

## Valve Guide

OEM NO. 6162-13-1341	SIZE
IN/EX 101.0 12.0 19.0	STD

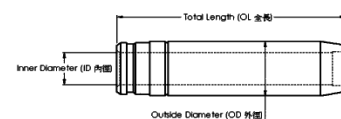

## Gasket Set

OEM NO.



# KOMATSU S6D170

**Application :**  
**Number of Cylinders 6**  
**Cylinder dia. 170.0 MM**  
**Swept Volume 23150 ccm**

## Piston kit-Set

OEM NO. 6162-33-2140



Piston

SIZE

Comp : 120.6 w/al-fin Height : -23.3 oil-cooled Length : 195.5  
 Top Shape : Ø123.0  
 Direct Injection/Head Anodized  
 Pin : 68.0 Length : 142.3

STD

## Piston Ring

OEM NO.  
 NPR :



OEM Ring Groove

SIZE

Top : 4.0DK  
 2nd : 3.8  
 Oil : 4.75

STD

## Cylinder Liner

OEM NO. 6162-23-2210



Liner&Sleeve

SIZE

In Diameter : 170.0  
 Out Diameter : 190.3  
 Total length : 342.0  
 Flange : 206.0\*14.0+2.0

STD

## Engine Bearing

MAIN :  
 CON.ROD :  
 T/W :  
 C/B :  
 BUSH :



SIZE

STD

## Engine Valve

OEM NO.6162-43-4110  
 IN 57.0 12.0 196.4  
 OEM NO.6162-43-4210  
 EX 56.0 12.0 196.5

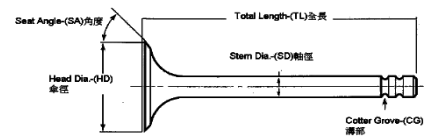

SIZE

STD

## Valve Seat

OEM NO. 6162-11-1330  
 IN 63.0 50.0 8.5  
 OEM NO. 6162-11-1332  
 EX 61.0 47.9 8.7

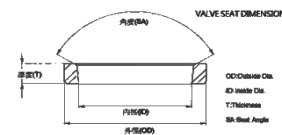

SIZE

STD

## Valve Guide

OEM NO. 6162-13-1341  
 IN/EX 101.0 12.0 19.0

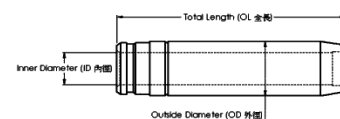

SIZE

STD

## Gasket Set

OEM NO.



**Piston kit-Set**

OEM NO. 6271-31-2300



Piston

SIZE

Comp : 50.8 w/al-fin Height : -17.7 Length : 83.8  
Top Shape : Ø45.7  
Direct Injection  
Pin : 30.0 Length : 74.0

STD

**Piston Ring**

OEM NO.  
NPR :



OEM Ring Groove

SIZE

Top : 2.5DK  
2nd : 2.0  
Oil : 3.0

STD

**Cylinder Liner**

OEM NO.



Liner&Sleeve

SIZE

In Diameter :  
Out Diameter :  
Total length :  
Flange :

STD

**Engine Bearing**

MAIN :  
CON.ROD :  
T/W :  
C/B :  
BUSH :



SIZE

STD

**Engine Valve**

OEM NO.  
IN  
OEM NO.  
EX

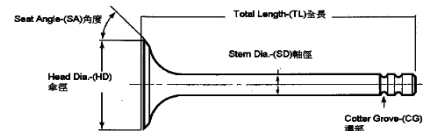

SIZE

STD

**Valve Seat**

OEM NO.  
IN  
OEM NO.  
EX

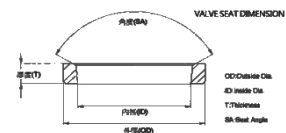

SIZE

STD

**Valve Guide**

OEM NO.  
IN  
OEM NO.  
EX

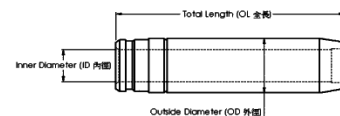

SIZE

STD

**Gasket Set**

OEM NO.

