



Taiwan Excellent Auto Engine Parts
Warranty for

2 Year / 20,000 km

MAZDA

Diesel Engine Parts

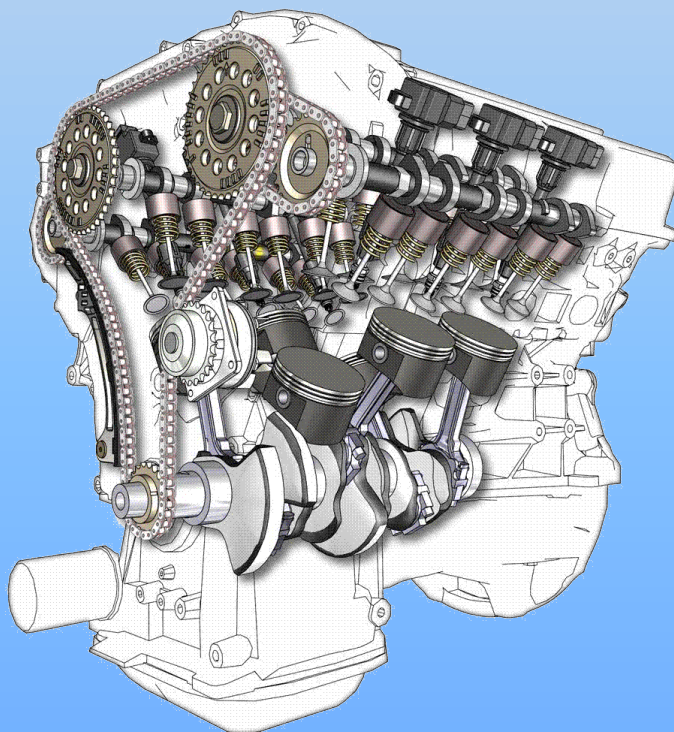

Contact Person: Mr. Jacky Tsai
Email 1: eton.jacky@msa.hinet.net
Email 2: valveparts2866@gmail.com
Tel : (8864) 2293-6969
Fax : (8864) 2293-7070
No. 90, Wenchang 1st St., North District,
Taichung City, Taiwan. 40464

E & T SCIENCE INC.

ISO/TS 16949
QS9000



PISTON TERMINOLOGY

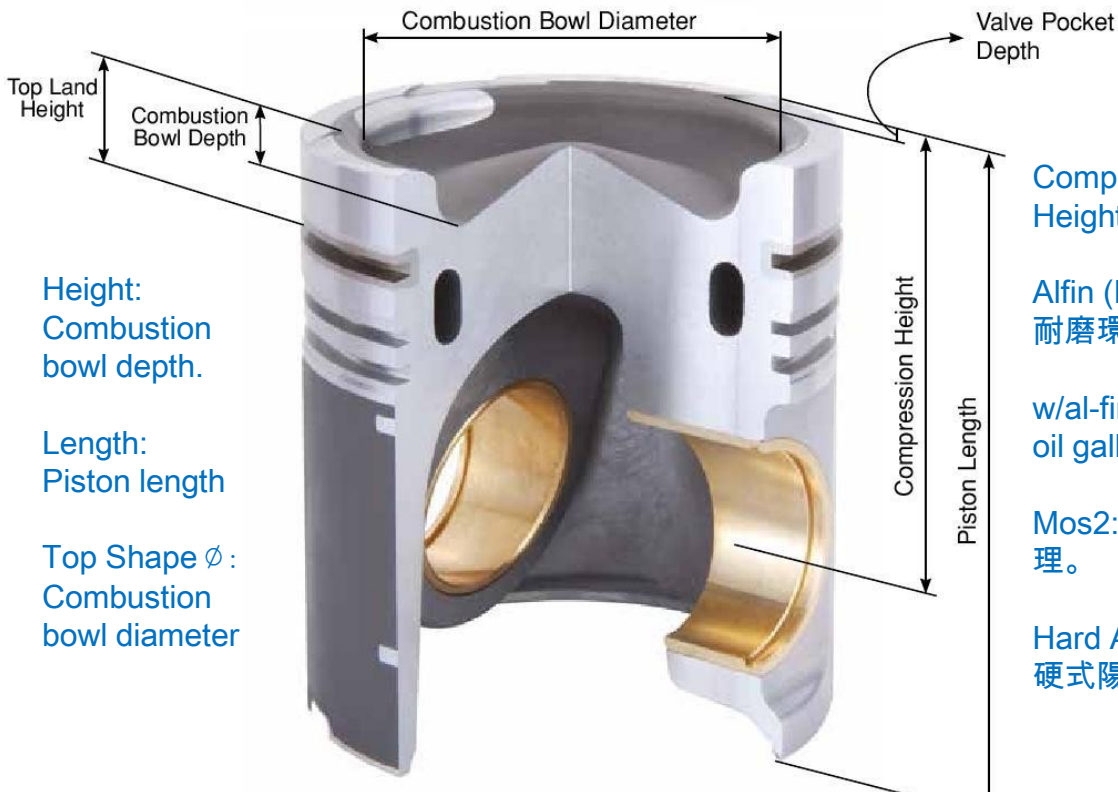
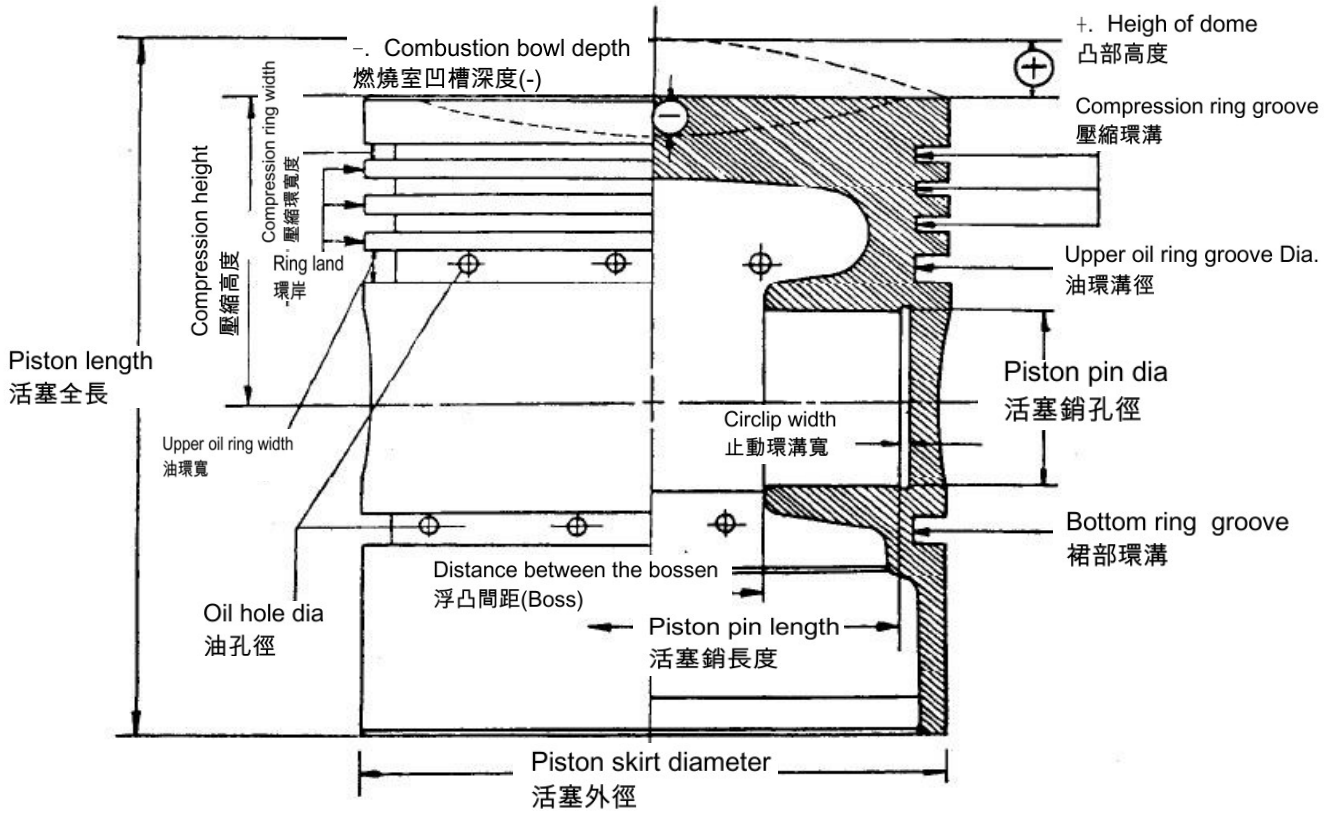



PISTON RING TERMINOLOGY

Free Ring(Unstressed)

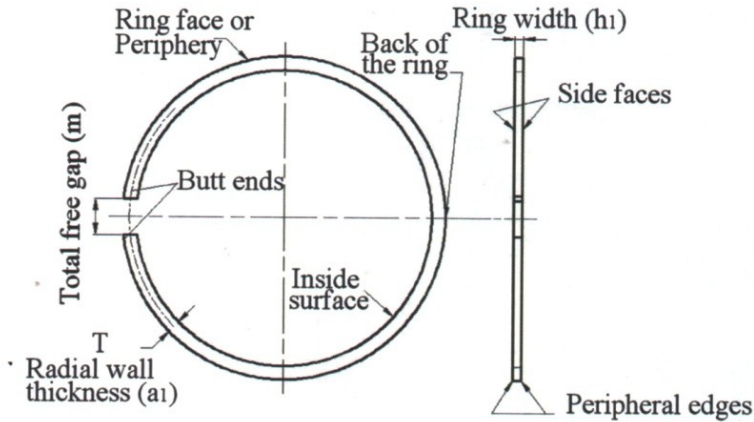

Closed Ring

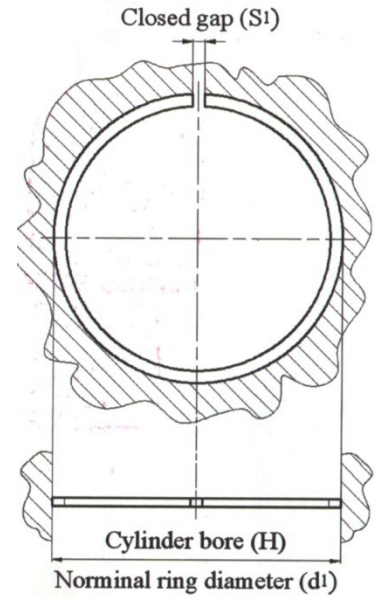

Compression Ring

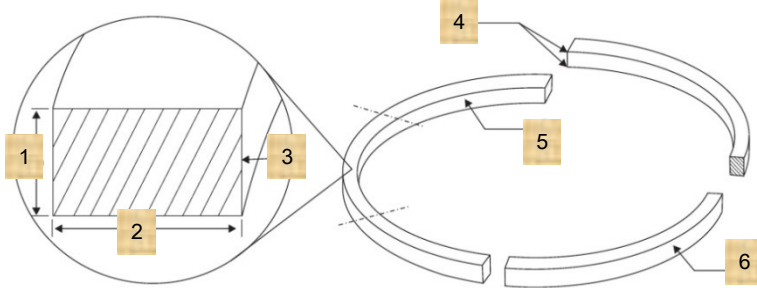

- 1. Piston ring width
- 2. Piston ring thickness
- 3. Inside edge of gap
- 4. Inside edges
- 5. Inside surface
- 6. Peripheral surface

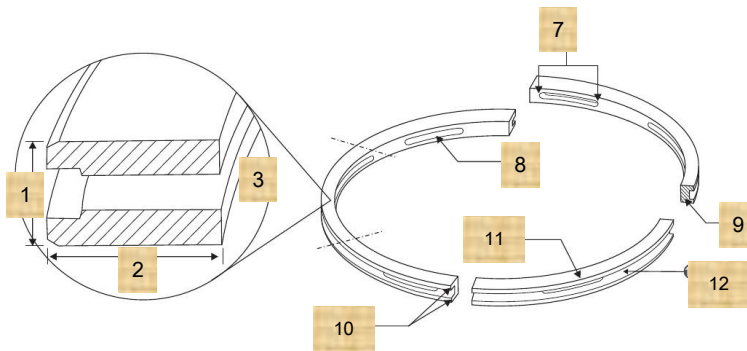

- 7. Inside edges of slot
- 8. Slot face
- 9. Gap face
- 10. Outside gap corners
- 11. Side face
- 12. Outside groove face

Oil Control Ring



LINER/SLEEVE TERMINOLOGY

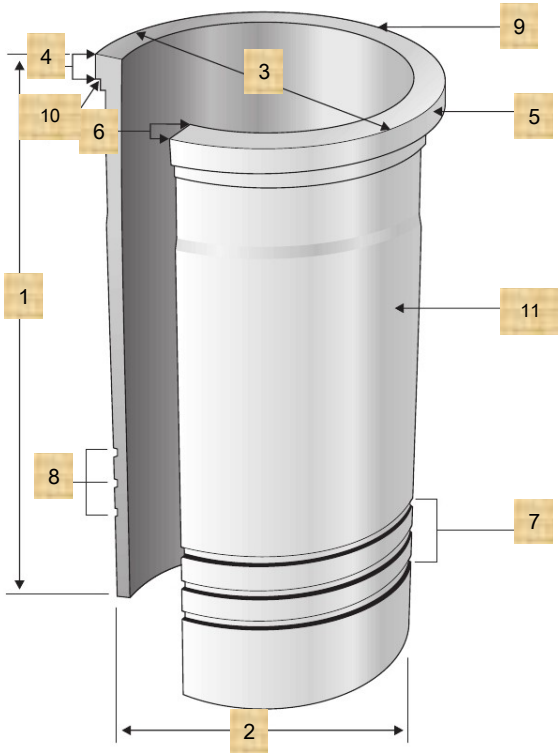

- 1. Total length
- 2. Outside diameter
- 3. Flange diameter
(Register diameter)
- 4. Flange depth
(Collar height)
- 5. Flange
- 6. Top land width
- 7. Sealing area
- 8. O-Ring groove
- 9. Firewall
- 10. Machining relief
- 11. Barel



Wet Cylinder Liner

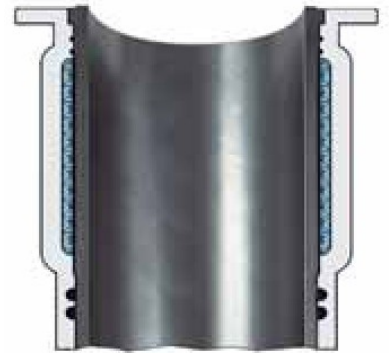

Dry Cylinder Liner

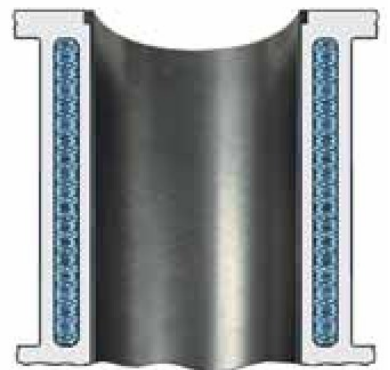



BEARINGS TERMINOLOGY



Rocker arm bushes



Con rod bushes



Connecting rod bearing



Main bearing



Flanged bearing



Thrust washers



Camshaft bearing

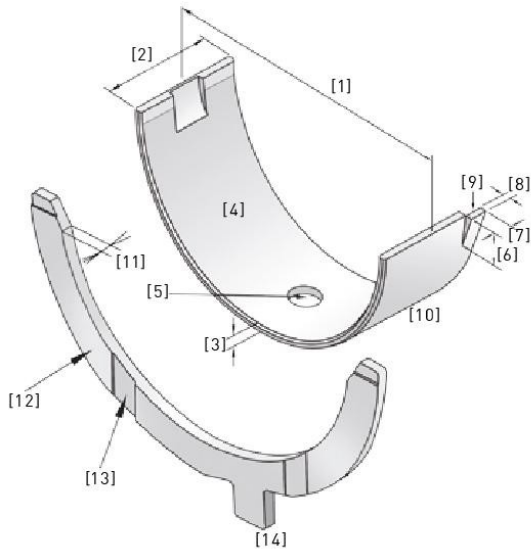

Bearing Shell

1. Free spread
2. Bearing length
3. Bearing wall thickness
4. Bearing surface
5. Lubrication hole
6. Length of locating lug
7. Width of locating lug
8. Height of locating lug
9. Locating lug relief
10. Bearing back

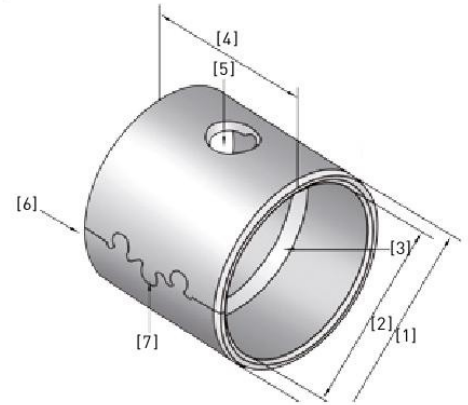

Bushing

1. Outside diameter
2. Inside diameter
3. Oil groove
4. Bushing length
5. Lubrication hole
6. Joint
7. Clinch

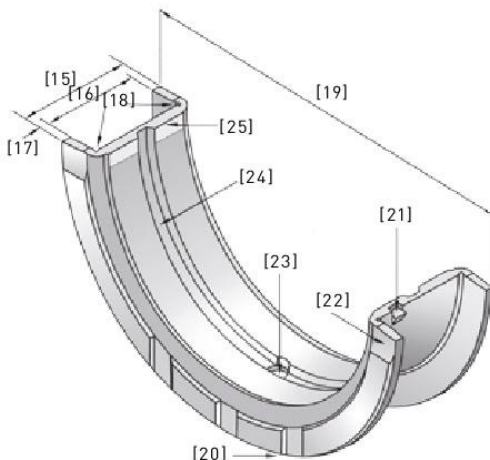

Flange Bearing

15. Flange bearing length
16. Distance between flange
17. Flange thickness
18. Flange relief grooves
19. Flange diameter
20. Relief at joint face
21. Locating lug
22. Relief at joint face
23. Lubrication hole
24. Oil groove
25. Relief at surface
26. Flange and Bearing assembly

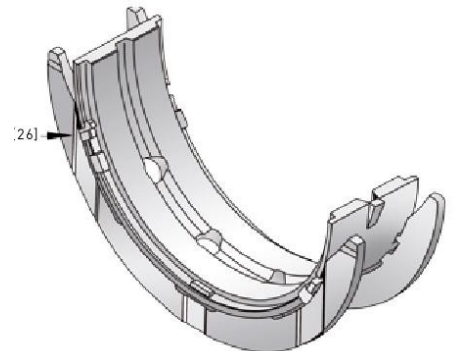



ENGINE VALVE SPECIFICATION

ENGINE VALVE DIMENSION

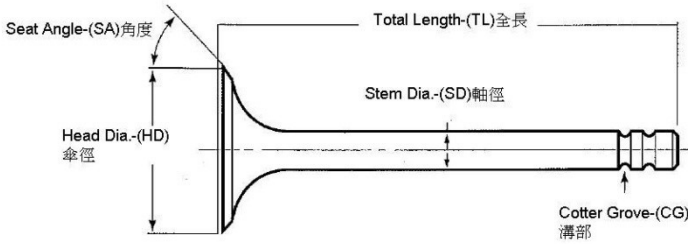

Stem Top Hardness:
HRC 45~60

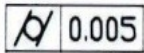

Roundness Tolerance
≤0.005mm

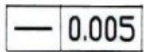

Straightness Tolerance
≤0.005mm

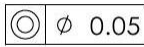

Concentricity Tolerance
≤0.05mm

SPECIFICATION



SHAPE OF COTTER GROOVE (CG)

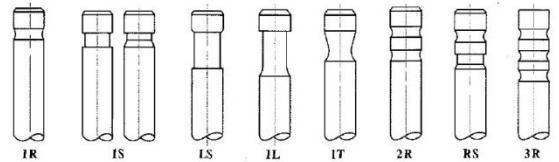

引擎汽門 (Engine Valve) 使用鋼材對照

材料代號對照					材料化學成分								適用於
Martensitic Steel 麻田散鐵													IN/EX
ISO	JIS	SAE	DIN/BS	大陸	C	Si	Mn	P	S	Ni	Cr	Mo	
42CrMo4	SCM440	4140	EN49		0.43	0.35	0.85				1.2	0.3	
X45CrSi93	SUH1	HNV3	X45CrSi9 3	45Cr9Si3	0.4-0.5	3.0-3.5	≤0.60	≤0.03	≤0.03	≤0.5	7.5-9.0		
	SUH3		X40CrSiMo10-2	40Cr10Si2Mo	0.30-0.45	1.8-2.5	≤0.60	≤0.03	≤0.03	≤0.6	10.0-12.0	0.7-1.3	
	SUH4(XB)	ENV6	EN59	80Cr20Si2Ni	0.75-0.85	1.75-2.25	0.2-0.6	≤0.03	≤0.03	1.15-1.65	19.0-20.5		
X50CrSi82	SUH11	HNV3	EN52	51Cr8Si2	0.45-0.55	1.0-2.0	≤0.60	≤0.03	≤0.03		7.5-9.5		
Austenitic Steel 奧斯田鐵 Non-magnetic													EX
	SUH31	EV9		45Cr14Ni14W2Mo	0.3-0.45	1.5-2.5	≤0.60	≤0.04	≤0.03	13.0-15.0	14.0-16.0		
X53CrMnNiN214	SUH35(21-4N)	EV8	349S54	53Cr21Mn9Ni4N	0.58	≤0.35	8.0-10.0	≤0.01	≤0.03	3.25-4.5	20.0-22.0		
	SUH37(21-12N)	EV4	381S34	20Cr21Ni12N	0.15-0.25	0.75-1.0	1.0-1.5	≤0.025	≤0.025	10.5-12.5	20.0-22.0		
	SUH38				0.25-0.35	≤1.0	≤1.2	0.18-0.25	≤0.03	10.0-12.0	19.0-21.0	1.8-2.5	
Nickel Basic alloy 鎳基合金													EX
NiCr20TiAl	NiMonic 80A	2.4952(HEV5)		GH4080A	0.10max	1.0	1.0		Fe 3.0 max	65.0min	18.0-21.0	Al 1.0-1.5	
NiCr15Fe7TiAl	751	2.4669(HEV3)	NiCr15FeTiAl	GH4751									

STELLITE 鈷鉻鎢合金鋼 (軸端與盤面焊補材質)						
	C	Cr	W	Fe	Co	HRC
Stellite #1	2.5	30.0	12.0	3.0 Max	Balance	54
Stellite #6	1.0	28.0	4.0	3.0 Max	Balance	44
Stellite #12	1.35	29.0	8.0	2.0	Balance	47



VALVE SEAT & GUIDE SPECIFICATION

Valve Seat:
High Chrome Alloy Steel
Hardness :HRC 36~47

- 0.03 Parallelism Tolerance $\leq 0.03\text{mm}$
- 0.012 Verticality Tolerance $\leq 0.012\text{mm}$
- ϕ 0.05 Concentricity Tolerance $\leq 0.05\text{mm}$

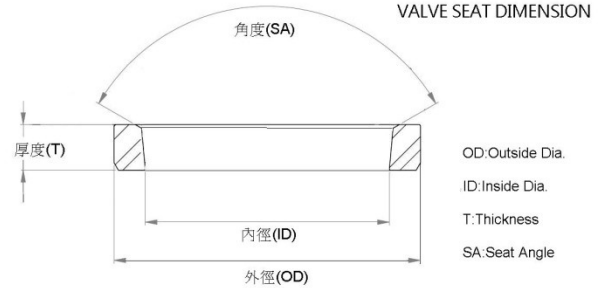

Valve Seat Material

汽門座圈材料成份表

材質:高鉻合金High Chrome Alloy Steel(耐熱合金鑄造鋼)



	C	Si	Mn	P	S	Cr	Mo	Ni	V	Hardness 硬度HRC
高鉻合金 High Chrome Alloy Steel	1.5~2.0	1.5~2.0	0.6~1.2	≤ 0.10	≤ 0.10	13.5~15	0.35~0.5			36~47

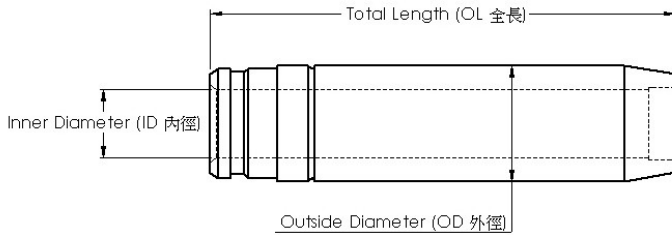

(mm)	Inlet valve (μm)	Exhaust valve (μm)
Stem dia. 6 - 7	10 - 40	25 - 55
Stem dia. 8 - 9	20 - 50	35 - 65
Stem dia. 10 - 12	40 - 70	55 - 85

Valve Guide: Cast Iron FC25

Hardness :HRB 92~102°

- Surface finish Ra $\leq 0.8\mu\text{m}$
- Inner diameter tolerance $\leq 0.01\text{mm}$
- Outer diameter tolerance $\leq 0.01\text{mm}$
- Concentricity diameter tolerance $\leq 0.05\text{mm}$

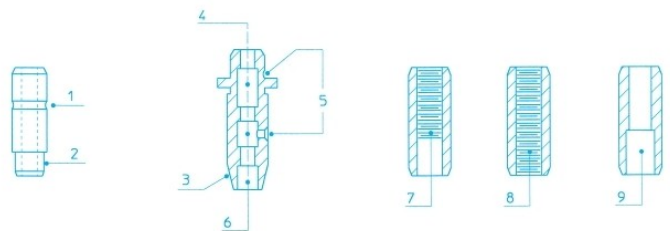

- 1.Outer groove for snap ring
- 2.Narrower end
- 3.Conical end
- 4.Recessd area in the bore
- 5.Lubrifation holes
- 6.Counterbore at end of guides
- 7/8.Lubrifation threads
- 9.Counter bore

ϕ 0.05

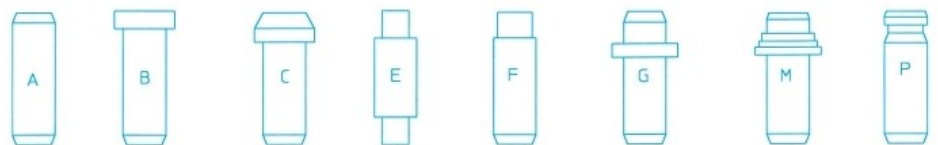

MAZDA WL(B2500)

Application : TRUCK
Number of Cylinders 4
Cylinder dia. 93.0 MM
Swept Volume 2499 ccm

Piston kit-Set

OEM NO. WLY3-11-SAOC

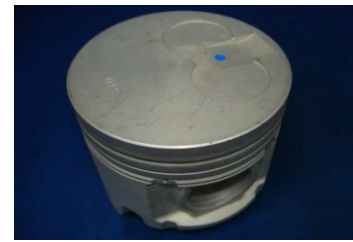

Piston

SIZE

Comp : 47.8 w/al-fin Height : -1.2 Length : 87.4
Top Shape : Flower
Pin : 32.0
Length : 72.0

STD

Piston Ring

OEM NO. WLY1-11-SCO
NPR : SDT20-061ZY



OEM Ring Groove

SIZE

Top : 2.5
2nd : 2.0
Oil : 3.0

STD

Cylinder Liner

OEM NO. WL01-10-311



Liner&Sleeve

SIZE

In Diameter : 92.0
Out Diameter : 96.9
Total length : 166.6
Flange : 101.0*3.85

STD

Engine Bearing

MAIN : WLY1-11-SGO
CON.ROD : WLY1-11-SEO
T/W : WLY1-11-SJO
C/B :
BUSH : WL01-11-213



SIZE

STD

Engine Valve

OEM NO. WL01-12-111
IN 32.7 7.0 112.0
OEM NO. WL01-12-121A
EX 35.5 7.0 112.0

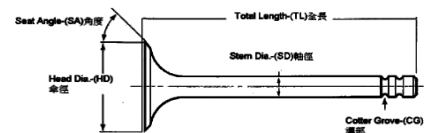

SIZE

STD

Valve Seat

OEM NO.
IN
OEM NO.
EX

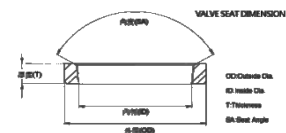

SIZE

STD

Valve Guide

OEM NO. WLY1-10-280
IN/EX 46.0 7.0 12.0

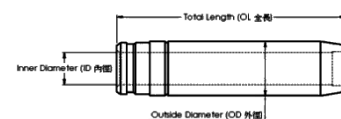

SIZE

STD

Gasket Set

OEM NO.



MAZDA E2200 S2

Application : TRUCK
Number of Cylinders 4
Cylinder dia. 88.9 MM
Swept Volume 2209 ccm

Piston kit-Set

OEM NO. 1456-23-200



Piston	SIZE
Comp : 50.7 Height : -2.6 Length : 94.7 Top Shape : Flower Pin : 28.0 Length : 73.5	STD

Piston Ring

OEM NO. 1456-23-206
NPR : SDT20-032ZX



OEM Ring Groove	SIZE
Top : 2.38 2nd : 2.38 Oil : 4.76	STD

Cylinder Liner

OEM NO. 1456-23-051



Liner&Sleeve	SIZE
In Diameter : 88.9 Out Diameter : 96.9 Total length : 167.5 Flange : 101.0*3.8+1.0	STD

Engine Bearing

MAIN : 1456-23-110
CON.ROD : 1456-23-105A
T/W : 1456-23-115
C/B :
BUSH : S213-11-213



	SIZE
	STD

Engine Valve

OEM NO. 0636-12-111
IN 40.5 8.0 114.5
OEM NO. 0636-12-121
EX 35.5 8.0 114.5

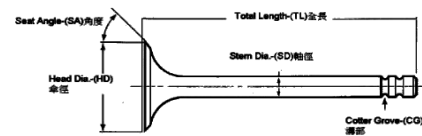

	SIZE
	STD

Valve Seat

OEM NO.
IN
OEM NO.
EX

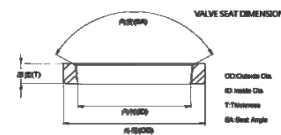

	SIZE
	STD

Valve Guide

OEM NO. 0636-10-104B
IN/EX 53.85 8.0 12.7

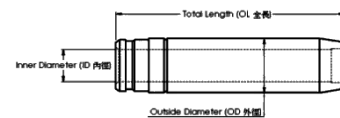

	SIZE
	STD

Gasket Set

OEM NO.



MAZDA XA E2500

Application : TRUCK
Number of Cylinders 4
Cylinder dia. 88.9 MM
Swept Volume 2522 ccm

Piston kit-Set

OEM NO. 0559-99-111/0559-23-200

Piston	SIZE
Comp : 60.6 Height : Length : 116.0 Top Shape : Pin : 31.75 Length : 75.0	STD

Piston Ring

OEM NO. 0559-23-206
 NPR : SCT20-016ZZ

OEM Ring Groove	SIZE
Top : 2.38 2nd : 2.38 3nd : 2.38 Oil : 4.76/4.76	STD



Cylinder Liner

OEM NO. 0636-10-311

Liner&Sleeve	SIZE
In Diameter : 88.9 Out Diameter : 96.9 Total length : 191.0 Flange : 101.0*3.8+0.8	STD



Engine Bearing

MAIN : 0527-23-110
 CON.ROD : 0527-23-105
 T/W : 0636-23-115
 C/B :
 BUSH : 0636-11-213

SIZE

STD



Engine Valve

OEM NO. 0636-12-111
 IN 40.5 8.0 114.5
 OEM NO. 0636-12-121
 EX 35.5 8.0 114.5

SIZE

STD

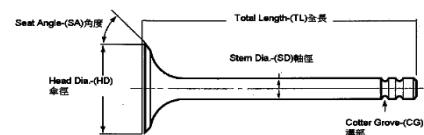

Valve Seat

OEM NO.
 IN
 OEM NO.
 EX

SIZE

STD

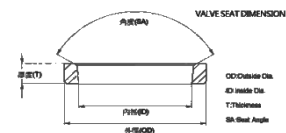

Valve Guide

OEM NO. 0636-10-104B
 IN/EX 53.9 8.0 12.7

SIZE

STD

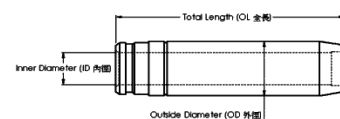

Gasket Set

OEM NO.



MAZDA XA E2500

Application : TRUCK
Number of Cylinders 4
Cylinder dia. 88.9 MM
Swept Volume 2522 ccm

Piston kit-Set

OEM NO. 0559-99-111/0559-23-200

Piston	SIZE
Comp : 60.4 Height : Length : 115.6 Top Shape : Pin : 31.75 Length : 75.0	STD

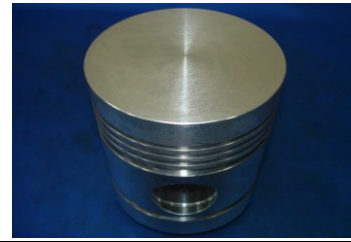

Piston Ring

OEM NO. 0559-23-206
NPR : SCT20-016ZZ

OEM Ring Groove	SIZE
Top : 2.38 2nd : 2.38 3rd : 2.38 Oil : 4.76/4.76	STD



Cylinder Liner

OEM NO. 0636-10-311

Liner&Sleeve	SIZE
In Diameter : 88.9 Out Diameter : 96.9 Total length : 191.0 Flange : 101.0*3.8+0.8	STD



Engine Bearing

MAIN : 0527-23-110
CON.ROD : 0527-23-105
T/W : 0636-23-115
C/B :
BUSH : 0636-11-213

SIZE
STD



Engine Valve

OEM NO. 0636-12-111
IN 40.5 8.0 114.5
OEM NO. 0636-12-121
EX 35.5 8.0 114.5

SIZE
STD

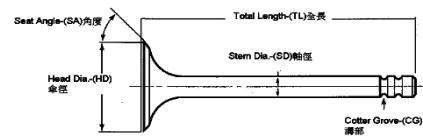

Valve Seat

OEM NO.
IN
OEM NO.
EX

SIZE
STD

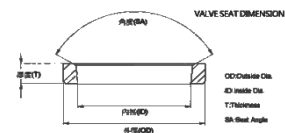

Valve Guide

OEM NO. 0636-10-104B
IN/EX 53.9 8.0 12.7

SIZE
STD

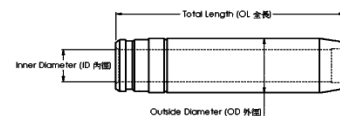

Gasket Set

OEM NO.



MAZDA E2700 XB

Application : TRUCK
Number of Cylinders 4
Cylinder dia. 92.0 MM
Swept Volume 2701 ccm

Piston kit-Set

OEM NO. 0528-23-200



Piston

SIZE

Comp : 60.2 Height : Length : 115.7
Top Shape : Flower
Pin : 31.75
Length : 75.0

STD

Piston Ring

OEM NO. 0527-23-206
NPR : SCT20-022ZZ



OEM Ring Groove

SIZE

Top : 2.38
2nd : 2.38
3rd : 2.38
Oil : 4.76/4.76

STD

Cylinder Liner

OEM NO. 0528-10-311



Liner&Sleeve

SIZE

In Diameter : 92.0
Out Diameter : 96.9
Total length : 191.0
Flange : 101.0*3.8+0.8

STD

Engine Bearing

MAIN : 0527-23-110
CON.ROD : 0527-23-105
T/W : 0636-23-115
C/B :
BUSH : 0636-11-213



SIZE

STD

Engine Valve

OEM NO. 0636-12-111
IN 40.5 8.0 114.5
OEM NO. 0636-12-121
EX 35.5 8.0 114.5

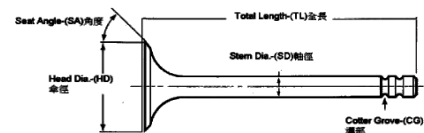

SIZE

STD

Valve Seat

OEM NO.
IN
OEM NO.
EX

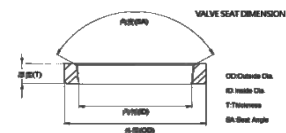

SIZE

STD

Valve Guide

OEM NO. 0636-10-104B
IN/EX 53.9 8.0 12.7

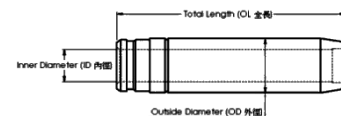

SIZE

STD

Gasket Set

OEM NO.



MAZDA E3000(HA)

Application : TRUCK
 Number of Cylinders 4
 Cylinder dia. 95.0 MM
 Swept Volume 2977 ccm

Piston kit-Set

OEM NO. 1363-23-200

Piston	SIZE
Comp : 58.3 Height : Length : 115.3 Top Shape : Pin : 31.75 Length : 75.0	STD

Piston Ring

OEM NO. 1363-23-206
 NPR : SDT20-028ZX

OEM Ring Groove	SIZE
Top : 2.38 2nd : 2.38 Oil : 4.76	STD



Cylinder Liner

OEM NO. 1363-23-051

Liner&Sleeve	SIZE
In Diameter : 95.0 Out Diameter : 98.5 Total length : 189.0 Flange : 103.5*3.8+0.8	STD



Engine Bearing

MAIN : 1363-23-110
 CON.ROD : 1363-23-105
 T/W : SL01-23-115
 C/B :
 BUSH : 0636-11-213

SIZE
 STD



Engine Valve

OEM NO. 0636-12-111
 IN 40.5 8.0 114.5
 OEM NO. 0636-12-121
 EX 35.5 8.0 114.5

SIZE
 STD

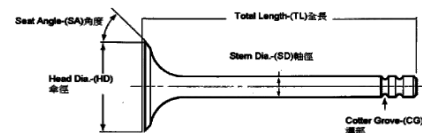

Valve Seat

OEM NO.
 IN 47.3 39.0 6.5
 OEM NO. A18V1C173X
 EX 40.0 32.0 7.0

SIZE
 STD

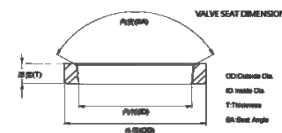

Valve Guide

OEM NO. 0636-10-104B
 IN/EX 53.9 8.0 12.7

SIZE
 STD

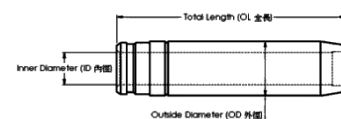

Gasket Set

OEM NO.



Piston kit-Set

OEM NO. K4ZO-11-SAO



Piston

SIZE

Comp : 60.5 w/al-fin Height : -4.8 Length : 103.3
Top Shape : Flower
Pin : 32.0
Length : 75.0

STD

Piston Ring

OEM NO. K4ZO-11-SCO
NPR : SDK30-004ZX



OEM Ring Groove

SIZE

Top : 2.85K
2nd : 2.4
Oil : 4.0

STD

Cylinder Liner

OEM NO.



Liner&Sleeve

SIZE

In Diameter :
Out Diameter :
Total length :
Flange :

STD

Engine Bearing

MAIN :
CON.ROD :
T/W :
C/B :
BUSH :



SIZE

STD

Engine Valve

OEM NO.
IN
OEM NO.
EX

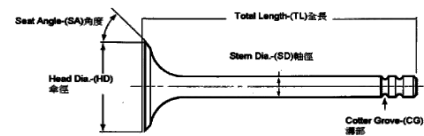

SIZE

STD

Valve Seat

OEM NO.
IN
OEM NO.
EX

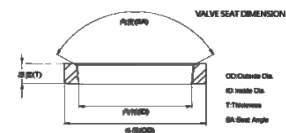

SIZE

STD

Valve Guide

OEM NO.
IN
OEM NO.
EX

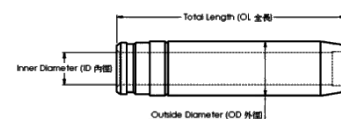

SIZE

STD

Gasket Set

OEM NO.



Piston kit-Set

OEM NO. OK4YO-11-SAO



Piston

SIZE

Comp : 57.8 w/al-fin Height : -18.5 Length : 105.0
Top Shape : Ø55.0
Direct Injection
Pin : 34.0 Length : 82.0

STD

Piston Ring

OEM NO. SL50-11-SCO
NPR : SDT20-046ZX



OEM Ring Groove

SIZE

Top : 2.5
2nd : 2.0
Oil : 4.5

STD

Cylinder Liner

OEM NO.



Liner&Sleeve

SIZE

In Diameter :
Out Diameter :
Total length :
Flange :

STD

Engine Bearing

MAIN :
CON.ROD :
T/W :
C/B :
BUSH :



SIZE

STD

Engine Valve

OEM NO.
IN
OEM NO.
EX

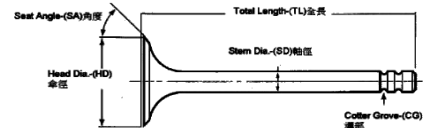

SIZE

STD

Valve Seat

OEM NO.
IN
OEM NO.
EX

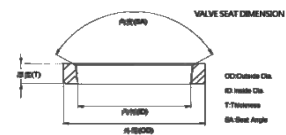

SIZE

STD

Valve Guide

OEM NO.
IN
OEM NO.
EX

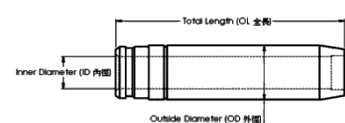

SIZE

STD

Gasket Set

OEM NO.



Piston kit-Set

OEM NO. K4Y1-11-SAO

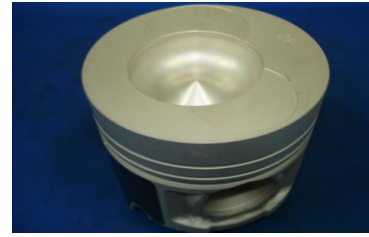

Piston

SIZE

Comp : 56.5 Height : -19.3 oil-cooled Length : 102.0 MOS2
Top Shape : Ø53.0
Direct Injection
Pin : 34.0 Length : 82.0

STD

Piston Ring

OEM NO. K4Y1-11-SCO
NPR : SDK30-003ZZ



OEM Ring Groove

SIZE

Top : 2.0
2nd : 2.0
Oil : 3.0

STD

Cylinder Liner

OEM NO.



Liner&Sleeve

SIZE

In Diameter :
Out Diameter :
Total length :
Flange :

STD

Engine Bearing

MAIN :
CON.ROD :
T/W :
C/B :
BUSH :



SIZE

STD

Engine Valve

OEM NO.
IN
OEM NO.
EX

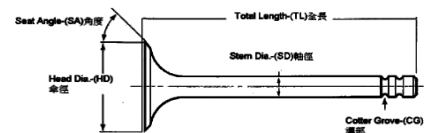

SIZE

STD

Valve Seat

OEM NO.
IN
OEM NO.
EX

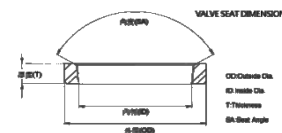

SIZE

STD

Valve Guide

OEM NO.
IN
OEM NO.
EX

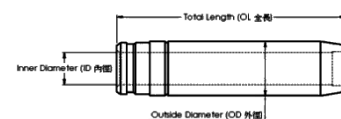

SIZE

STD

Gasket Set

OEM NO.



Piston kit-Set

OEM NO. K4YO-11-SAO

Piston	SIZE
Comp : 56.2 Height : -20.0 oil-cooled Length : 102.1 MOS2 Top Shape : Ø51.0 Direct Injection Pin : 34.0 Length : 82.0	STD

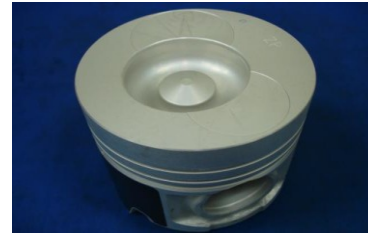

Piston Ring

OEM NO. K4Y1-11-SCO
NPR : SDK30-003ZZ

OEM Ring Groove	SIZE
Top : 2.0 2nd : 2.0 Oil : 3.0	STD



Cylinder Liner

OEM NO.

Liner&Sleeve	SIZE
In Diameter : Out Diameter : Total length : Flange :	STD



Engine Bearing

MAIN :	SIZE
CON.ROD :	STD
T/W :	
C/B :	
BUSH :	



Engine Valve

OEM NO. IN	SIZE
OEM NO. EX	STD

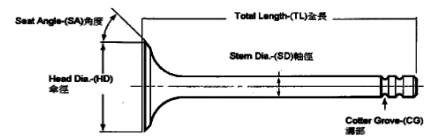

Valve Seat

OEM NO. IN	SIZE
OEM NO. EX	STD

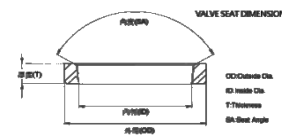

Valve Guide

OEM NO. IN	SIZE
OEM NO. EX	STD

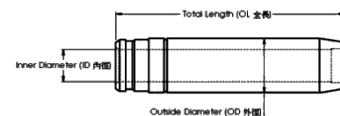

Gasket Set

OEM NO.



MAZDA

R2

Application : TRUCK
Number of Cylinders 4
Cylinder dia. 86.0 MM
Swept Volume 2184 ccm

Piston kit-Set

OEM NO. R2YO-11-SAO

Piston	SIZE
Comp : 47.3 w/al-fin Height : -1.6 oil-cooled Length : 86.3 Top Shape : Flower Pin : 25.0 Length : 68.0	STD



Piston Ring

OEM NO. R2B6-SCO
 NPR : SDT20-059ZY

OEM Ring Groove	SIZE
Top : 2.0 2nd : 2.0 Oil : 3.0	STD



Cylinder Liner

OEM NO. R2B6-10-313

Liner&Sleeve	SIZE
In Diameter : 86.0 Sleeve : 86.0*89.0*165L Out Diameter : 89.0 Total length : 163.0 Flange : 94.0*2.85	STD



Engine Bearing

MAIN : RF01-23-135A
 CON.ROD : RF01-23-105
 T/W : RF01-23-115
 C/B :
 BUSH : RF01-11-213

SIZE
 STD



Engine Valve

OEM NO. RF01-12-111
 IN 41.0 8.0 107.0
 OEM NO. RF01-12-121
 EX 36.0 8.0 107.0

SIZE
 STD

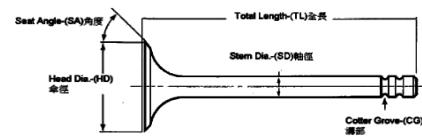

Valve Seat

OEM NO. 0248-00024
 IN 42.0 35.0 6.8
 OEM NO. 0248-0025
 EX 37.0 30.0 6.8

SIZE
 STD

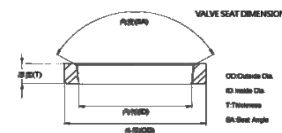

Valve Guide

OEM NO. RF01-10-280
 IN 40.6 14.0 8.0
 OEM NO. RF01-10-290
 EX 37.7 14.0 8.0

SIZE
 STD

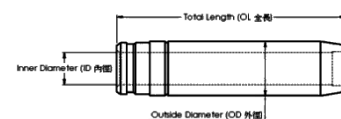

Gasket Set

OEM NO.



MAZDA R2

Application : TRUCK
Number of Cylinders 4
Cylinder dia. 86.0 MM
Swept Volume 2184 ccm

Piston kit-Set

OEM NO. RF01-23-200



Piston

SIZE

Comp : 47.3 w/al-fin Height : -2.0 Length : 86.3
Top Shape : Flower
Pin : 25.0
Length : 68.0

STD

Piston Ring

OEM NO. R201-23-130B
NPR : SDT20-041ZX



OEM Ring Groove

SIZE

Top : 2.0
2nd : 2.0
Oil : 4.0

STD

Cylinder Liner

OEM NO. R2B6-10-313



Liner&Sleeve

SIZE

In Diameter : 86.0 Sleeve : 86.0*89.0*165L
Out Diameter : 89.0
Total length : 163.0
Flange : 94.0*2.85

STD

Engine Bearing

MAIN : RF01-23-135A
CON.ROD : RF01-23-105
T/W : RF01-23-115
C/B :
BUSH : RF01-11-213

SIZE



STD

Engine Valve

OEM NO. RF01-12-111
IN 41.0 8.0 107.0
OEM NO. RF01-12-121
EX 36.0 8.0 107.0

SIZE

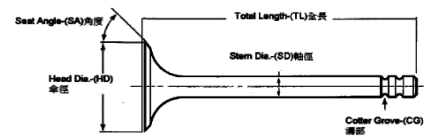

STD

Valve Seat

OEM NO. 0248-00024
IN 42.0 35.0 6.8
OEM NO. 0248-0025
EX 37.0 30.0 6.8

SIZE

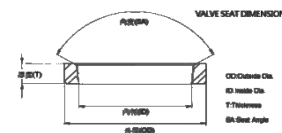

STD

Valve Guide

OEM NO. RF01-10-280
IN 40.6 14.0 8.0
OEM NO. RF01-10-290
EX 37.7 14.0 8.0

SIZE

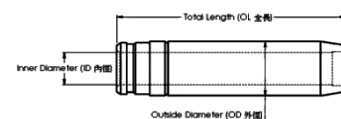

STD

Gasket Set

OEM NO.



MAZDA

R2

Application : TRUCK
Number of Cylinders 4
Cylinder dia. 86.0 MM
Swept Volume 2184 ccm

Piston kit-Set

OEM NO. RFYO-11-SAO

Piston	SIZE
Comp : 47.4 w/al-fin Height : -1.2 Length : 86.3 Top Shape : Flower Pin : 30.0 Length :	STD



Piston Ring

OEM NO. R201-23-130B
 NPR : SDT20-041ZX

OEM Ring Groove	SIZE
Top : 2.0 2nd : 2.0 Oil : 4.0	STD



Cylinder Liner

OEM NO. R2B6-10-313

Liner&Sleeve	SIZE
In Diameter : 86.0 Sleeve : 86.0*89.0*165L Out Diameter : 89.0 Total length : 163.0 Flange : 94.0*2.85	STD



Engine Bearing

MAIN : RF01-23-135A
 CON.ROD : RF01-23-105
 T/W : RF01-23-115
 C/B :
 BUSH : RF01-11-213

SIZE
 STD



Engine Valve

OEM NO. RF01-12-111
 IN 41.0 8.0 107.0
 OEM NO. RF01-12-121
 EX 36.0 8.0 107.0

SIZE
 STD

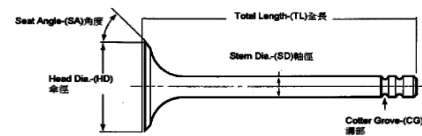

Valve Seat

OEM NO. 0248-00024
 IN 42.0 35.0 6.8
 OEM NO. 0248-0025
 EX 37.0 30.0 6.8

SIZE
 STD

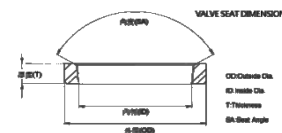

Valve Guide

OEM NO. RF01-10-280
 IN 40.6 14.0 8.0
 OEM NO. RF01-10-290
 EX 37.7 14.0 8.0

SIZE
 STD

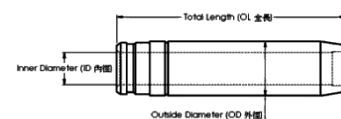

Gasket Set

OEM NO.



MAZDA R2(RF)

Application : TRUCK
Number of Cylinders 4
Cylinder dia. 86.0 MM
Swept Volume 2184 ccm

Piston kit-Set

OEM NO. R2Y3-11-SA0B



Piston

SIZE

Comp : 43.2 w/al-fin Height : -1.3 oil-cooled Length : 82.2
Top Shape : Flower
Pin : 25.0
Length : 68.0

STD

Piston Ring

OEM NO. R2B6-11SCO
NPR : SDT20-059ZY



OEM Ring Groove

SIZE

Top : 2.0
2nd : 2.0
Oil : 3.0

STD

Cylinder Liner

OEM NO. R2B6-10-313



Liner&Sleeve

SIZE

In Diameter : 86.0
Out Diameter : 89.0
Total length : 165.0
Flange :

STD

Engine Bearing

MAIN : RF01-23-135A
CON.ROD : RF01-23-105
T/W : RF01-23-115
C/B :
BUSH : RF01-11-213



SIZE

STD

Engine Valve

OEM NO. RF71-12-111
IN 39.4 8.0 106.8
OEM NO. RF71-12-121
EX 35.1 8.0 106.8

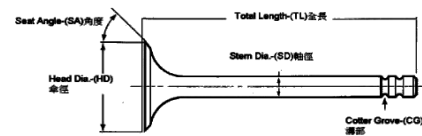

SIZE

STD

Valve Seat

OEM NO. 0248-00024
IN 42.0 35.0 6.8
OEM NO. 0248-0025
EX 37.0 30.0 6.8

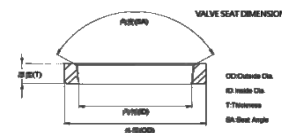

SIZE

STD

Valve Guide

OEM NO. RF01-10-280
IN 40.6 8.0 12.0
OEM NO. RF01-10-290
EX 37.7 8.0 12.0

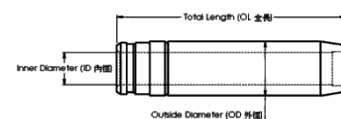

SIZE

STD

Gasket Set

OEM NO.



MAZDA R2(RF)

Application : TRUCK
Number of Cylinders 4
Cylinder dia. 86.0 MM
Swept Volume 2184 ccm

Piston kit-Set

OEM NO. R2Y4-11-SAOA

Piston	SIZE
Comp : 47.2 w/al-fin Height : -1.3 oil-cooled Length : 86.2 Top Shape : Flower Pin : 30.0 Length : 68.0	STD



Piston Ring

OEM NO. R2Y0-11-SCO
NPR : SDT20-068ZZ

OEM Ring Groove	SIZE
Top : 2.0K 2nd : 2.0 Oil : 3.0	STD



Cylinder Liner

OEM NO. R2B6-10-313

Liner&Sleeve	SIZE
In Diameter : 86.0 Out Diameter : 89.0 Total length : 165.0 Flange :	STD



Engine Bearing

MAIN : RF01-23-135A
CON.ROD : RF01-23-105
T/W : RF01-23-115
C/B :
BUSH : RF01-11-213

SIZE
STD



Engine Valve

OEM NO. RF71-12-111
IN 39.4 8.0 107.0
OEM NO. RF71-12-121
EX 35.1 8.0 107.0

SIZE
STD

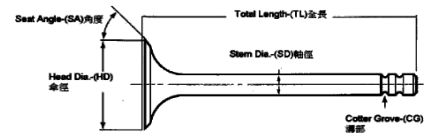

Valve Seat

OEM NO. 0248-00024
IN 42.0 35.0 6.8
OEM NO. 0248-0025
EX 37.0 30.0 6.8

SIZE
STD

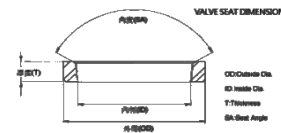

Valve Guide

OEM NO. RF01-10-280
IN 40.6 8.0 14.0
OEM NO. RF01-10-290
EX 37.7 8.0 14.0

SIZE
STD

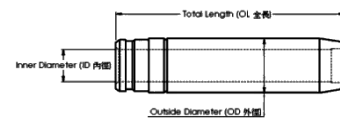

Gasket Set

OEM NO.



MAZDA RFY7

Application : TRUCK
Number of Cylinders 4
Cylinder dia. 86.0 MM
Swept Volume 2184 ccm

Piston kit-Set

OEM NO. RFY7-11-SAO

Piston	SIZE
Comp : w/al-fin Height : oil-cooled Length : Top Shape : Flower Pin : 30.0 Length : 68.0	STD

Piston Ring

OEM NO.
NPR :

OEM Ring Groove	SIZE
Top : 2nd : Oil :	STD



Cylinder Liner

OEM NO.

Liner&Sleeve	SIZE
In Diameter : Out Diameter : Total length : Flange :	STD



Engine Bearing

MAIN : CON.ROD : T/W : C/B : BUSH :	SIZE
	STD



Engine Valve

OEM NO. IN OEM NO. EX	SIZE
	STD

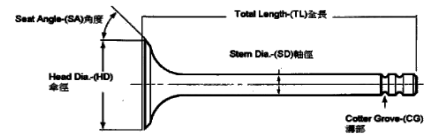

Valve Seat

OEM NO. IN OEM NO. EX	SIZE
	STD

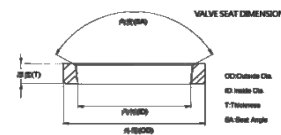

Valve Guide

OEM NO. IN OEM NO. EX	SIZE
	STD

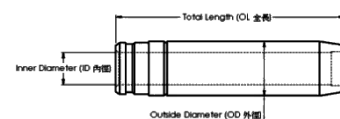

Gasket Set

OEM NO.



MAZDA RFY8

Application : TRUCK
Number of Cylinders 4
Cylinder dia. 86.0 MM
Swept Volume 2184 ccm

Piston kit-Set

OEM NO. RFY8-11-SAO

Piston	SIZE
Comp : w/al-fin Height : oil-cooled Length : Top Shape : Flower Pin : 30.0 Length : 68.0	STD

Piston Ring

OEM NO. NPR :	
OEM Ring Groove	SIZE
Top : 2nd : Oil :	STD



Cylinder Liner

OEM NO.	
Liner&Sleeve	SIZE
In Diameter : Out Diameter : Total length : Flange :	STD



Engine Bearing

MAIN :	SIZE
CON.ROD :	
T/W :	STD
C/B :	
BUSH :	



Engine Valve

OEM NO. IN	SIZE
OEM NO. EX	STD

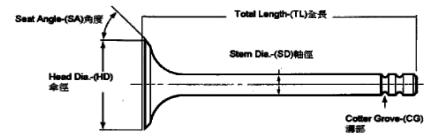

Valve Seat

OEM NO. IN	SIZE
OEM NO. EX	STD

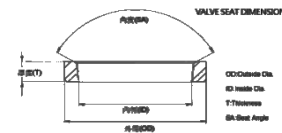

Valve Guide

OEM NO. IN	SIZE
OEM NO. EX	STD

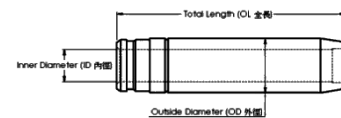

Gasket Set

OEM NO.	
---------	--



MAZDA RFY7

Application : TRUCK
Number of Cylinders 4
Cylinder dia. 86.0 MM
Swept Volume 2184 ccm

Piston kit-Set

OEM NO. RFY7-11-SAO

Piston	SIZE
Comp : 46.9 w/al-fin Height : -13.7 oil-cooled Length : 75.9 MOS2 Top Shape : Ø46.6 Direct Injection Pin : 30.0 Length : 68.0	STD



Piston Ring

OEM NO. R2B6-11-SCO
NPR : SDT20-059Y

OEM Ring Groove	SIZE
Top : 2.0 2nd : 2.0 Oil : 3.0	STD



Cylinder Liner

OEM NO.

Liner&Sleeve	SIZE
In Diameter : Out Diameter : Total length : Flange :	STD



Engine Bearing

MAIN : CON.ROD : T/W : C/B : BUSH :	SIZE
	STD



Engine Valve

OEM NO. IN OEM NO. EX	SIZE
	STD

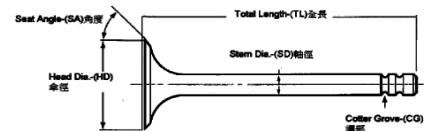

Valve Seat

OEM NO. IN OEM NO. EX	SIZE
	STD

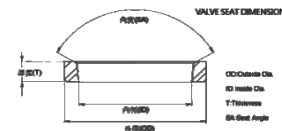

Valve Guide

OEM NO. IN OEM NO. EX	SIZE
	STD

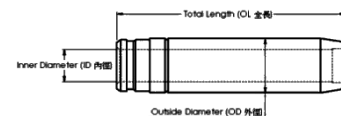

Gasket Set

OEM NO.



MAZDA RFY8

Application : TRUCK
Number of Cylinders 4
Cylinder dia. 86.0 MM
Swept Volume 2184 ccm

Piston kit-Set

OEM NO. RFY8-11-SAO

Piston	SIZE
Comp : 46.9 w/al-fin Height : -15.5 oil-cooled Length : 75.8 MOS2 Top Shape : Ø43.3 Direct Injection Pin : 30.0 Length : 68.0	STD



Piston Ring

OEM NO. R2B6-11-SCO
NPR : SDT20-059Y

OEM Ring Groove	SIZE
Top : 2.0 2nd : 2.0 Oil : 3.0	STD



Cylinder Liner

OEM NO.

Liner&Sleeve	SIZE
In Diameter : Out Diameter : Total length : Flange :	STD



Engine Bearing

MAIN :	SIZE
CON.ROD :	STD
T/W :	
C/B :	
BUSH :	



Engine Valve

OEM NO. IN	SIZE
OEM NO. EX	STD

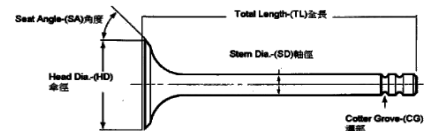

Valve Seat

OEM NO. IN	SIZE
OEM NO. EX	STD

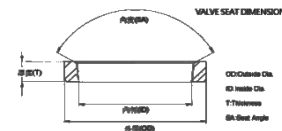

Valve Guide

OEM NO. IN	SIZE
OEM NO. EX	STD

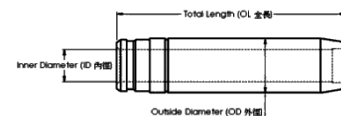

Gasket Set

OEM NO.



MAZDA XA T2500(S5)

Application : TRUCK
Number of Cylinders 4
Cylinder dia. 88.9 MM
Swept Volume 2522 ccm

Piston kit-Set

OEM NO. S501-23-200/S501-99-111



Piston

SIZE

Comp : 60.4 w/al-fin Height : -2.5 Length : 103.4
Top Shape : Flower
Pin : 28.0
Length : 73.5

STD

Piston Ring

OEM NO. 1456-23-206
NPR : SDT20-032ZX



OEM Ring Groove

SIZE

Top : 2.38
2nd : 2.38
Oil : 4.76

STD

Cylinder Liner

OEM NO. 0636-10-311



Liner&Sleeve

SIZE

In Diameter : 88.9
Out Diameter : 96.9
Total length : 191.0
Flange : 101.0*3.8*0.8

STD

Engine Bearing

MAIN : 0527-23-110
CON.ROD : 0527-23-105
T/W : 0636-23-115
C/B :
BUSH : S501-11-213



SIZE

STD

Engine Valve

OEM NO. S501-12-111
IN 40.5 9.0 115.0
OEM NO. S501-12-121
EX 36.0 9.0 115.0

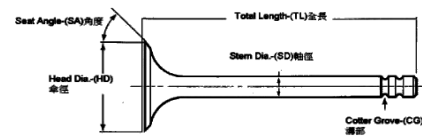

SIZE

STD

Valve Seat

OEM NO.
IN
OEM NO.
EX

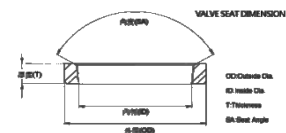

SIZE

STD

Valve Guide

OEM NO.
IN
OEM NO.
EX

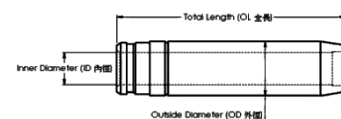

SIZE

STD

Gasket Set

OEM NO.



MAZDA T3000(HA)

Application : TRUCK
Number of Cylinders 4
Cylinder dia. 95.0 MM
Swept Volume 2977 ccm

Piston kit-Set

OEM NO. SE01-23-200A



Piston

SIZE

Comp : 54.2 w/al-fin Height : -2.1 Length : 100.6
Top Shape : Flower
Pin : 31.75
Length : 75.0

STD

Piston Ring

OEM NO. 1363-23-206
NPR : SDT20-028ZX



OEM Ring Groove

SIZE

Top : 2.38
2nd : 2.38
Oil : 4.76

STD

Cylinder Liner

OEM NO. 1363-23-051



Liner&Sleeve

SIZE

In Diameter : 95.0
Out Diameter : 98.5
Total length : 189.0
Flange : 103.5*3.8+0.8

STD

Engine Bearing

MAIN : SE01-23-110
CON.ROD : SE45-11-SE0
T/W : SL01-23-115
C/B :
BUSH : SE01-11-213



SIZE

STD

Engine Valve

OEM NO. SE01-12-111
IN 45.9 9.0 114.5
OEM NO. SE01-12-121
EX 38.0 9.0 114.5

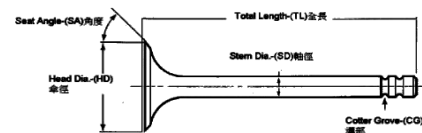

SIZE

STD

Valve Seat

OEM NO. SE01-12-112
IN 47.3 39.0 6.5
OEM NO. SE01-12-116
EX 40.0 32.0 7.0

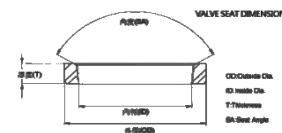

SIZE

STD

Valve Guide

OEM NO. SE01-10-104
IN/EX 54.0 9.0 14.0

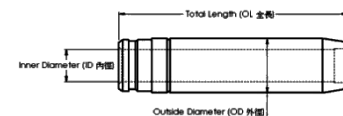

SIZE

STD

Gasket Set

OEM NO.



MAZDA T3000(VS)

Application : TRUCK
Number of Cylinders 4
Cylinder dia. 98.0 MM
Swept Volume ccm

Piston kit-Set

OEM NO. VSY1-11-SAO



Piston

SIZE

Comp : 48.5 w/al-fin Height : -1.7 oil-cooled Length : 90.3
Top Shape : Flower
Pin : 30.0
Length : 79.0

STD

Piston Ring

OEM NO.
NPR :



OEM Ring Groove

SIZE

Top : 2.5
2nd : 2.0
Oil : 3.0

STD

Cylinder Liner

OEM NO. VSY1-10-311A



Liner&Sleeve

SIZE

In Diameter : 98.0
Out Diameter : 101.5
Total length : 168.0
Flange : 107.0*2.5+0.6

STD

Engine Bearing

MAIN :
CON.ROD :
T/W :
C/B :
BUSH :



SIZE

STD

Engine Valve

OEM NO.
IN
OEM NO.
EX

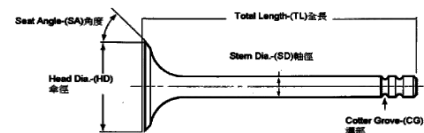

SIZE

STD

Valve Seat

OEM NO.
IN
OEM NO.
EX

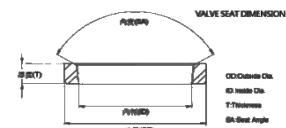

SIZE

STD

Valve Guide

OEM NO.
IN
OEM NO.
EX

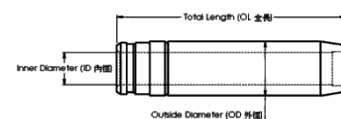

SIZE

STD

Gasket Set

OEM NO.



MAZDA T3500 Korea

Application : TRUCK
Number of Cylinders 4
Cylinder dia. 100.0 MM
Swept Volume 3455 ccm

Piston kit-Set

OEM NO. SLA1-11-SAO

Piston	SIZE
Comp : 58.0 w/al-fin Height : -18.8 oil-cooled Length : 105.0 Top Shape : Ø49.0 Direct Injection/Head Anodized Pin : 34.0 Length : 82.0	STD



Piston Ring

OEM NO. SL07-23-206
NPR : SJT20-046ZZ

OEM Ring Groove	SIZE
Top : 2.5 2nd : 2.0 Oil : 4.5	STD



Cylinder Liner

OEM NO. SL01-23-311

Liner&Sleeve	SIZE
In Diameter : 100.0 Out Diameter : 103.5 Total length : 193.5 Flange : 108.0*2.5+0.8	STD



Engine Bearing

MAIN : SL01-23-110
CON.ROD : SL01-23-105
T/W : SL01-23-115
C/B :
BUSH : SL01-11-213

SIZE
STD



Engine Valve

OEM NO. SE01-12-111
IN 45.5 9.0 114.5
OEM NO. SE01-12-121
EX 38.0 9.0 114.5

SIZE
STD

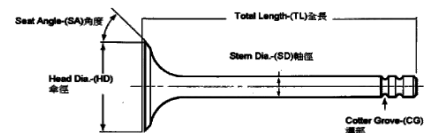

Valve Seat

OEM NO. SE01-12-112
IN 47.3 39.0 6.5
OEM NO. SE01-12-116
EX 40.0 32.0 7.0

SIZE
STD

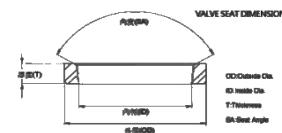

Valve Guide

OEM NO. SE01-10-104
IN/EX 54.0 9.0 14.0

SIZE
STD

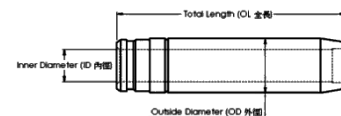

Gasket Set

OEM NO.



MAZDA T3500(SL)

Application : TRUCK
Number of Cylinders 4
Cylinder dia. 100.0 MM
Swept Volume 3455 ccm

Piston kit-Set

OEM NO. SL07-23-200



Piston

SIZE

Comp : 58.0 Height : -21.3 oil-cooled Length : 105.0
Top Shape : Ø35.0
Direct Injection/Head Anodized
Pin : 34.0 Length : 82.0

STD

Piston Ring

OEM NO. SL07-23-206

NPR : SJT20-046ZZ



OEM Ring Groove

SIZE

Top : 2.5
2nd : 2.0
Oil : 4.5

STD

Cylinder Liner

OEM NO. SL01-23-311



Liner&Sleeve

SIZE

In Diameter : 100.0
Out Diameter : 103.5
Total length : 193.5
Flange : 108.0*2.5+0.8

STD

Engine Bearing

MAIN : SL01-23-110
CON.ROD : SL01-23-105
T/W : SL01-23-115
C/B :
BUSH : SL01-11-213

SIZE



STD

Engine Valve

OEM NO. SE01-12-111
IN 45.5 9.0 114.5
OEM NO. SE01-12-121
EX 38.0 9.0 114.5

SIZE

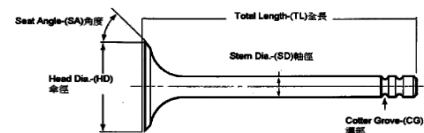

STD

Valve Seat

OEM NO. SE01-12-112
IN 47.3 39.0 6.5
OEM NO. SE01-12-116
EX 40.0 32.0 7.0

SIZE

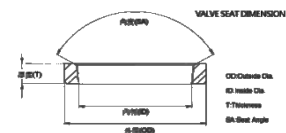

STD

Valve Guide

OEM NO. SE01-10-104
IN/EX 54.0 9.0 14.0

SIZE

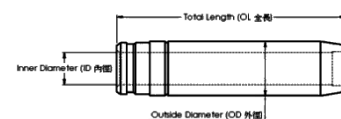

STD

Gasket Set

OEM NO.



MAZDA T3500-T(SLT)

Application : TRUCK
Number of Cylinders 4
Cylinder dia. 100.0 MM
Swept Volume 3455 ccm

Piston kit-Set

OEM NO. SL50-11-SAO

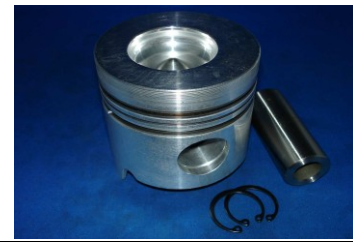

Piston

SIZE

Comp : 58.2 w/al-fin Height : -19.0 oil-cooled Length : 105.0
Top Shape : Ø53.0
Direct Injection
Pin : 34.0 Length : 82.0

STD

Piston Ring

OEM NO. SL07-23-206

NPR : SJT20-046ZZ



OEM Ring Groove

SIZE

Top : 2.5
2nd : 2.0
Oil : 4.5

STD

Cylinder Liner

OEM NO. SL01-23-311

Liner&Sleeve

SIZE

In Diameter : 100.0
Out Diameter : 103.5
Total length : 193.5
Flange : 108.0*2.5+0.8

STD



Engine Bearing

MAIN : SL01-23-110
CON.ROD : SL01-23-105
T/W : SL01-23-115
C/B :
BUSH : SL01-11-213

SIZE

STD



Engine Valve

OEM NO. SE01-12-111
IN 45.5 9.0 114.5
OEM NO. SE01-12-121
EX 38.0 9.0 114.5

SIZE

STD

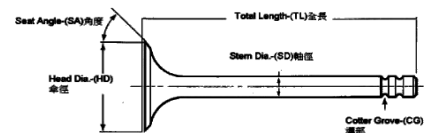

Valve Seat

OEM NO. SE01-12-112
IN 47.3 39.0 6.5
OEM NO. SE01-12-116
EX 40.0 32.0 7.0

SIZE

STD

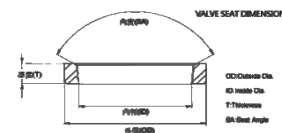

Valve Guide

OEM NO. SE01-10-104
IN/EX 54.0 9.0 14.0

SIZE

STD

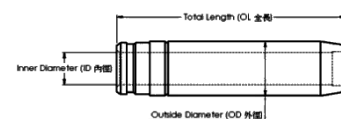

Gasket Set

OEM NO.



MAZDA T3500(SL)

Application : TRUCK
Number of Cylinders 4
Cylinder dia. 100.0 MM
Swept Volume 3455 ccm

Piston kit-Set

OEM NO. SL70-11-SAO

Piston	SIZE
Comp : 58.1 w/al-fin Height : -19.2 oil-cooled Length : 105.0 Top Shape : Ø52.4 Direct Injection Pin : 34.0 Length : 82.0	STD



Piston Ring

OEM NO. SL01-23-206
NPR : SDT20-044ZX

OEM Ring Groove	SIZE
Top : 2.5K 2nd : 2.0 Oil : 4.5	STD



Cylinder Liner

OEM NO. SL01-23-311

Liner&Sleeve	SIZE
In Diameter : 100.0 Out Diameter : 103.5 Total length : 193.5 Flange : 108.0*2.5+0.8	STD



Engine Bearing

MAIN : SL01-23-110
CON.ROD : SL01-23-105
T/W : SL01-23-115
C/B :
BUSH : SL01-11-213

SIZE
STD



Engine Valve

OEM NO. SE01-12-111
IN 45.5 9.0 114.5
OEM NO. SE01-12-121
EX 38.0 9.0 114.5

SIZE
STD

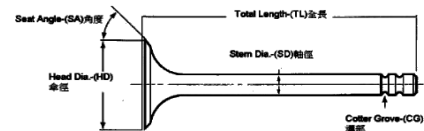

Valve Seat

OEM NO. SE01-12-112
IN 47.3 39.0 6.5
OEM NO. SE01-12-116
EX 40.0 32.0 7.0

SIZE
STD

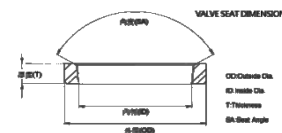

Valve Guide

OEM NO. SE01-10-104
IN/EX 54.0 9.0 14.0

SIZE
STD

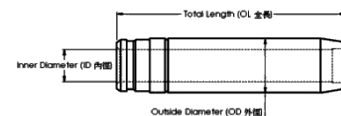

Gasket Set

OEM NO.



MAZDA T4000(TF)

Application : TRUCK
Number of Cylinders 4
Cylinder dia. 105.5 MM
Swept Volume 4021 ccm

Piston kit-Set

OEM NO. TF20-11-SAO



Piston

SIZE

Comp : 61.5 w/al-fin Height : -22.0 oil-cooled Length : 108.3
Top Shape : Ø47.2
Direct Injection
Pin : 35.0 Length : 87.0

STD

Piston Ring

OEM NO. TF01-11-SCO
NPR : SDT20-057ZZ



OEM Ring Groove

SIZE

Top : 2.5K
2nd : 2.0
Oil : 4.5

STD

Cylinder Liner

OEM NO. TEY0-10-311



Liner&Sleeve

SIZE

In Diameter : 105.5
Out Diameter : 109.0
Total length : 200.0
Flange : 114.5*6.0+1.0

STD

Engine Bearing

MAIN : TF01-11-SGO
CON.ROD : TF01-11-SEOA
T/W : TF01-11-SJO
C/B :
BUSH : TF01-11-213



SIZE

STD

Engine Valve

OEM NO. TF20-12-111
IN 47.0 9.0 119.7
OEM NO. TF20-12-121A
EX 41.0 9.0 119.2

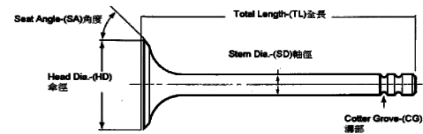

SIZE

STD

Valve Seat

OEM NO. TF01-11-280
IN 48.0 41.9 7.0
OEM NO. TF01-11-290
EX 42.6 34.9 6.0

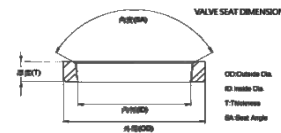

SIZE

STD

Valve Guide

OEM NO. TF01-10-281
IN/EX 47.5 9.0 14.0

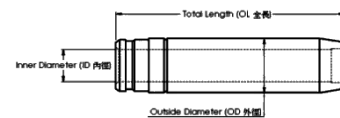

SIZE

STD

Gasket Set

OEM NO.



MAZDA T4100 ZB

Application : TRUCK
Number of Cylinders 6
Cylinder dia. 92.0 MM
Swept Volume 4052 ccm

Piston kit-Set

OEM NO. V101-23-200

Piston	SIZE
Comp : 60.2 Height : Length : 103.3 Top Shape : Pin : 31.75 Length : 75.0	STD



Piston Ring

OEM NO. 0784-23-206
NPR : SCT20-024ZZ

OEM Ring Groove	SIZE
Top : 2.38 2nd : 2.38 3rd : 2.38 Oil : 4.76/4.76	STD



Cylinder Liner

OEM NO. V101-23-051

Liner&Sleeve	SIZE
In Diameter : 92.0 Out Diameter : 96.9 Total length : 191.0 Flange : 101.0*3.8+0.8	STD



Engine Bearing

MAIN : V101-23-110
CON.ROD : V101-23-105
T/W : 0636-23-115
C/B :
BUSH : 0636-11-213

SIZE
STD



Engine Valve

OEM NO. 0636-12-111
IN 40.5 8.0 114.5
OEM NO. 0527-12-121
EX 36.0 8.0 114.5

SIZE
STD

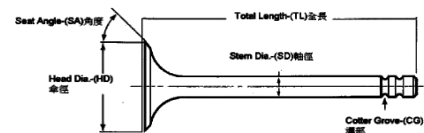

Valve Seat

OEM NO.
IN
OEM NO.
EX

SIZE
STD

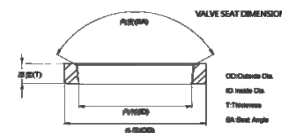

Valve Guide

OEM NO. 0636-10-104B
IN/EX 53.85 8.0 12.7

SIZE
STD

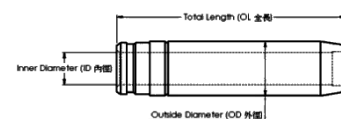

Gasket Set

OEM NO.



MAZDA T4100 ZB

Application : TRUCK
Number of Cylinders 4
Cylinder dia. 109.0 MM
Swept Volume 4553 ccm

Piston kit-Set

OEM NO. TMYO-11-200

Piston	SIZE
Comp : 61.4 w/al-fin Height : oil-cooled Length : 107.4 Top Shape : Ø Direct Injection Pin : 35.0 Length : 79.0	STD

Piston Ring

OEM NO. TMYO-11-SCO
NPR : SDT20-081ZZ

OEM Ring Groove	SIZE
Top : 3.0K 2nd : 2.0 Oil : 3.0	STD



Cylinder Liner

OEM NO. TMYO-10-311

Liner&Sleeve	SIZE
In Diameter : 109.0 Out Diameter : 112.5 Total length : 202.0 Flange : 118.0*6.0+1.0	STD



Engine Bearing

MAIN : TF01-11-SGO
CON.ROD : TF01-11-SEOA
T/W : TF01-11-SJO
C/B :
BUSH : TF01-11-213

SIZE
STD



Engine Valve

OEM NO. TF20-12-111
IN 47.0 9.0 119.7
OEM NO. TF20-12-121
EX 41.0 9.0 119.2

SIZE
STD

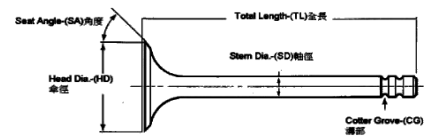

Valve Seat

OEM NO.
IN
OEM NO.
EX

SIZE
STD

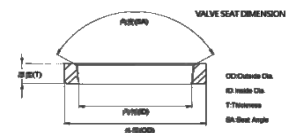

Valve Guide

OEM NO. TF01-10-281A
IN/EX 47.5 14.0 9.0

SIZE
STD

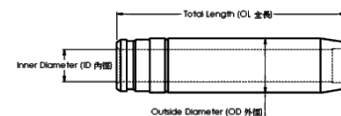

Gasket Set

OEM NO.



MAZDA T4500(TM)

Application : TRUCK
Number of Cylinders 4
Cylinder dia. 109.0 MM
Swept Volume 4553 ccm

Piston kit-Set

OEM NO. TMYO-11-SAO

Piston

SIZE

Comp : 61.3 w/al-fin Height : -21.0 oil-cooled Length : 102.3
 Top Shape : Ø52.9
 Direct Injection
 Pin : 35.0 Length : 79.0

STD



Piston Ring

OEM NO. TMYO-11-SCO

NPR : SDT20-081ZZ

OEM Ring Groove

SIZE

Top : 3.0HK
 2nd : 2.0
 Oil : 3.0

STD



Cylinder Liner

OEM NO. TMYO-10-311

Liner&Sleeve

SIZE

In Diameter : 109.0
 Out Diameter : 112.5
 Total length : 202.0
 Flange : 118.0*6.0+1.0

STD



Engine Bearing

MAIN : TF01-11-SGO
 CON.ROD : TF01-11-SEOA
 T/W : TF01-11-SJO
 C/B :
 BUSH : TF01-11-213

SIZE

STD



Engine Valve

OEM NO. TF20-12-111
 IN 47.0 9.0 119.7
 OEM NO. TF20-12-121
 EX 41.0 9.0 119.2

SIZE

STD

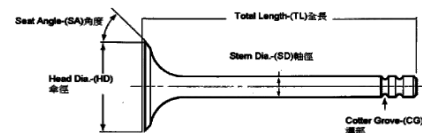

Valve Seat

OEM NO.
 IN
 OEM NO.
 EX

SIZE

STD

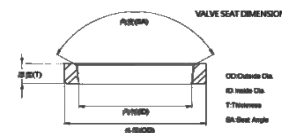

Valve Guide

OEM NO. TF01-10-281A
 IN/EX 47.5 14.0 9.0

SIZE

STD

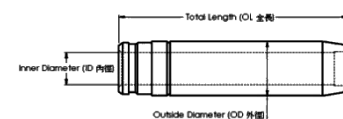

Gasket Set

OEM NO.



MAZDA W9

Application : TRUCK
Number of Cylinders 4
Cylinder dia. 95.0 MM
Swept Volume 2900 ccm

Piston kit-Set

OEM NO. W9Y1-11-SAO

Piston	SIZE
Comp : 47.9 w/al-fin Height : -1.7 oil-cooled Length : 87.4 Top Shape : Flower Pin : 32.0 Length : 70.0	STD



Piston Ring

OEM NO. W9Y1-11-SCO
NPR : SDT20-085ZZ

OEM Ring Groove	SIZE
Top : 2.5 2nd : 2.0 Oil : 3.0	STD



Cylinder Liner

OEM NO.

Liner&Sleeve	SIZE
In Diameter : Out Diameter : Total length : Flange :	STD



Engine Bearing

MAIN : CON.ROD : T/W : C/B : BUSH :	SIZE
	STD



Engine Valve

OEM NO. WL01-12-111 IN 32.5 7.0 111.8 OEM NO. WL01-12-121A EX 35.5 7.0 111.8	SIZE
	STD

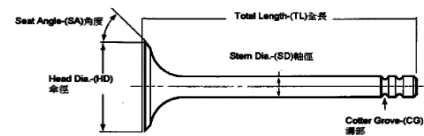

Valve Seat

OEM NO. IN OEM NO. EX	SIZE
	STD

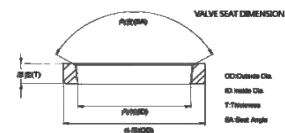

Valve Guide

OEM NO. WLY1-10-280 IN/EX 46.1 12.0 7.0	SIZE
	STD

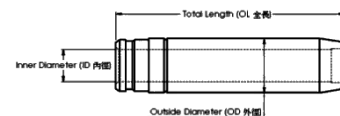

Gasket Set

OEM NO.



MAZDA WL-C

Application : TRUCK
Number of Cylinders 4
Cylinder dia. 93.0 MM
Swept Volume ccm

Piston kit-Set

OEM NO. WLYE-11-SAO

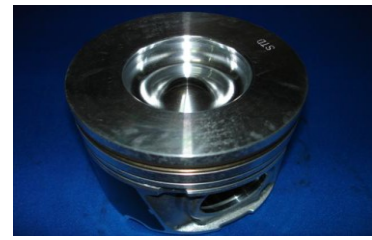

Piston

SIZE

Comp : 51.7 w/al-fin Height : -15.5 oil-cooled
Length : 81.2 MOS2
Top Shape : Ø48.5 Direct Injection
Pin : 34.0 Length : 70.0

STD

Piston Ring

OEM NO.
NPR :



OEM Ring Groove

SIZE

Top : 2.0
2nd : 1.5
Oil : 2.0

STD

Cylinder Liner

OEM NO.



Liner&Sleeve

SIZE

In Diameter :
Out Diameter :
Total length :
Flange :

STD

Engine Bearing

MAIN :
CON.ROD :
T/W :
C/B :
BUSH :



SIZE

STD

Engine Valve

OEM NO.
IN 31.0 6.0 111.8
OEM NO.
EX 28.0 6.0 111.9

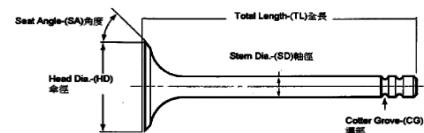

SIZE

STD

Valve Seat

OEM NO.
IN
OEM NO.
EX

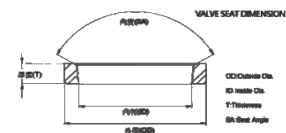

SIZE

STD

Valve Guide

OEM NO. B6Z0-10-290
IN/EX 48.5 11.0 6.0

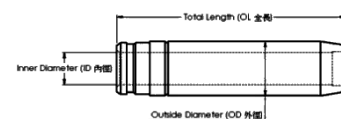

SIZE

STD

Gasket Set

OEM NO.



Piston kit-Set

OEM NO. WLY1-11-SAO



Piston

SIZE

Comp : 47.9 w/al-fin Height : -3.2 oil-cooled Length : 87.3
Top Shape : Flower
Pin : 32.0
Length : 70.0

STD

Piston Ring

OEM NO. WLY1-11-SCO

NPR : SDT20-061ZY

OEM Ring Groove

SIZE

Top : 2.5
2nd : 2.0
Oil : 3.0

STD



Cylinder Liner

OEM NO. WL10-10-311

Liner&Sleeve

SIZE

In Diameter : 93.0
Out Diameter : 96.8
Total length : 166.6
Flange : 101*3.85

STD



Engine Bearing

MAIN : WLY1-11-SG0

CON.ROD : WLY1-11-SE0

T/W : WLY1-11-SJ0

C/B :

BUSH :

SIZE

STD



Engine Valve

OEM NO. WL01-12-111

IN 32.5 7.0 111.8

OEM NO. WL01-12-121

EX 35.5 7.0 111.8

SIZE

STD

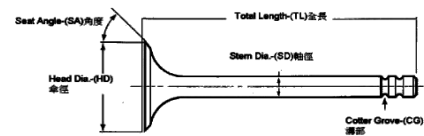

Valve Seat

OEM NO.

IN

OEM NO.

EX

SIZE

STD

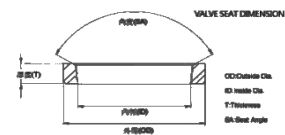

Valve Guide

OEM NO. WLY1-10-280

IN/EX 46.1 12.0 7.0

SIZE

STD

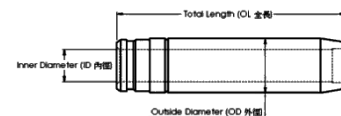

Gasket Set

OEM NO.

